

## Sketch

Case Number: 20250414-1  
 Address: 259 Brown Bear  
 City / State: Chapel Hill / NC  
 Borrower:  
 Lender or Client:  
 Prepared By: Laura Fuelleman

File Number: 202504  
 Zip / County: 27517 /  
 Address:  
 Prepared By A...

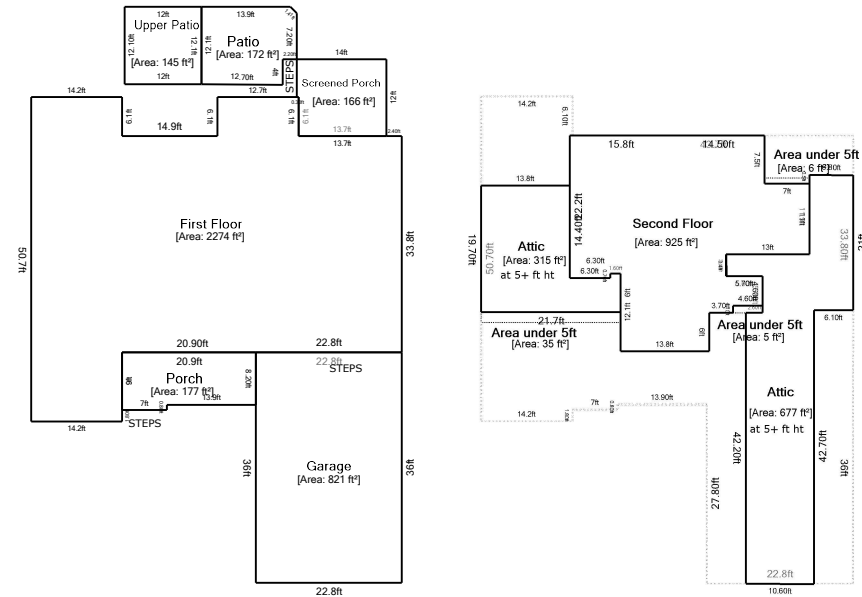

30 ft

Living Area		Nonliving Area	
First Floor	2274.47 ft²	Area Below	0 ft²
Second Floor	925.13 ft²	Attic	676.92 ft²
		Garage	820.80 ft²
		Area under 5ft	6.30 ft²
		Area under 5ft	5.06 ft²
		Attic	314.85 ft²
		Area under 5ft	34.72 ft²
		Screened Porch	166.17 ft²
		Porch	176.98 ft²
		Patio	171.84 ft²
		Upper Patio	145.21 ft²
<b>Total Living Area (rounded):</b>		<b>3200 ft² Total Non-Living Area (rounded):</b>	<b>2519 ft²</b>

This document is designed to be a record of total finished square feet to aid the listing agent in gathering the square feet facts of the property. Measurements are obtained by physical observation of the property by a certified Home Measurement Specialist. Within every measurement project, some degree of art of opinion may be applied as well as rounding as set forth in the standards. Final finished square footage will be rounded to the nearest whole number with the goal of being within a 5% margin of error. Information deemed reliable, but not guaranteed.