

## Building Sketch (Page - 1)

Client	Tom Reick - Reily Jones Media			
Property Address	2949 Legends Dr			
City	Southport	County Brunswick	State NC	Zip Code 28461-8125
Client	Tom Reick - Reily Jones Media			

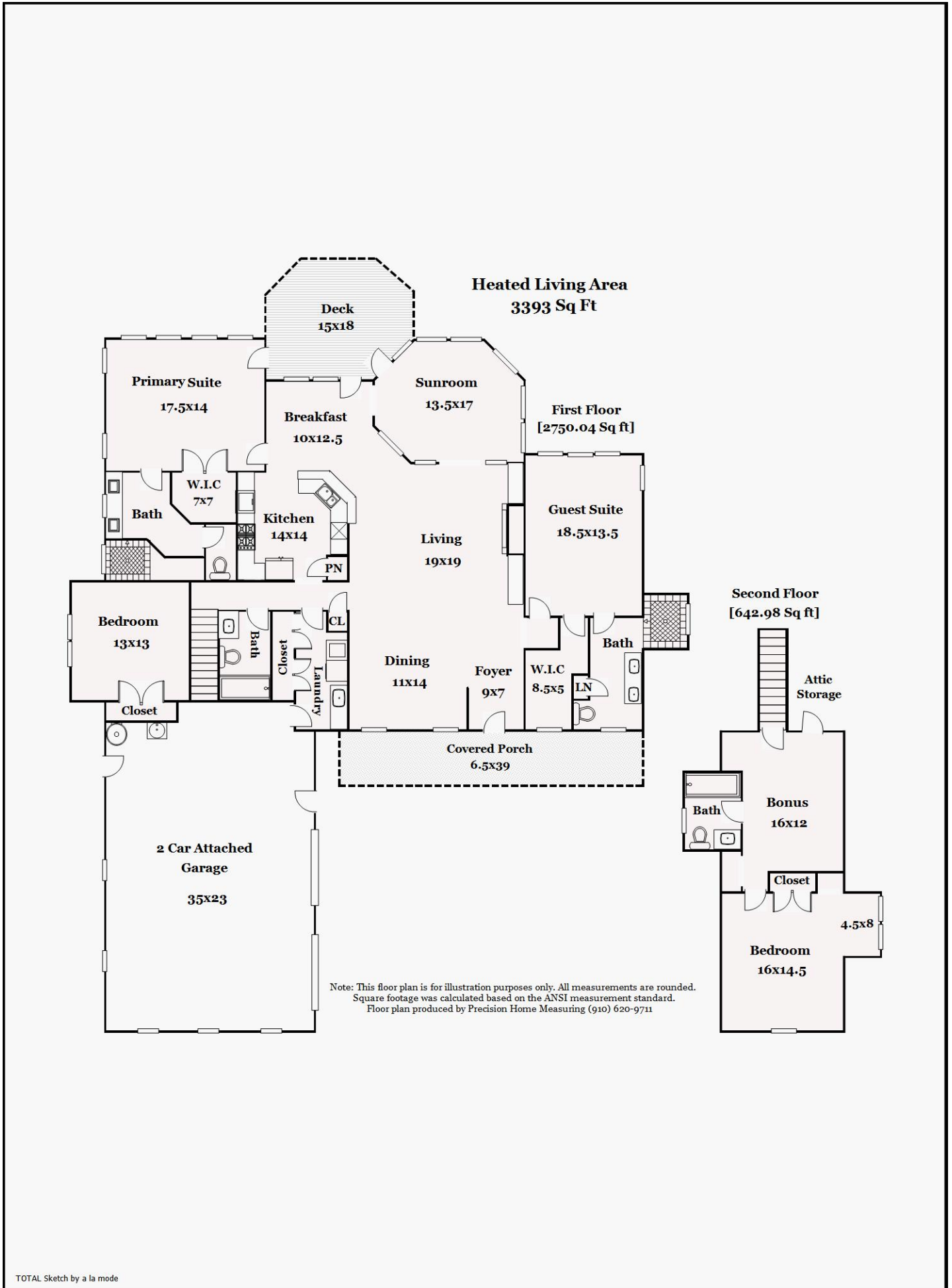

TOTAL Sketch by a la mode

## Building Sketch (Page - 2)

Client	Tom Reick - Reily Jones Media			
Property Address	2949 Legends Dr			
City	Southport	County Brunswick	State NC	Zip Code 28461-8125
Client	Tom Reick - Reily Jones Media			

TOTAL Sketch by a la mode

### Area Calculations Summary

Living Area	Calculation Details		
First Floor	2750 Sq ft		
		$6.6 \times 5.4$	= 35.6
		$0.5 \times 4.8 \times 4.8$	= 11.6
		$0.5 \times 4.8 \times 4.8$	= 11.6
		$8.4 \times 4.8$	= 40.4
		$14.3 \times 4.1$	= 58.6
		$33 \times 14.1$	= 465.3
		$41.8 \times 27.4$	= 1145.3
		$8.6 \times 2.4$	= 20.6
		$22.6 \times 38.3$	= 865.6
		$5 \times 19.1$	= 95.4
Second Floor	643 Sq ft		
		$3.4 \times 12.2$	= 41.5
		$9.4 \times 4.4$	= 41.4
		$35.8 \times 14.7$	= 526.3
		$7.7 \times 4.4$	= 33.9
<b>Total Living Area (Rounded):</b>	<b>3393 Sq ft</b>		
<b>Non-living Area</b>			
2 Car Attached	956 Sq ft		
		$25 \times 35.9$	= 897.5
		$3.5 \times 14$	= 49
		$8.6 \times 1.1$	= 9.5
Deck	227.5 Sq ft		
		$10.2 \times 4.2$	= 42.9
		$0.5 \times 4.2 \times 4.3$	= 9.1
		$14.5 \times 8.7$	= 126.1
		$0.3 \times 3.9$	= 1.2
		$0.5 \times 3.9 \times 4.5$	= 8.8
		$4.8 \times 5.8$	= 27.9
		$0.5 \times 4.8 \times 4.8$	= 11.6
Covered Porch	238.9 Sq ft		
		$6.6 \times 36.2$	= 238.9