

# Building Sketch

Borrower/Client				
Property Address 2227 Woodhurst Lane				
City Albemarle	County	State NC	Zip Code 28001	
Lender				

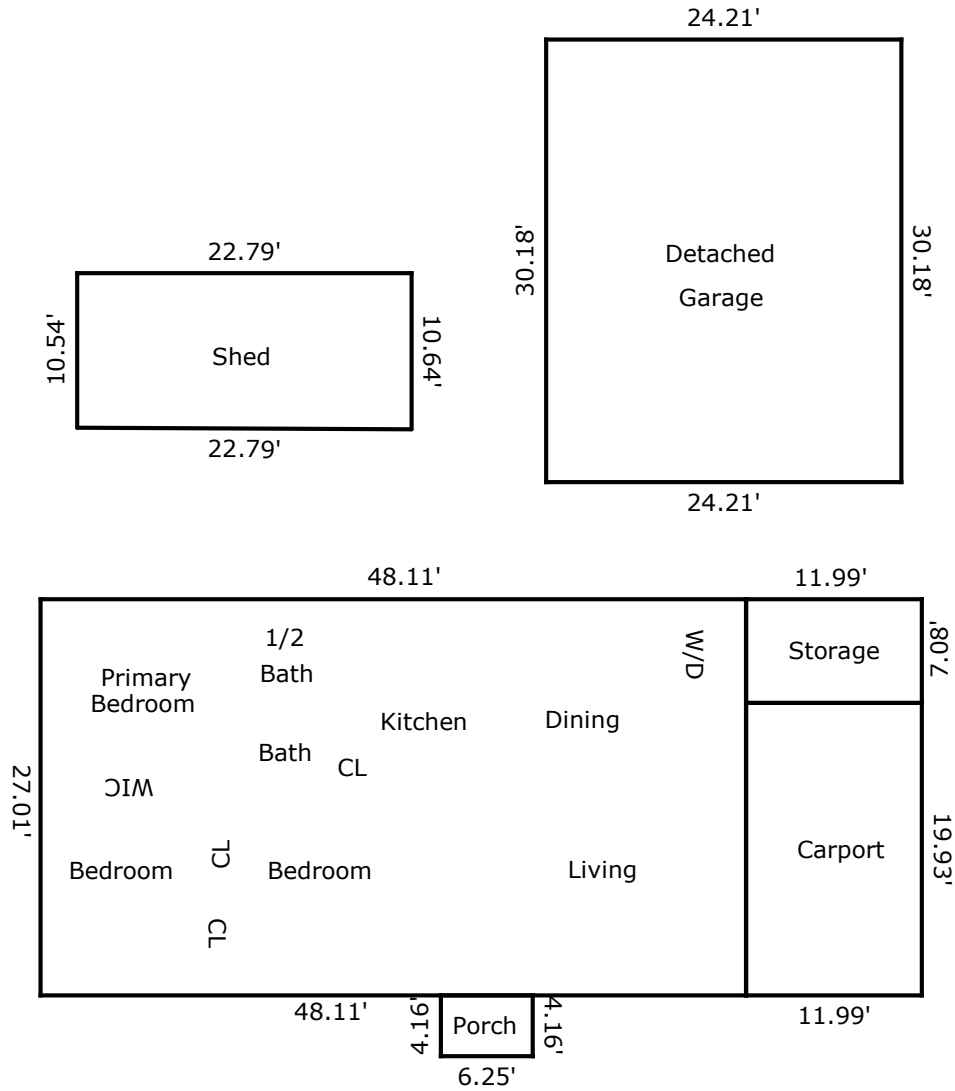

TOTAL Sketch by a la mode

### Area Calculations Summary

<b>Living Area</b>	
Main Level	1299.45 Sq ft
<b>Total Living Area (Rounded):</b>	<b>1299 Sq ft</b>
<b>Non-living Area</b>	
Porch	26 Sq ft
Garage	730.66 Sq ft
Carport	238.96 Sq ft
Storage	84.89 Sq ft
Shed	241.35 Sq ft