

Building Sketch

Borrower/Client				
Property Address 8600 Flowers Court				
City	Charlotte	County	State NC	Zip Code 28215
Lender				

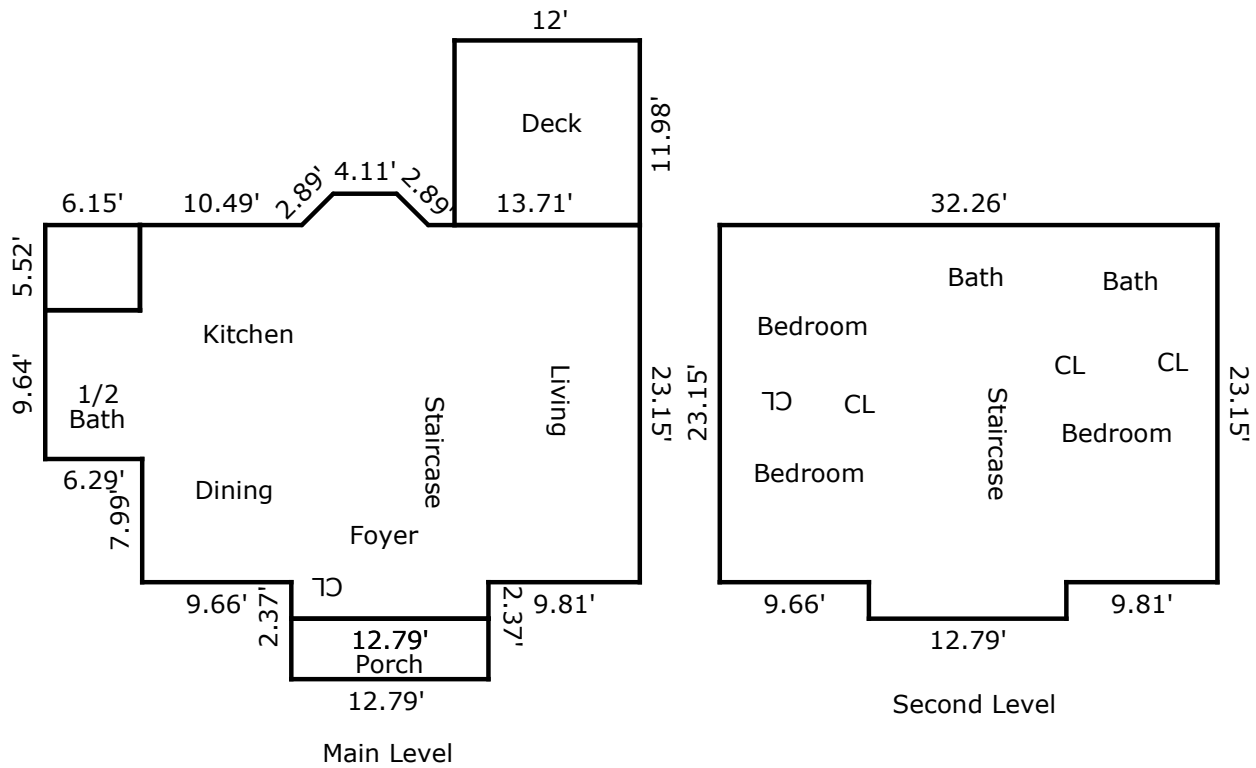

TOTAL Sketch by a la mode

Area Calculations Summary

Living Area	
Main Level	851.17 Sq ft
Second Level	777.13 Sq ft
Total Living Area (Rounded):	1628 Sq ft
Non-living Area	
Porch	50.26 Sq ft
Deck	143.76 Sq ft
Storage	33.95 Sq ft