

Building Sketch

| | | | | |
|-------------------------------------|-------------|--------|----------|----------------|
| Borrower/Client | | | | |
| Property Address 427 Twin Oaks Road | | | | |
| City | Statesville | County | State NC | Zip Code 28625 |
| Lender | | | | |

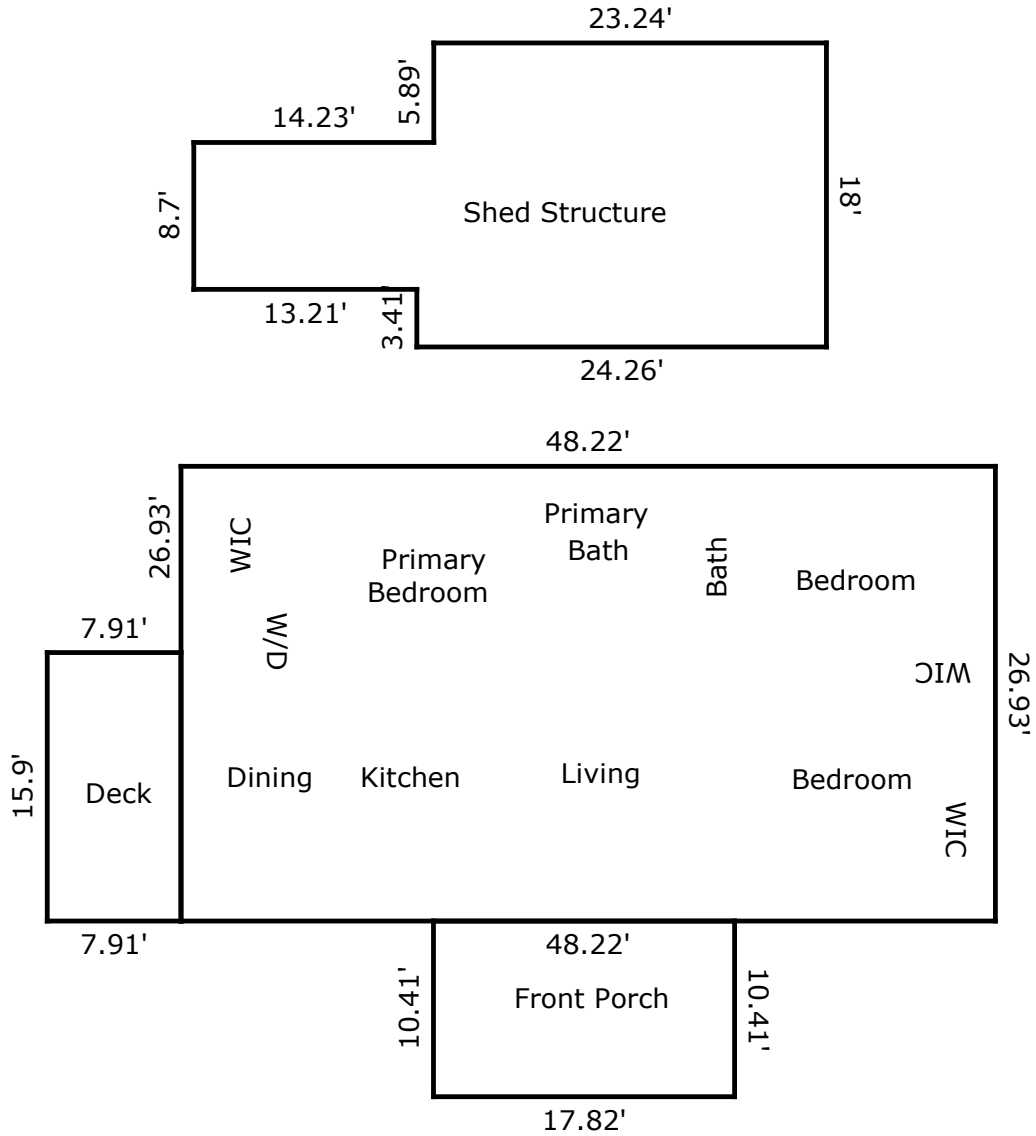

TOTAL Sketch by a la mode

Area Calculations Summary

| Living Area | Calculation Details | |
|-------------------------------------|---------------------|--|
| Main Living Area | 1298.67 Sq ft | $26.93 \times 48.22 = 1298.67$ |
| Total Living Area (Rounded): | 1299 Sq ft | |
| Non-living Area | | |
| Porch | 185.51 Sq ft | $10.41 \times 17.82 = 185.51$ |
| Deck | 125.76 Sq ft | $7.91 \times 15.9 = 125.76$ |
| Shed | 545.6 Sq ft | $18 \times 23.24 = 418.32$ $8.7 \times 13.21 = 114.93$ $12.11 \times 1.02 = 12.35$ |