

Sketch

Case Number: 20240116-1	File Number: 202401
Address: 298 East Salisbury Street	
City / State: Pittsboro / NC	Zip / County: 27312 /
Borrower:	
Lender or Client: Eric Andrews	Address:
Prepared By: Laura Fuelleman	Prepared By A...

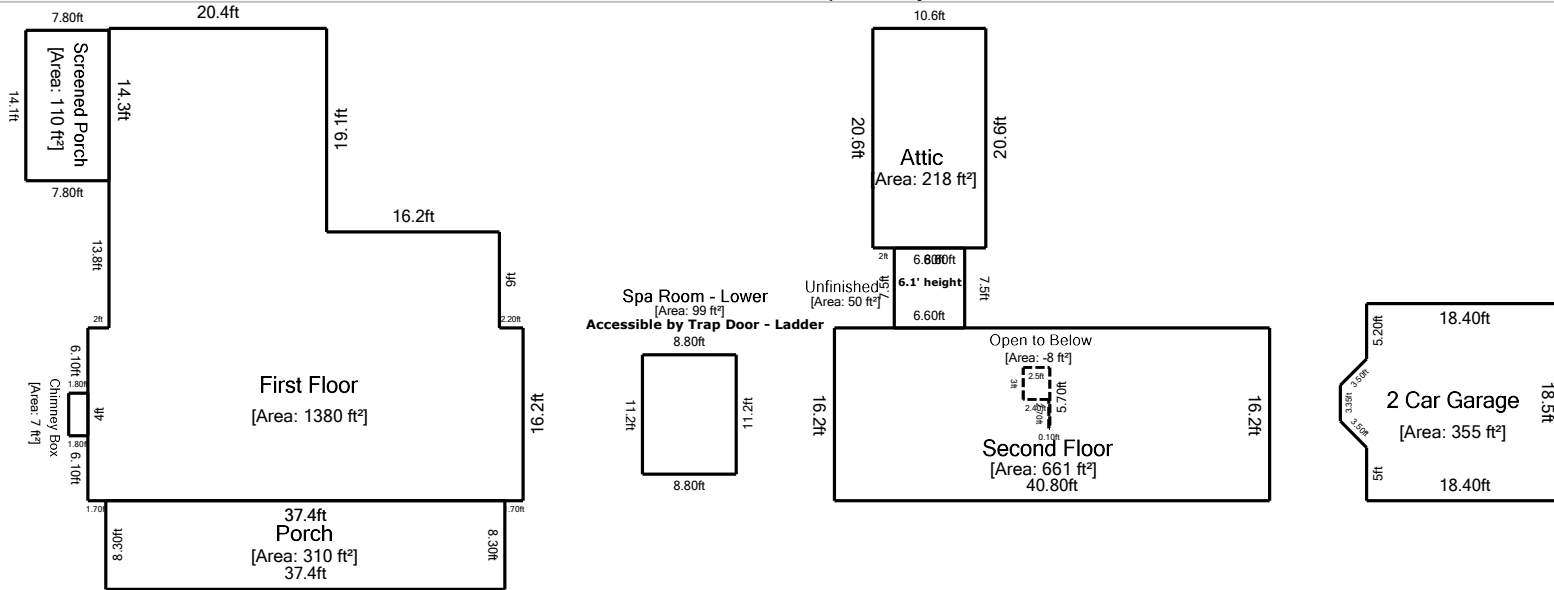

Circa 1899 Home. Heat Source throughout home consists of Natural Gas Heaters: 4 on Main floor, 2 on Second Floor

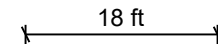

Living Area	Nonliving Area
Second Floor	660.96 ft² Unfinished
Open to Below	-7.77 ft² Attic
First Floor	1380 ft² Screened Porch
	Porch
	Chimney Box
	2 Car Garage
	Spa Room - Lower
Total Living Area (rounded):	2033 ft² Total Non-Living Area (rounded):
	1149 ft²

This document is designed to be a record of total finished square feet to aid the listing agent in gathering the square feet facts of the property. Measurements are obtained by physical observation of the property by a certified Home Measurement Specialist. The method of measuring the subject home is in accordance with the NC Residential Square Footage Guidelines and those approved by the American National Standards Institute, Inc (ANSI), which are recognized by the North Carolina Real Estate Commission as comparable standards. Within every measurement project, some degree of art of opinion may be applied as well as rounding as set forth in the standards. Final finished square footage will be rounded to the nearest whole number with the goal of being within a 5% margin of error. Information deemed reliable, but not guaranteed.