

Building Sketch

Borrower/Client				
Property Address 1106 Arden Drive				
City	Monroe	County	State NC	Zip Code 28112
Lender				

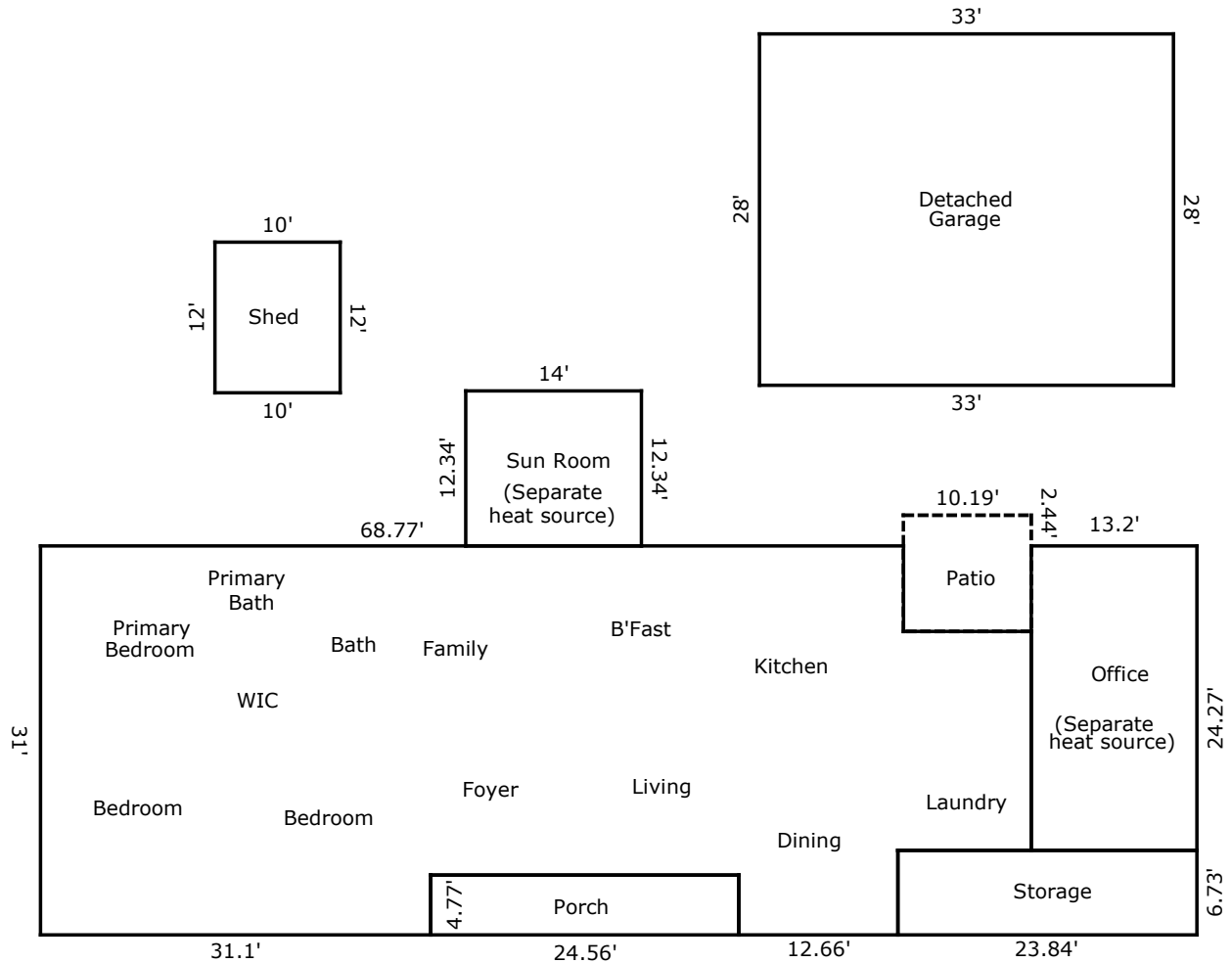

TOTAL Sketch by a la mode, inc.

Area Calculations Summary

Living Area	
Main Level	2189.51 Sq ft
Sun Room	172.76 Sq ft
Additional Living Space	320.36 Sq ft
Total Living Area (Rounded):	2683 Sq ft
Non-living Area	
Patio	94.36 Sq ft
Shed	120 Sq ft
Porch	117.15 Sq ft
Storage	160.44 Sq ft
Garage	924 Sq ft