

529 Ponce De Leon Boulevard, Belleair, Pinellas County, Florida, United States, 33756

Gross Living Area: 2438 sq. ft

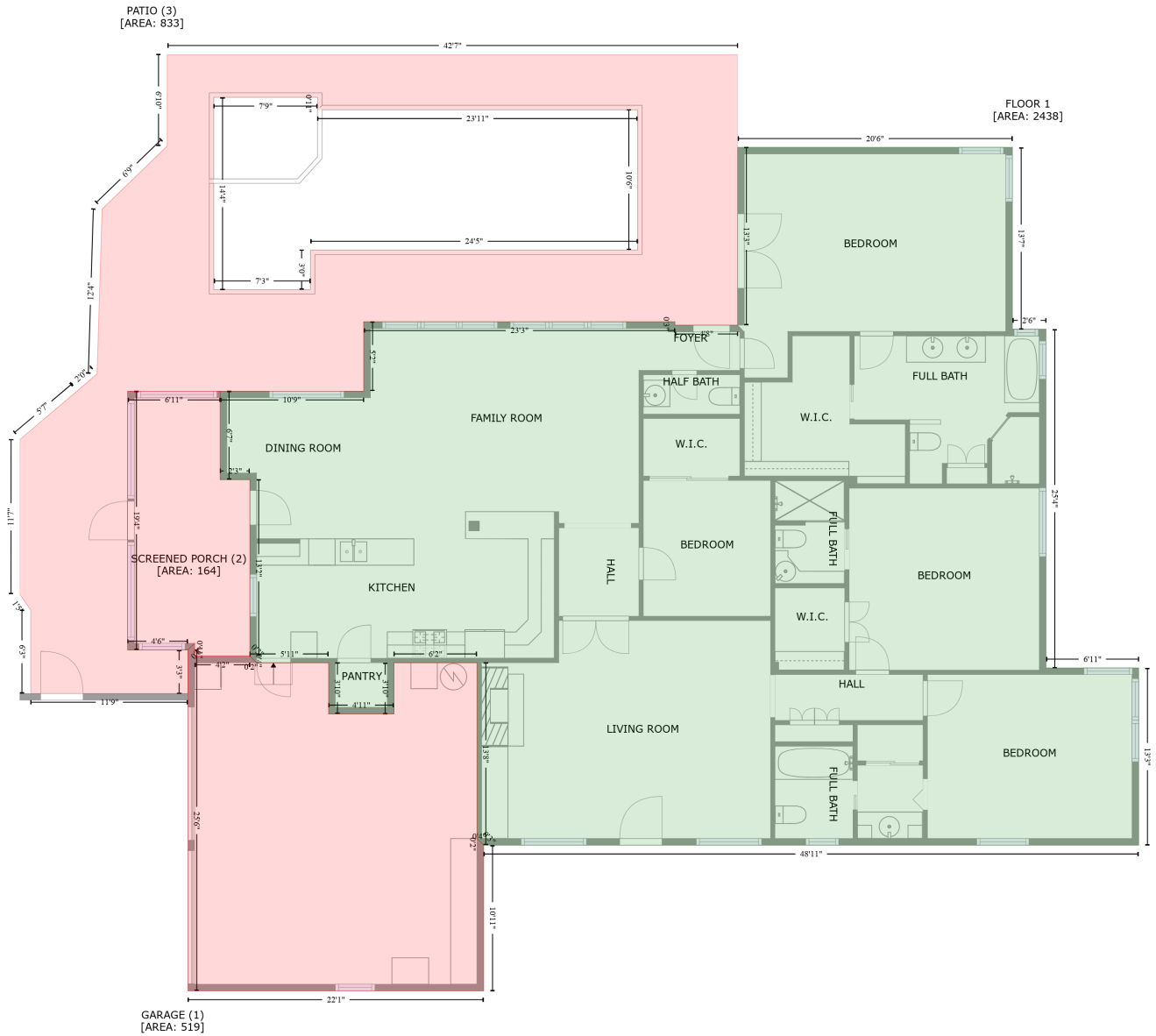

Space	Area (sq. ft)	Calculation <small>Coordinate Polygon Area Algorithm using inches</small>
FLOOR 1 (Living area)	2438	-((933.1 + 933.1) * (116.8 - 279.8) + (933.1 + 963.3) * (279.8 - 279.8) + (963.3 + 963.3) * (279.8 - 583.4) + (963.3 + 1046.3) * (583.4 - 583.4) + (1046.3 + 1046.3) * (583.4 - 742.3) + (1046.3 + 459.5) * (742.3 - 742.3) + (459.5 + 453.5) * (742.3 - 736.3) + (453.5 + 453.5) * (736.3 - 578.7) + (453.5 + 379) * (578.7 - 578.7) + (379 + 379) * (578.7 - 624.7) + (379 + 320.5) * (624.7 - 624.7) + (320.5 + 320.5) * (624.7 - 578.7) + (320.5 + 255.9) * (578.7 - 578.7) + (255.9 + 249.9) * (578.7 - 572.7) + (249.9 + 249.9) * (572.7 - 414.7) + (249.9 + 223.3) * (414.7 - 414.7) + (223.3 + 223.3) * (414.7 - 335.3) + (223.3 + 351.9) * (335.3 - 335.3) + (351.9 + 351.9) * (335.3 - 273.2) + (351.9 +

529 Ponce De Leon Boulevard, Belleair, Pinellas County, Florida, United States, 33756

Gross Living Area: 2438 sq. ft

Space	Area (sq. ft)	Calculation <small>Coordinate Polygon Area Algorithm using inches</small>
GARAGE (Non-living area)	519	$630.8 * (273.2 - 273.2) + (630.8 + 630.8) * (273.2 - 276.3) + (630.8 + 687) * (276.3 - 276.3) + (687 + 687) * (276.3 - 116.8) + (687 + 933.1) * (116.8 - 116.8) * 0.5 * 0.00694$ $-((200.4 + 200.4) * (561.3 - 572.7) + (200.4 + 249.9) * (572.7 - 572.7) + (249.9 + 255.9) * (572.7 - 578.7) + (255.9 + 320.5) * (578.7 - 578.7) + (320.5 + 320.5) * (578.7 - 624.7) + (320.5 + 379) * (624.7 - 624.7) + (379 + 379) * (624.7 - 578.7) + (379 + 453.5) * (578.7 - 578.7) + (453.5 + 453.5) * (578.7 - 736.3) + (453.5 + 459.5) * (736.3 - 742.3) + (459.5 + 459.5) * (742.3 - 872.9) + (459.5 + 194.4) * (872.9 - 872.9) + (194.4 + 194.4) * (872.9 - 567.3) + (194.4 + 200.4) * (567.3 - 561.3)) * 0.5 * 0.00694$
SCREENED PORCH (Non-living area)	164	$-((223.3 + 223.3) * (335.3 - 414.7) + (223.3 + 249.9) * (414.7 - 414.7) + (249.9 + 249.9) * (414.7 - 572.7) + (249.9 + 200.4) * (572.7 - 572.7) + (200.4 + 200.4) * (572.7 - 561.3) + (200.4 + 194.4) * (561.3 - 567.3) + (194.4 + 140.4) * (567.3 - 567.3) + (140.4 + 140.4) * (567.3 - 335.3) + (140.4 + 223.3) * (335.3 - 335.3)) * 0.5 * 0.00694$
PATIO (Non-living area)	833	$-((687 + 687) * (33.4 - 276.3) + (687 + 630.8) * (276.3 - 276.3) + (630.8 + 630.8) * (276.3 - 273.2) + (630.8 + 351.9) * (273.2 - 273.2) + (351.9 + 351.9) * (273.2 - 335.3) + (351.9 + 140.4) * (335.3 - 335.3) + (140.4 + 140.4) * (335.3 - 567.3) + (140.4 + 194.4) * (567.3 - 567.3) + (194.4 + 194.4) * (567.3 - 606.3) + (194.4 + 53.5) * (606.3 - 606.3) + (53.5 + 53.5) * (606.3 - 531.5) + (53.5 + 43.7) * (531.5 - 517.3) + (43.7 + 43.8) * (517.3 - 378.7) + (43.8 + 94.9) * (378.7 - 335.3) + (94.9 + 113) * (335.3 - 319.9) + (113 + 117.5) * (319.9 - 172.2) + (117.5 + 175.9) * (172.2 - 115.6) + (175.9 + 175.9) * (115.6 - 33.4) + (175.9 + 687) * (33.4 - 33.4)) * 0.5 * 0.00694 - ((310.5 + 217.5) * (72 - 72) + (217.5 + 217.5) * (72 - 244.4) + (217.5 + 304.1) * (244.4 - 244.4) + (304.1 + 304.1) * (244.4 - 208.9) + (304.1 + 597.4) * (208.9 - 208.9) + (597.4 + 597.4) * (208.9 - 83.2) + (597.4 + 310.5) * (83.2 - 83.2) + (310.5 + 310.5) * (83.2 - 72)) * 0.5 * 0.00694$