

Building Sketch

Borrower/Client				
Property Address 29373 Tiffany Woods Road				
City	Richfield	County	State NC	Zip Code 28137
Lender				

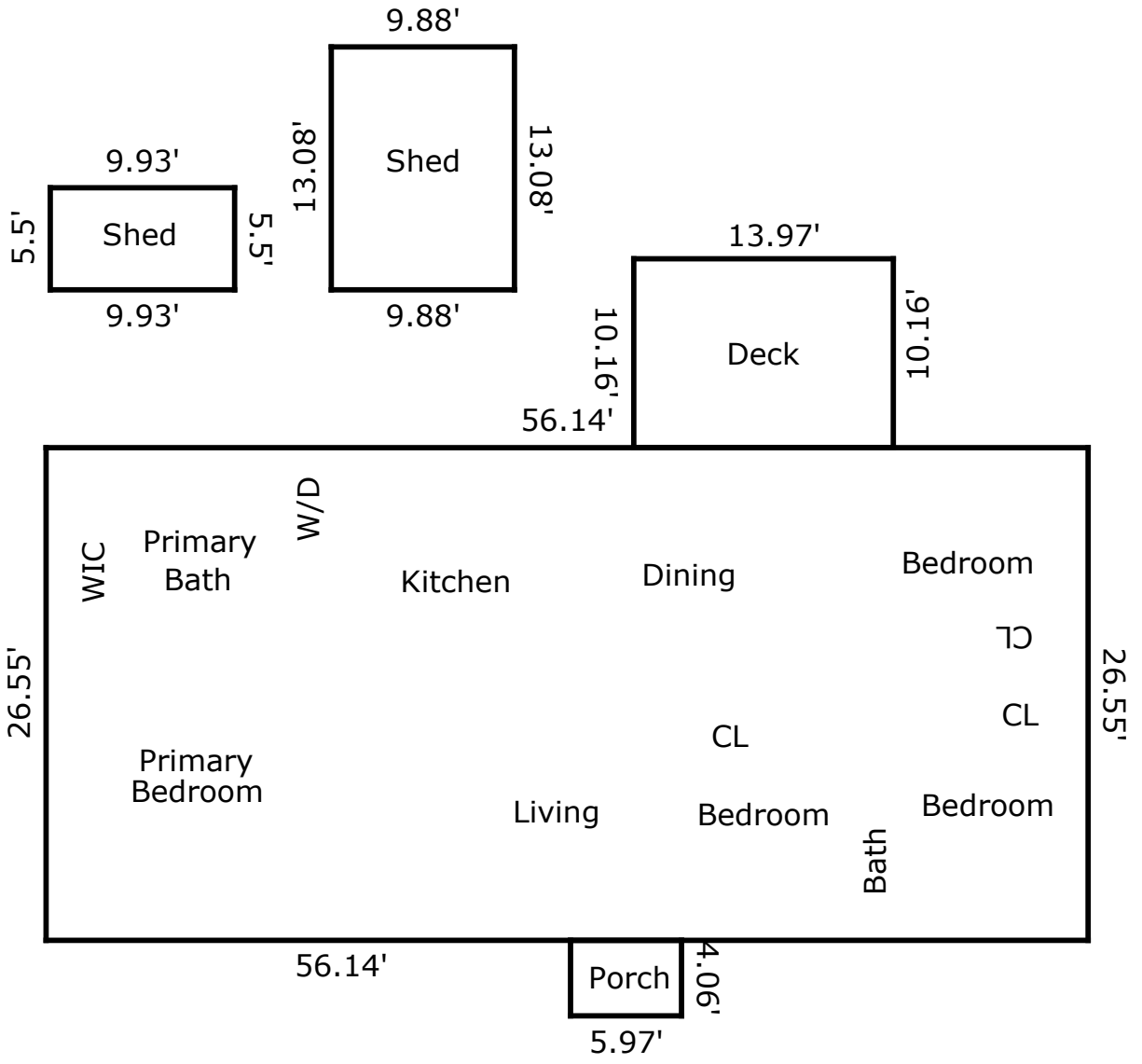

TOTAL Sketch by a la mode

Area Calculations Summary

Living Area	
Main Level	1490.52 Sq ft
Total Living Area (Rounded):	1491 Sq ft
Non-living Area	
Shed	129.23 Sq ft
Shed	54.62 Sq ft
Deck	141.94 Sq ft
Porch	24.24 Sq ft