

# Building Sketch

Borrower/Client				
Property Address 1380 Bowers Road				
City	Peachland	County	State NC	Zip Code 28133
Lender				

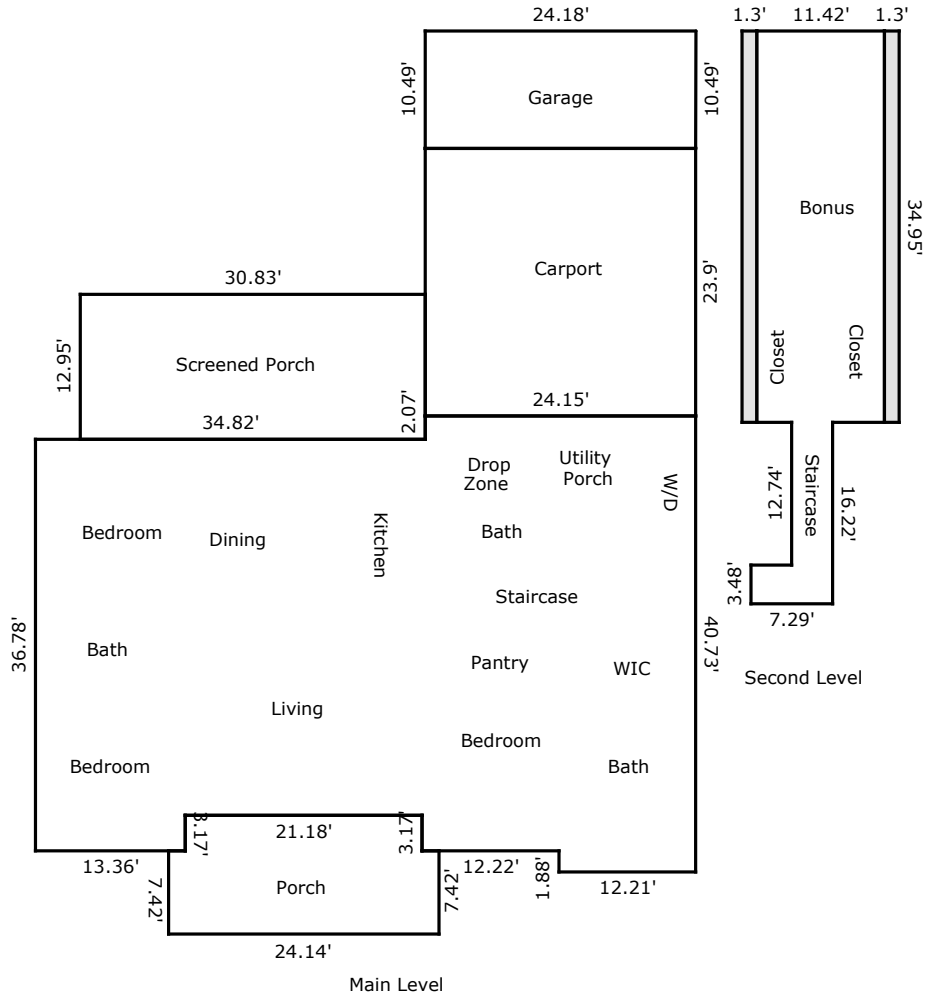

TOTAL Sketch by a la mode

### Area Calculations Summary

<b>Living Area</b>	
Main Level	2174.72 Sq ft
Screened Porch	399.25 Sq ft
Second Floor	471.25 Sq ft
<b>Total Living Area (Rounded):</b>	<b>3045 Sq ft</b>
<b>Non-living Area</b>	
Detached Garage	253.49 Sq ft
Porch	246.26 Sq ft
Carport	577.18 Sq ft
Area Below 5 Feet	45.43 Sq ft
Area Below 5 Feet	45.43 Sq ft