

Building Sketch

Borrower/Client				
Property Address 5613 Berry Ridge Drive				
City	Harrisburg	County	State NC	Zip Code 28075
Lender				

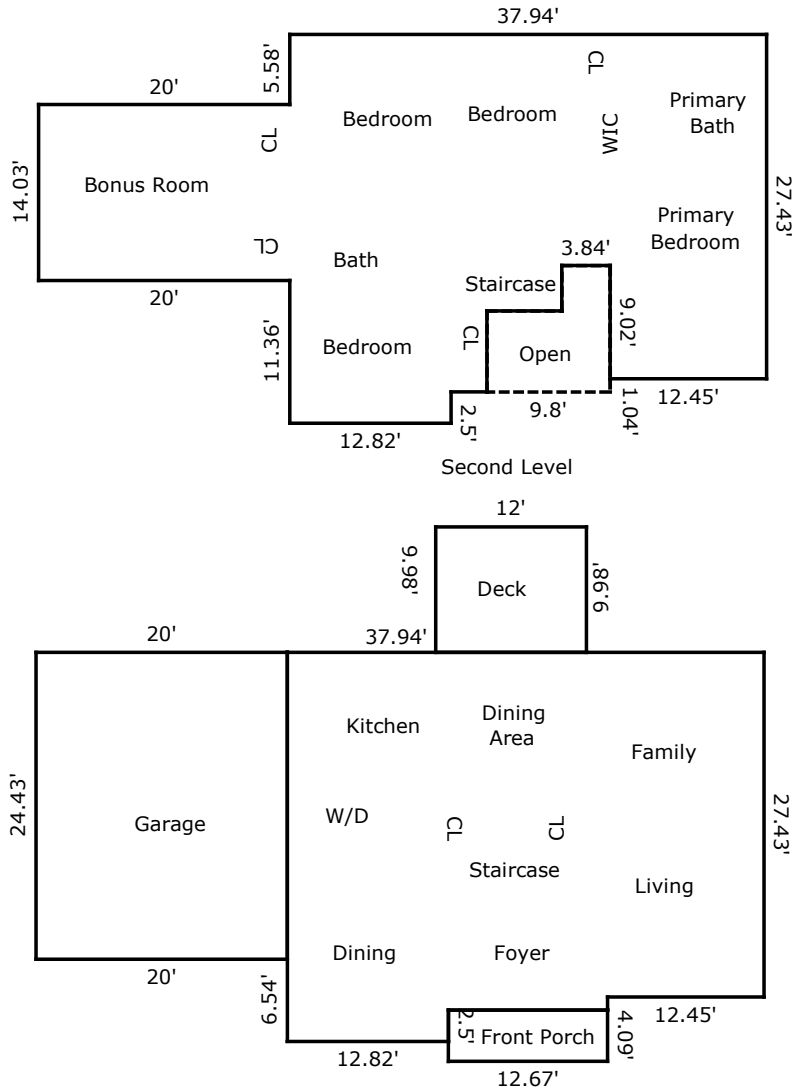

TOTAL Sketch by a la mode

Area Calculations Summary

Living Area	
Main Level	1099.25 Sq ft
Open to Below	-77.01 Sq ft
Second Level	1302.84 Sq ft
Total Living Area (Rounded):	2402 Sq ft
Non-living Area	
Porch	51.82 Sq ft
Deck	119.81 Sq ft
Garage	488.6 Sq ft