

SECOND FLOOR

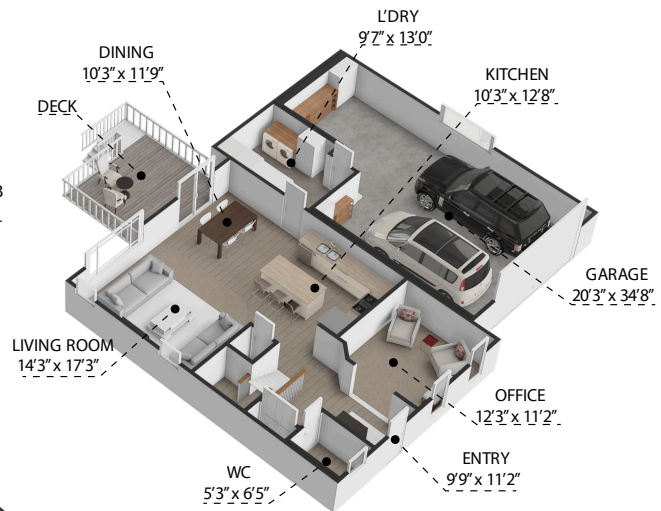

FIRST FLOOR

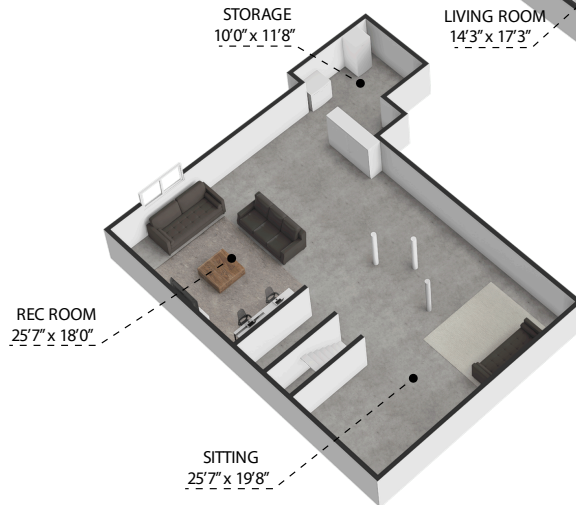

BASEMENT

4865 Sunny Spring Way, DeForest, WI, 53532

TOTAL APPROX. FLOOR AREA 3,752 SQ.FT

Whilst every attempt has been made to ensure the accuracy of the floor plan contained here, measurements of doors, windows, rooms and any other items are approximate and no responsibility is taken for any error, omission, or misstatement. This plan is for illustrative purposes only and should be used as such by any prospective purchaser.