

# 723 Bay Esplanade, 700 Island Way, Clearwater Beach, Pinellas County, Florida, United States, 33767

Gross Living Area: 1206 sq. ft

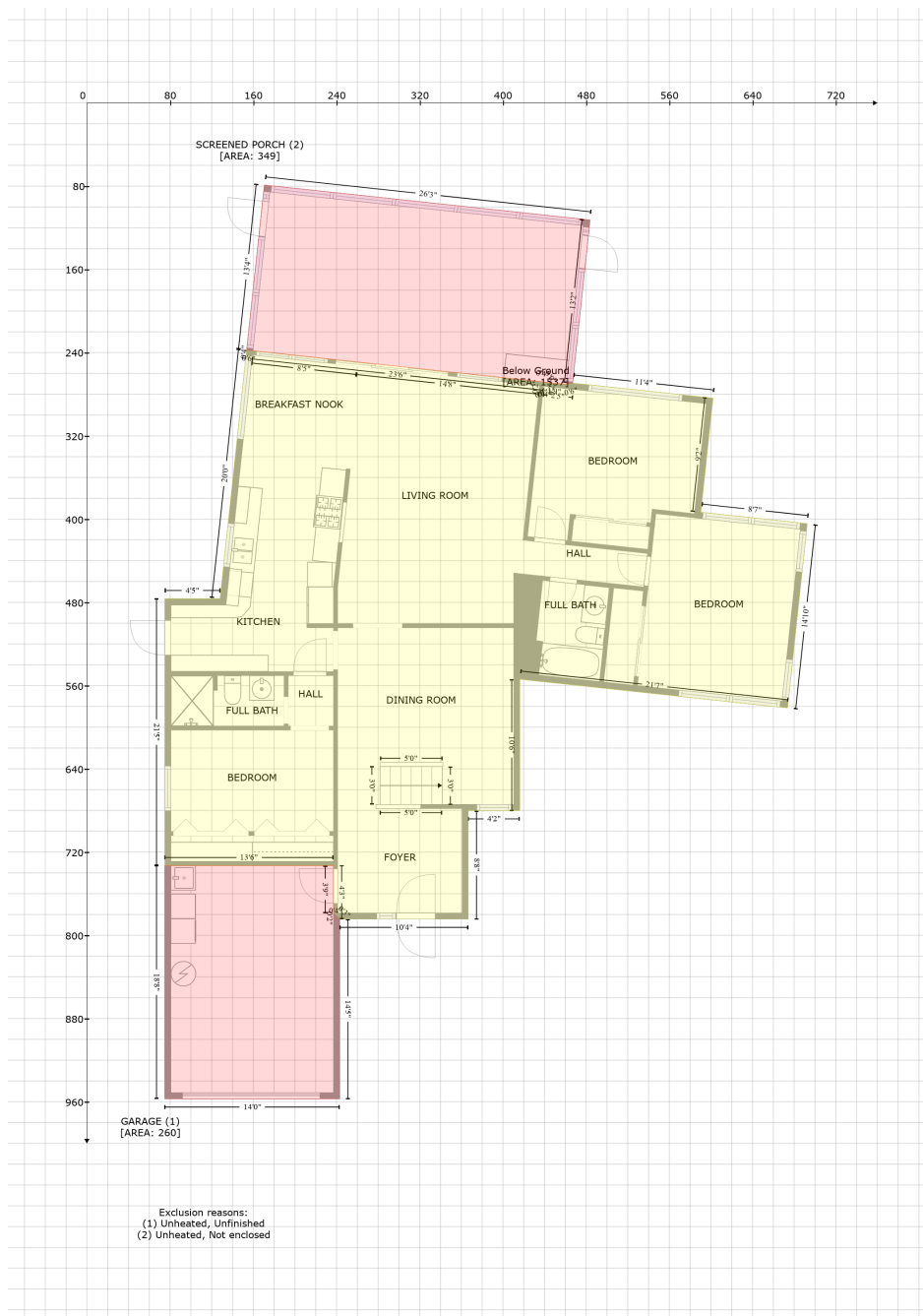

Space	Area (sq. ft)	Calculation
Below Ground (Living area)	1537	Coordinate Polygon Area Algorithm using inches $-((159.4 + 159) * (238.2 - 242.1) + (159 + 259.8) * (242.1 - 253.1) + (259.8 + 435) * (253.1 - 272) + (435 + 435.1) * (272 - 272) + (435.1 + 439.1) * (272 - 272.3) + (439.1 + 439) * (272.3 - 274.6) + (439 + 439.3) * (274.6 - 272.4) + (439.3 + 467.8) * (272.4 - 275.4) + (467.8 + 259.8) * (275.4 - 253) + (259.8 + 159) * (253 - 242.1) + (159 + 159.4) * (242.1 - 238.2) * 0.5 * 0.00694 + -((159.4 + 435.6) * (238.2 - 267.9) + (435.6 + 439.6) * (267.9 - 268.3) + (439.6 + 439.7) * (268.3 - 268.5) + (439.7 + 457.8) * (268.5 - 270.1) + (457.8 + 460.9) * (270.1 - 270.5) + (460.9 + 467) * (270.5 - 269.2) + (467 + 602) * (269.2 - 283.7) + (602 + 590.3) * (283.7 - 393.4) + (590.3 + 692.6) *$

# 723 Bay Esplanade, 700 Island Way, Clearwater Beach, Pinellas County, Florida, United States, 33767

Gross Living Area: 1206 sq. ft

Space	Area (sq. ft)	Calculation <small>Coordinate Polygon Area Algorithm using inches</small>
		$(393.4 - 404.4) + (692.6 + 673.6) * (404.4 - 581.5) + (673.6 + 416.3) * (581.5 - 553.9) + (416.3 + 416.3) * (553.9 - 680.2) + (416.3 + 366.7) * (680.2 - 680.2) + (366.7 + 366.7) * (680.2 - 784.5) + (366.7 + 243.1) * (784.5 - 784.5) + (243.1 + 237.1) * (784.5 - 778.5) + (237.1 + 237.1) * (778.5 - 733.1) + (237.1 + 74.8) * (733.1 - 733.1) + (74.8 + 74.8) * (733.1 - 476.4) + (74.8 + 128) * (476.4 - 476.4) + (128 + 153.6) * (476.4 - 237.6) + (153.6 + 159.4) * (237.6 - 238.2) * 0.5 * 0.00694$
GARAGE (Non-living area)	260	$-((237.1 + 237.1) * (733.1 - 778.5) + (237.1 + 243.1) * (778.5 - 784.5) + (243.1 + 243.1) * (784.5 - 957.2) + (243.1 + 74.8) * (957.2 - 957.2) + (74.8 + 74.8) * (957.2 - 733.1) + (74.8 + 237.1) * (733.1 - 733.1)) * 0.5 * 0.00694$
SCREENED PORCH (Non-living area)	349	$-((170.6 + 483.8) * (78.9 - 112.5) + (483.8 + 467) * (112.5 - 269.2) + (467 + 460.8) * (269.2 - 270.4) + (460.8 + 439.7) * (270.4 - 268.5) + (439.7 + 439.6) * (268.5 - 268.3) + (439.6 + 435.6) * (268.3 - 267.9) + (435.6 + 159.6) * (267.9 - 238.2) + (159.6 + 153.6) * (238.2 - 237.6) + (153.6 + 170.6) * (237.6 - 78.9)) * 0.5 * 0.00694$

# 723 Bay Esplanade, 700 Island Way, Clearwater Beach, Pinellas County, Florida, United States, 33767

Gross Living Area: 1206 sq. ft



## Space

Area (sq. ft)

Calculation Coordinate Polygon Area Algorithm using inches

FLOOR 2  
(Living area)

1206

$$\begin{aligned}
 & -((131.6 + 436.3) * (273.3 - 306) + (436.3 + 436.4) * (306 - 306) + (436.4 + 430.6) * (306 - 360.9) \\
 & + (430.6 + 424.7) * (360.9 - 415.7) + (424.7 + 544.3) * (415.7 - 428.5) + (544.3 + 528.9) * (428.5 - \\
 & 572.5) + (528.9 + 416.3) * (572.5 - 560.5) + (416.3 + 416.3) * (560.5 - 720.2) + (416.3 + 366.7) * \\
 & (720.2 - 720.2) + (366.7 + 366.7) * (720.2 - 888) + (366.7 + 144.2) * (888 - 888) + (144.2 + 144.2) \\
 & * (888 - 595.3) + (144.2 + 106.7) * (595.3 - 595.3) + (106.7 + 106.7) * (595.3 - 504.4) + (106.7 + \\
 & 131.4) * (504.4 - 273.3) + (131.4 + 131.6) * (273.3 - 273.3) * 0.5 * 0.00694 + -((367.4 + 281.9) * \\
 & (566.1 - 566.1) + (281.9 + 281.9) * (566.1 - 673.8) + (281.9 + 367.4) * (673.8 - 673.8) + (367.4 +
 \end{aligned}$$

# 723 Bay Esplanade, 700 Island Way, Clearwater Beach, Pinellas County, Florida, United States, 33767

Gross Living Area: 1206 sq. ft

Space	Area (sq. ft)	Calculation <small>Coordinate Polygon Area Algorithm using inches</small>
PATIO (Non-living area)	1014	$367.4 * (673.8 - 566.1) * 0.5 * 0.00694$ $-((126 + 509) * (78.9 - 114.9) + (509 + 491.7) * (114.9 - 278.6) + (491.7 + 491.5) * (278.6 - 278.7) + (491.5 + 614.4) * (278.7 - 295.7) + (614.4 + 605.1) * (295.7 - 402.5) + (605.1 + 707.9) * (402.5 - 414.5) + (707.9 + 682.3) * (414.5 - 659.6) + (682.3 + 416.3) * (659.6 - 631.8) + (416.3 + 416.3) * (631.8 - 560.5) + (416.3 + 528.9) * (560.5 - 572.5) + (528.9 + 544.3) * (572.5 - 428.5) + (544.3 + 424.7) * (428.5 - 415.7) + (424.7 + 436.4) * (415.7 - 306) + (436.4 + 436.3) * (306 - 306) + (436.3 + 98.2) * (306 - 269.7) + (98.2 + 105.2) * (269.7 - 204.3) + (105.2 + 73.6) * (204.3 - 200.8) + (73.6 + 76.8) * (200.8 - 169.2) + (76.8 + 116.2) * (169.2 - 173.3) + (116.2 + 126) * (173.3 - 78.9)) * 0.5 * 0.00694$
OPEN TO BELOW (Non-living area)	64	$-((367.4 + 367.4) * (566.1 - 673.8) + (367.4 + 281.9) * (673.8 - 673.8) + (281.9 + 281.9) * (673.8 - 566.1) + (281.9 + 367.4) * (566.1 - 566.1)) * 0.5 * 0.00694$