

Building Sketch

Borrower/Client

Property Address 3416 Fairfax Woods Drive

City Matthews

County

State NC

Zip Code 28105

Lender

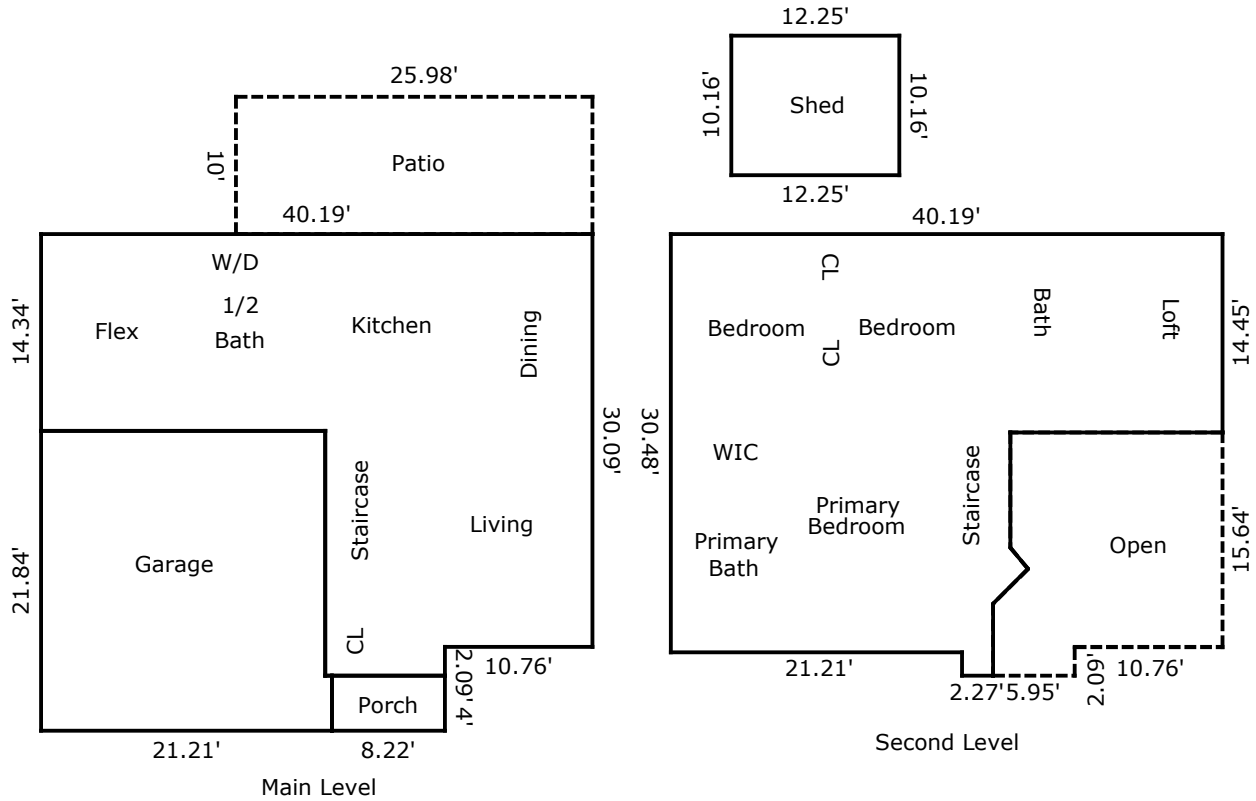

TOTAL Sketch by a la mode

Area Calculations Summary

Living Area

Main Level	901.36 Sq ft
Open to Below	-257.02 Sq ft
Second Level	977.75 Sq ft
Total Living Area (Rounded):	1879 Sq ft

Non-living Area

Garage	454.31 Sq ft
Porch	32.88 Sq ft
Patio	259.8 Sq ft
Shed	124.46 Sq ft