

# Building Sketch

Borrower/Client			
Property Address 3810 New Salem Road			
City Monroe	County	State NC	Zip Code 28110
Lender			

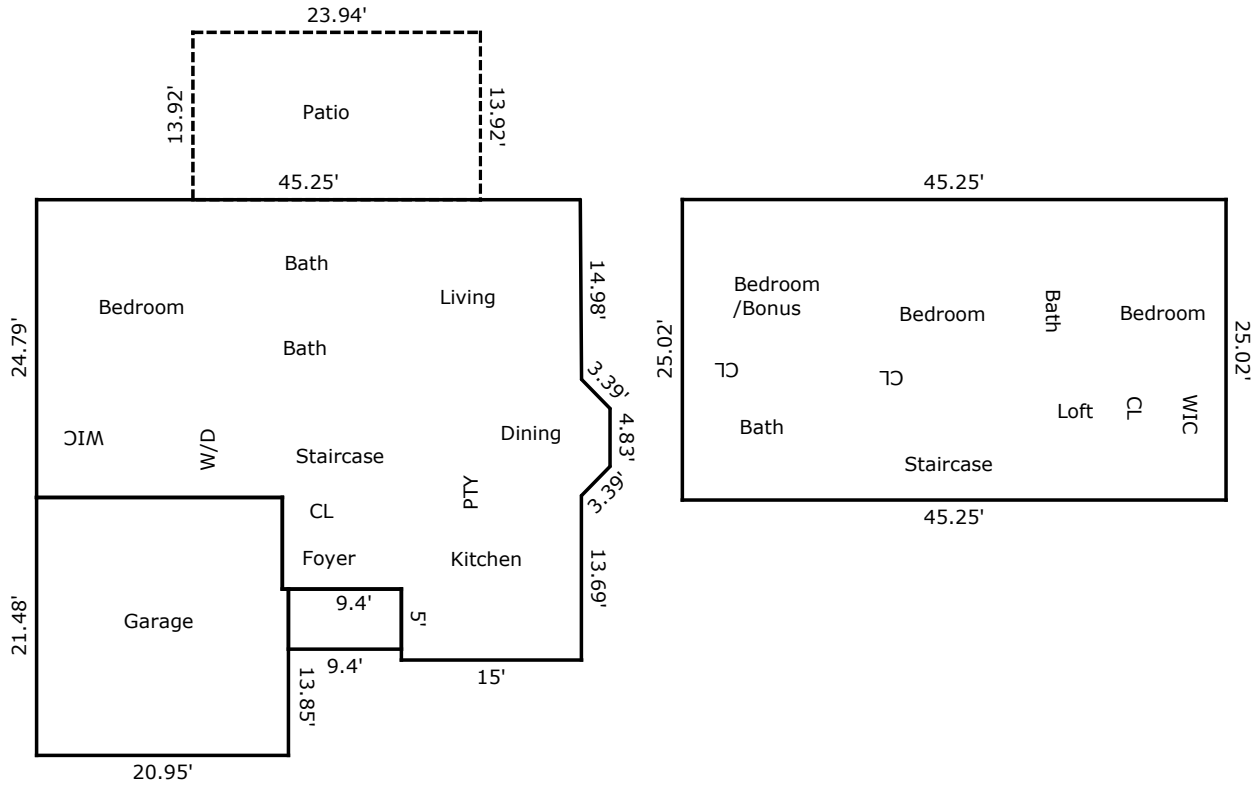

TOTAL Sketch by a la mode

## Area Calculations Summary

Living Area	Calculation Details	
Main Living Area	1419.34 Sq ft	$0.5 \times 2.42 \times 2.38 = 2.87$ $0.5 \times 2.38 \times 2.42 = 2.87$ $4.83 \times 2.38 = 11.48$ $24.79 \times 20.45 = 506.96$ $15 \times 5.91 = 88.65$ $32.42 \times 24.8 = 804.02$ $0.1 \times 17.44 = 1.74$ $0.5 \times 0.1 \times 14.98 = 0.75$
Second Level	1132.16 Sq ft	$45.25 \times 25.02 = 1132.16$
<b>Total Living Area (Rounded):</b>	<b>2551 Sq ft</b>	
<b>Non-living Area</b>		
Porch	47 Sq ft	$5 \times 9.4 = 47$
Patio	333.24 Sq ft	$23.94 \times 13.92 = 333.24$
Garage	446.19 Sq ft	$21.48 \times 20.45 = 439.27$ $0.5 \times 13.85 = 6.92$