

# Building Sketch

Borrower/Client			
Property Address 29 Colson Avenue			
City	Ansonville	County	State NC Zip Code 28007
Lender			

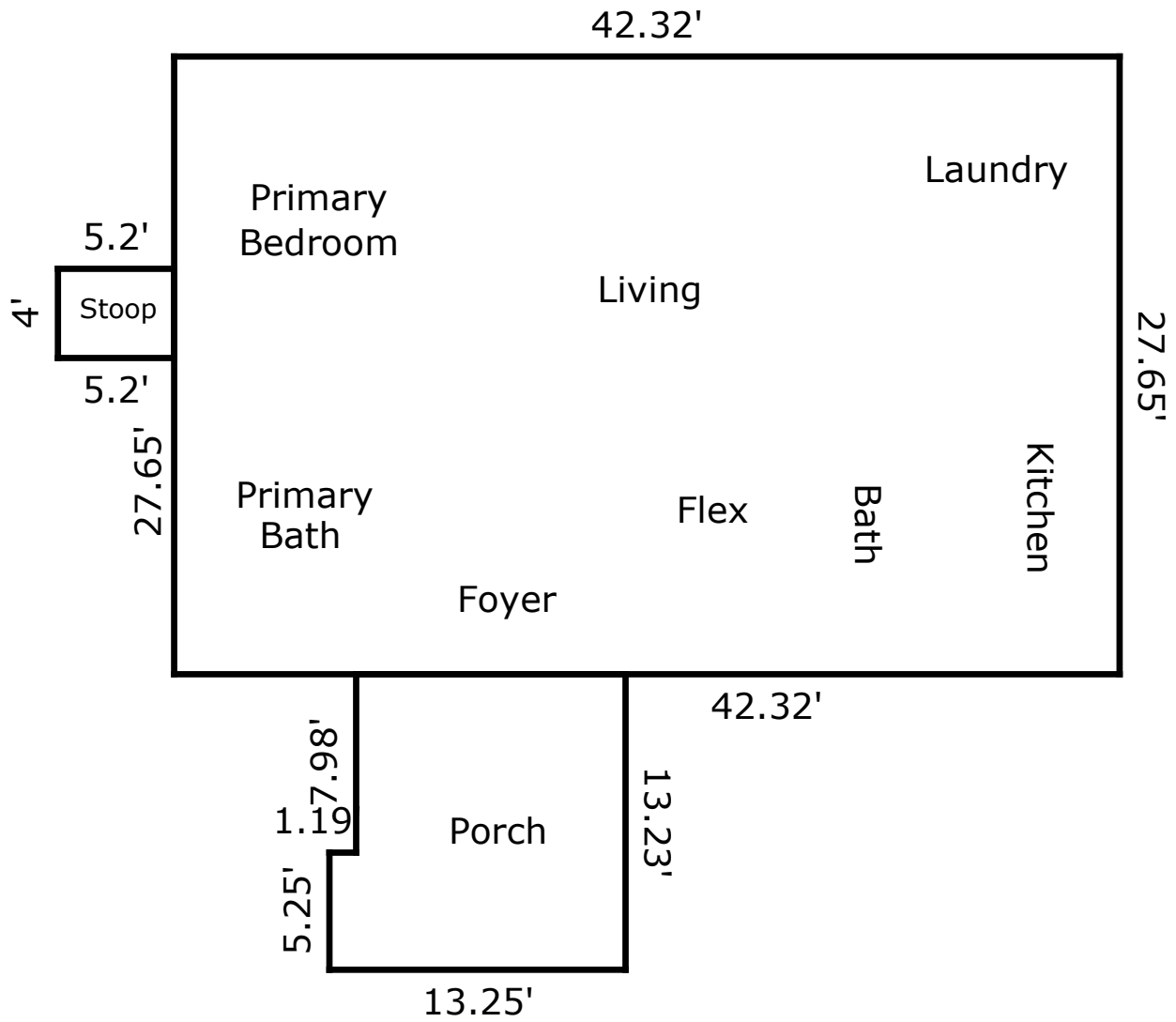

TOTAL Sketch by a la mode

### Area Calculations Summary

<b>Living Area</b>	
Main Level	1170.15 Sq ft
<b>Total Living Area (Rounded):</b>	<b>1170 Sq ft</b>
<b>Non-living Area</b>	
Stoop	20.8 Sq ft
Porch	165.8 Sq ft