

Building Sketch

Borrower/Client				
Property Address 1255 Kennett Ave				
City	Gastonia	County	State NC	Zip Code 28054
Lender				

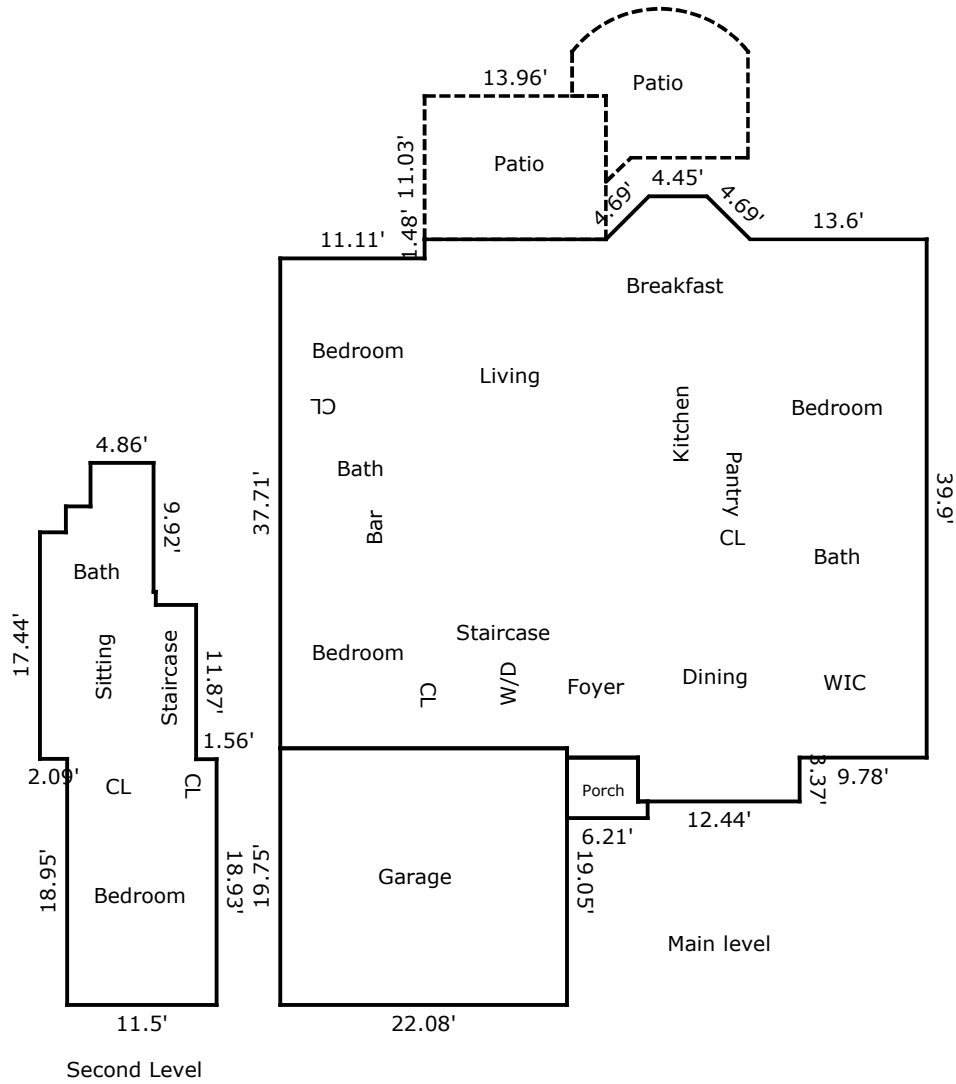

TOTAL Sketch by a la mode

Area Calculations Summary

Living Area	
Main Level	2020.91 Sq ft
Second Floor	439.23 Sq ft
Total Living Area (Rounded):	2460 Sq ft
Non-living Area	
Patio	153.98 Sq ft
Patio	131.07 Sq ft
Porch	26.47 Sq ft
Garage	436.08 Sq ft