



Jeff Titus - REALTOR®

PMZ Real Estate

209-988-3335

jtituspmz@gmail.com



### Main Floor

Finished Area 2078.00 sq ft



### Basement (Below Grade)

Unfinished Area 179.84 sq ft

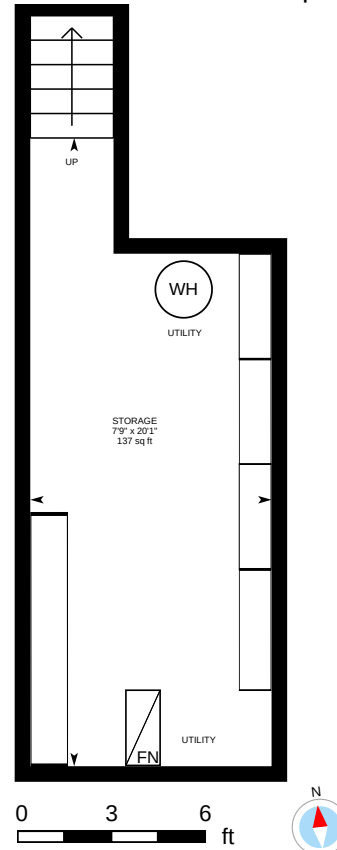

### Garage

Unfinished Area 305.07 sq ft

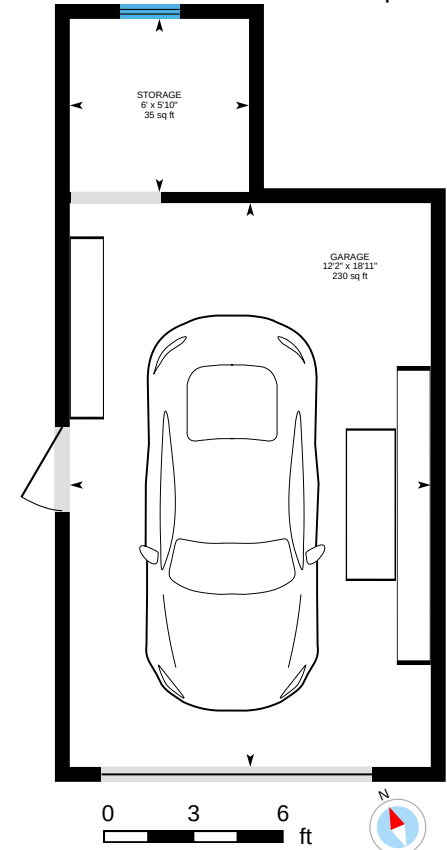

## 4701 Lone Tree Rd, Valley Home, CA

For illustrative purposes only. All reported dimensions, property sizes and floor areas are approximate and subject to independent verification. To the extent permitted by law, no warranty is made as to accuracy or completeness, and no liability will be accepted for any errors or omissions.



Powered by iGUIDE



Jeff Titus - REALTOR®

PMZ Real Estate

209-988-3335

jtituspmz@gmail.com



### Shop

Unfinished Area 739.19 sq ft

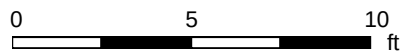
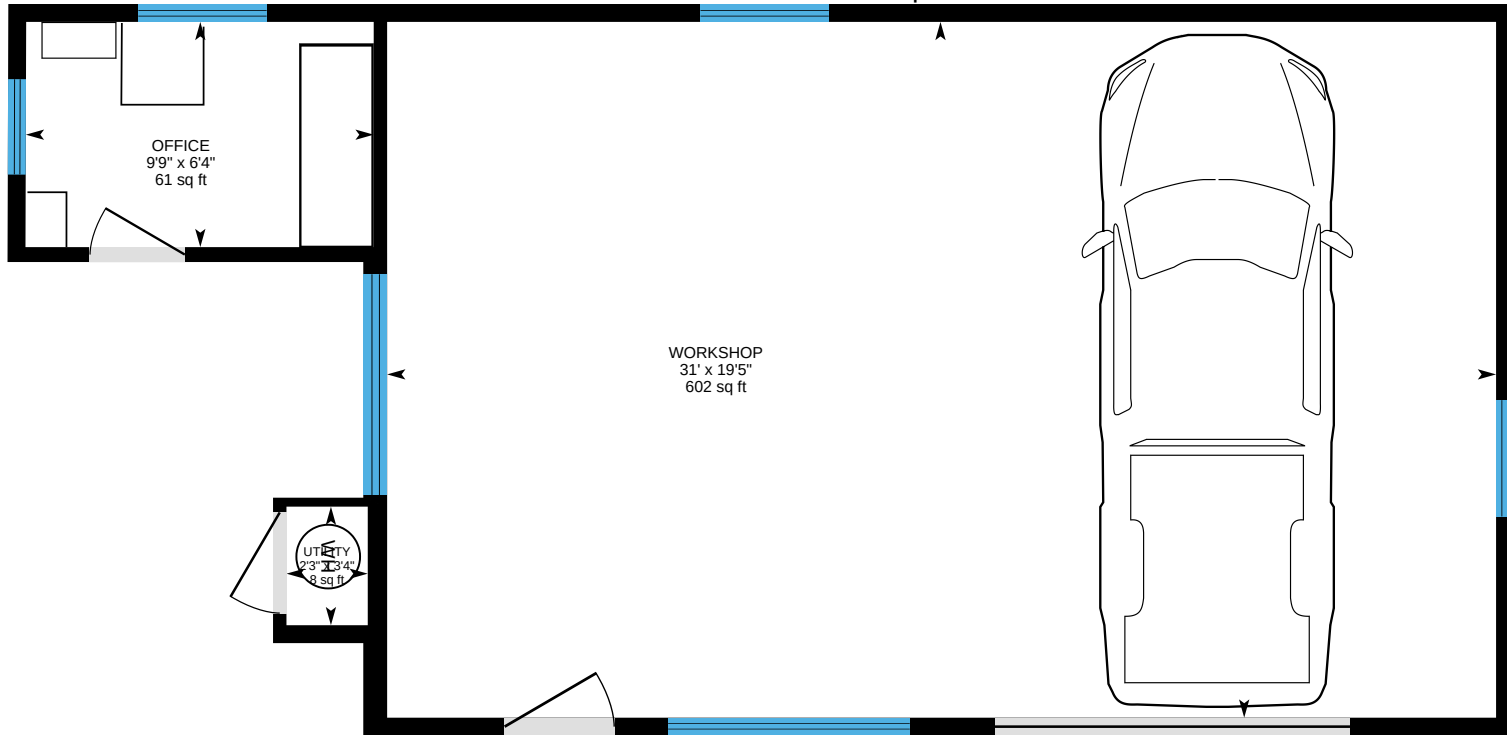

**4701 Lone Tree Rd, Valley Home, CA**

For illustrative purposes only. All reported dimensions, property sizes and floor areas are approximate and subject to independent verification. To the extent permitted by law, no warranty is made as to accuracy or completeness, and no liability will be accepted for any errors or omissions.



Powered by **iGUIDE**