

## Building Sketch

Borrower/Client				
Property Address 929 Wrights Creek Way				
City	Wake Forest	County	State	Zip Code
Lender				

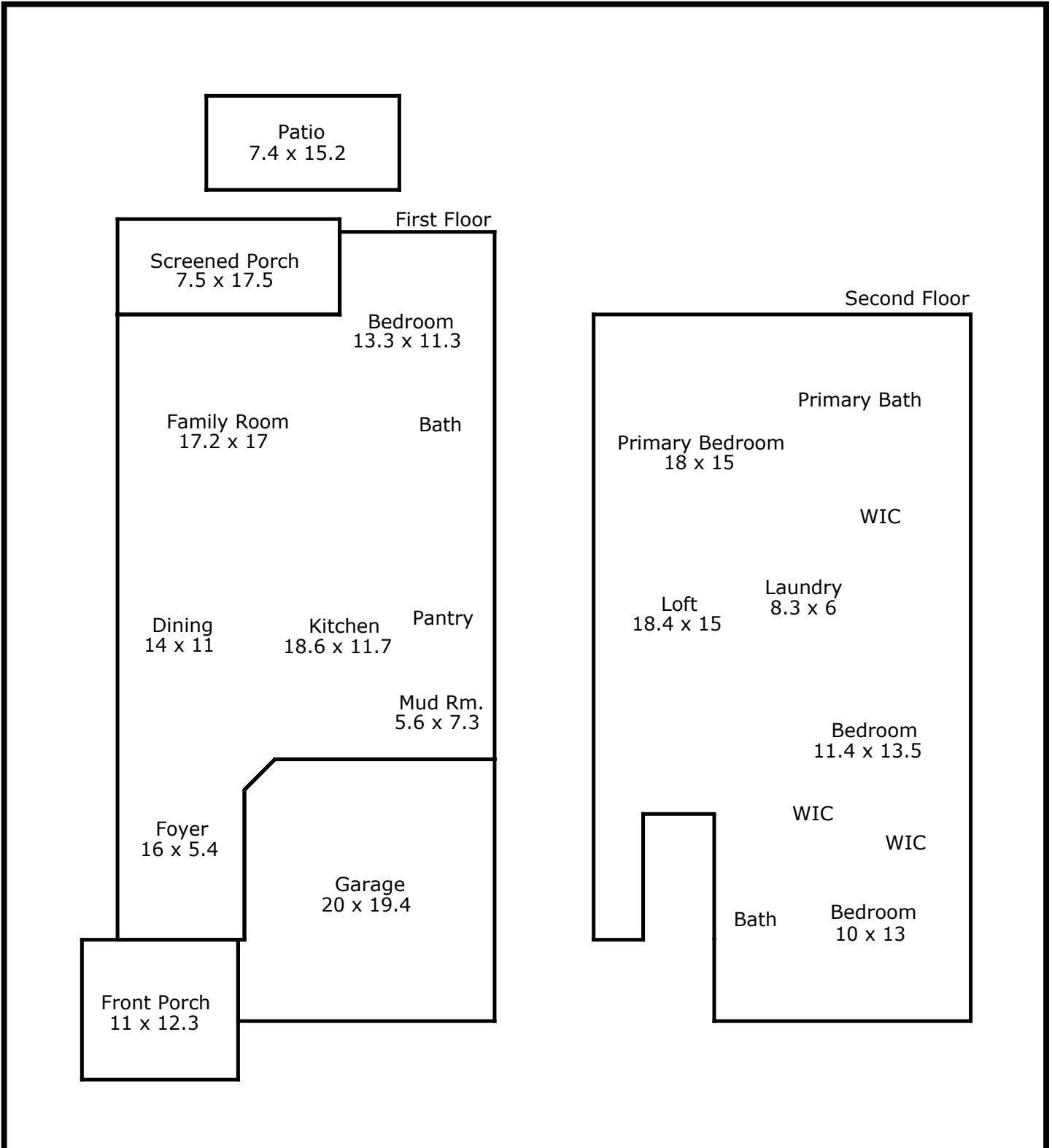

TOTAL Sketch by a la mode

### Area Calculations Summary

<b>Living Area</b>	
First Floor	1263.6 Sq ft
Second Floor	1535.1 Sq ft
<b>Total Living Area (Rounded):</b>	<b>2799 Sq ft</b>
<b>Non-living Area</b>	
Screened Porch	131.3 Sq ft
Garage	406.2 Sq ft
Patio	112.5 Sq ft
Front Porch	135.3 Sq ft