

163 Swopes Valley Rd, Pine Grove, PA 17963

Total finished area: ~1,209.89 sq. ft.

Total unfinished area: ~ 595.18 sq. ft.

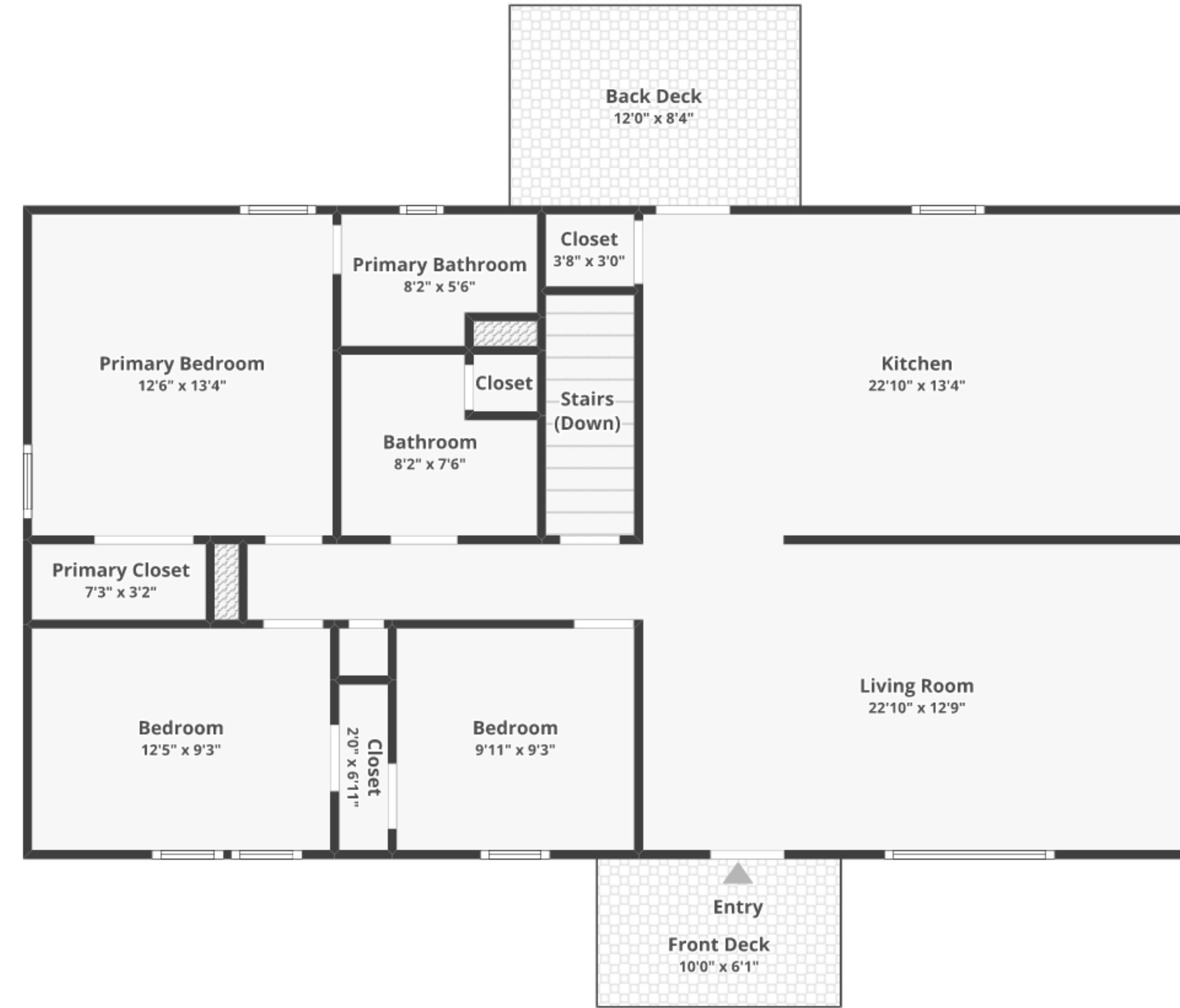

FLOOR 1

Finished area: ~1,209.89 sq. ft.

Unfinished area: ~5.81 sq. ft.

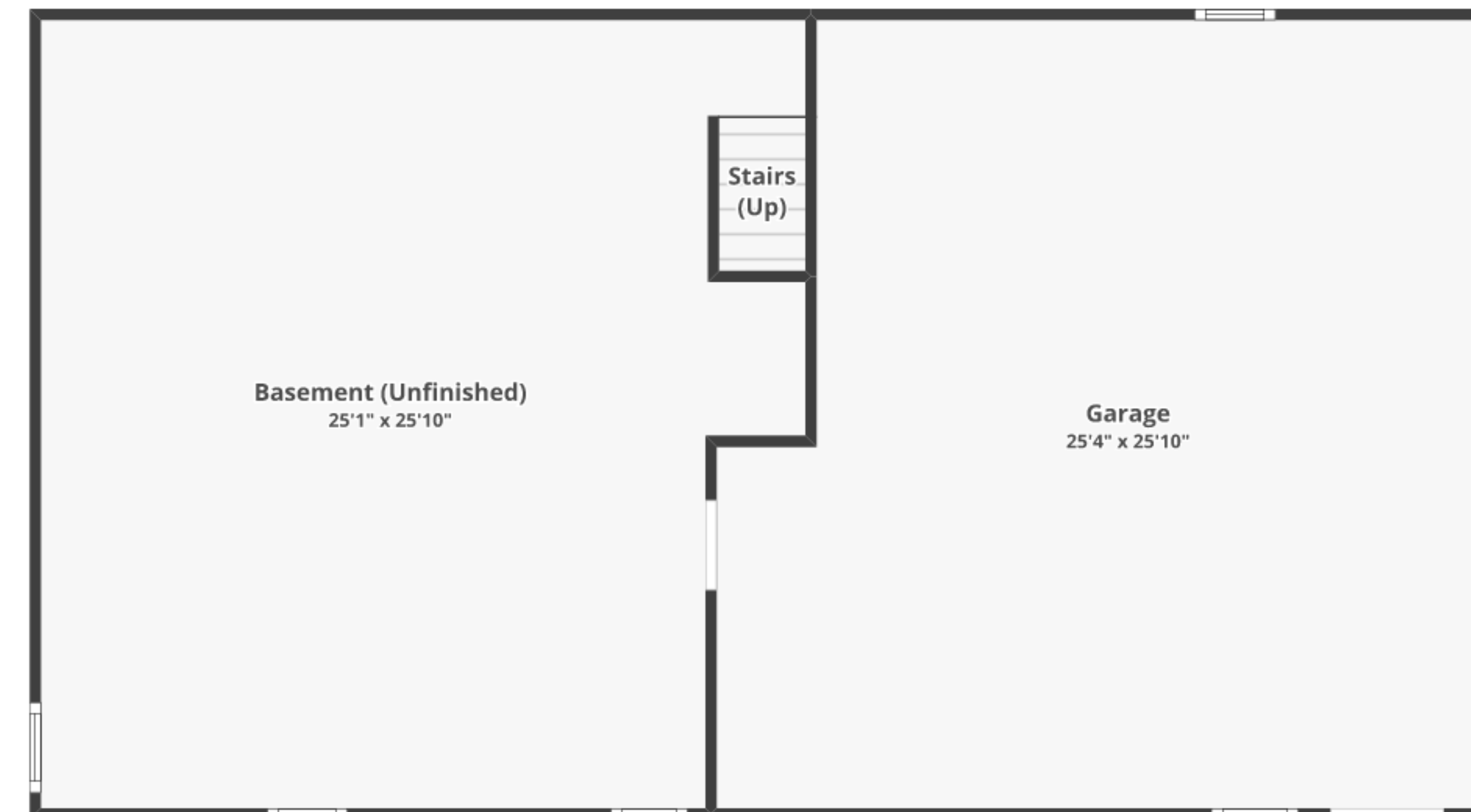

BASEMENT

Finished area: ~0 sq. ft.

Unfinished area: ~589.37 sq. ft.