

Home data report

31424 Amberview Bend, Wesley Chapel, Pasco County, Florida,
United States, 33545



Total Area: 1863 sq. ft
Below Ground: 888 sq. ft, 1st Floor: 975 sq. ft
Excluded: Porch 33 sq. ft, Patio 102 sq. ft, Walls: 112 sq. ft

Property summary

 **2** Floors

 **3** Bedrooms

 **2** Bathrooms

Home data report

**31424 Amberview Bend, Wesley Chapel, Pasco County, Florida,
United States, 33545**



1
Half baths



1
Garages

Home data report

31424 Amberview Bend, Wesley Chapel, Pasco County, Florida,
United States, 33545

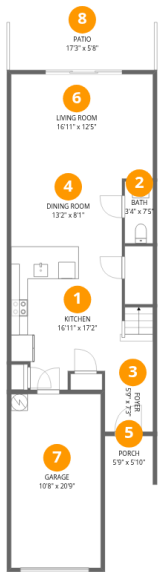

Room dimensions

Floor 1 Below grade Total:888sqft Excluded: 135sqft

#		Dimensions	sqft	Counted as living area
1	Kitchen	16'11" x 17'2"	232 sq. ft	Yes
2	Bath	3'4" x 7'5"	25 sq. ft	Yes
3	Foyer	5'9" x 7'3"	42 sq. ft	Yes
4	Dining Room	13'2" x 8'1"	107 sq. ft	Yes
5	Porch	5'9" x 5'10"	33 sq. ft	No
6	Living Room	16'11" x 12'5"	211 sq. ft	Yes
7	Garage	10'8" x 20'9"	222 sq. ft	Yes
8	Patio	17'3" x 5'8"	102 sq. ft	No

Home data report

31424 Amberview Bend, Wesley Chapel, Pasco County, Florida,
United States, 33545



Room dimensions

Floor 2 Total:975sqft Excluded: 0sqft

#		Dimensions	sqft	Counted as living area
9	W.I.C.	5'1" x 3'11"	20 sq. ft	Yes
10	Hall	7'2" x 16'7"	125 sq. ft	Yes
11	Hall	9'6" x 11'2"	81 sq. ft	Yes
12	Bath	9'5" x 4'11"	47 sq. ft	Yes
13	Bedroom	10'11" x 10'5"	112 sq. ft	Yes
14	Primary Bedroom	14'6" x 14'9"	215 sq. ft	Yes
15	Bedroom	10'8" x 18'8"	149 sq. ft	Yes
16	Bath	9'5" x 11'0"	85 sq. ft	Yes

1 Floor 1 - Kitchen



Dimensions: 16'11" x 17'2"
Area: 232 sq. ft
Counted as living area: Yes

Heated: Yes
Finished: Yes
Enclosed: Yes
Contiguous: Yes
Permitted: Yes
Wet space: No
Addition: No
Conversion: No

2 Floor 1 - Bath



Dimensions: 3'4" x 7'5"
Area: 25 sq. ft
Counted as living area: Yes

Heated: Yes
Finished: Yes
Enclosed: Yes
Contiguous: Yes
Permitted: Yes
Wet space: Yes
Addition: No
Conversion: No

3 Floor 1 - Foyer



Dimensions: 5'9" x 7'3"
Area: 42 sq. ft
Counted as living area: Yes

Heated: Yes
Finished: Yes
Enclosed: Yes
Contiguous: Yes
Permitted: Yes
Wet space: No
Addition: No
Conversion: No

4 Floor 1 - Dining Room



Dimensions: 13'2" x 8'1"
Area: 107 sq. ft
Counted as living area: Yes

Heated: Yes
Finished: Yes
Enclosed: Yes
Contiguous: Yes
Permitted: Yes
Wet space: No
Addition: No
Conversion: No

5 Floor 1 - Porch



Dimensions: 5'9" x 5'10"
Area: 33 sq. ft
Counted as living area: No

Heated: No
Finished: No
Enclosed: No
Contiguous: Yes
Permitted: Yes
Wet space: No
Addition: No
Conversion: No

6 Floor 1 - Living Room



Dimensions: 16'11" x 12'5"
Area: 211 sq. ft
Counted as living area: Yes

Heated: Yes
Finished: Yes
Enclosed: Yes
Contiguous: Yes
Permitted: Yes
Wet space: No
Addition: No
Conversion: No

7 Floor 1 - Garage



Dimensions: 10'8" x 20'9"
Area: 222 sq. ft
Counted as living area: No

Heated: No
Finished: Yes
Enclosed: Yes
Contiguous: Yes
Permitted: Yes
Wet space: No
Addition: No
Conversion: No

8 Floor 1 - Patio



Dimensions: 17'3" x 5'8"
Area: 102 sq. ft
Counted as living area: No

Heated: No
Finished: No
Enclosed: No
Contiguous: Yes
Permitted: Yes
Wet space: No
Addition: No
Conversion: No

9 Floor 2 - W.I.C.



Dimensions: 5'1" x 3'11"
Area: 20 sq. ft
Counted as living area: Yes

Heated: Yes
Finished: Yes
Enclosed: Yes
Contiguous: Yes
Permitted: Yes
Wet space: No
Addition: No
Conversion: No

10 Floor 2 - Hall



Dimensions: 7'2" x 16'7"
Area: 125 sq. ft
Counted as living area: Yes

Heated: Yes
Finished: Yes
Enclosed: Yes
Contiguous: Yes
Permitted: Yes
Wet space: No
Addition: No
Conversion: No

11 Floor 2 - Hall



Dimensions: 9'6" x 11'2"
Area: 81 sq. ft
Counted as living area: Yes

Heated: Yes
Finished: Yes
Enclosed: Yes
Contiguous: Yes
Permitted: Yes
Wet space: No
Addition: No
Conversion: No

12 Floor 2 - Bath



Dimensions: 9'5" x 4'11"
Area: 47 sq. ft
Counted as living area: Yes

Heated: Yes
Finished: Yes
Enclosed: Yes
Contiguous: Yes
Permitted: Yes
Wet space: Yes
Addition: No
Conversion: No

13 Floor 2 - Bedroom



Dimensions: 10'11" x 10'5"
Area: 112 sq. ft
Counted as living area: Yes

Heated: Yes
Finished: Yes
Enclosed: Yes
Contiguous: Yes
Permitted: Yes
Wet space: No
Addition: No
Conversion: No

14 Floor 2 - Primary Bedroom



Dimensions: 14'6" x 14'9"
Area: 215 sq. ft
Counted as living area: Yes

Heated: Yes
Finished: Yes
Enclosed: Yes
Contiguous: Yes
Permitted: Yes
Wet space: No
Addition: No
Conversion: No

15 Floor 2 - Bedroom



Dimensions: 10'8" x 18'8"
Area: 149 sq. ft
Counted as living area: Yes

Heated: Yes
Finished: Yes
Enclosed: Yes
Contiguous: Yes
Permitted: Yes
Wet space: No
Addition: No
Conversion: No

16 Floor 2 - Bath



Dimensions: 9'5" x 11'0"
Area: 85 sq. ft
Counted as living area: Yes

Heated: Yes
Finished: Yes
Enclosed: Yes
Contiguous: Yes
Permitted: Yes
Wet space: Yes
Addition: No
Conversion: No