

# 508 Glosson Rd,Raleigh,NC,US

Gross Living Area: 1393 sq. ft

## Level 1

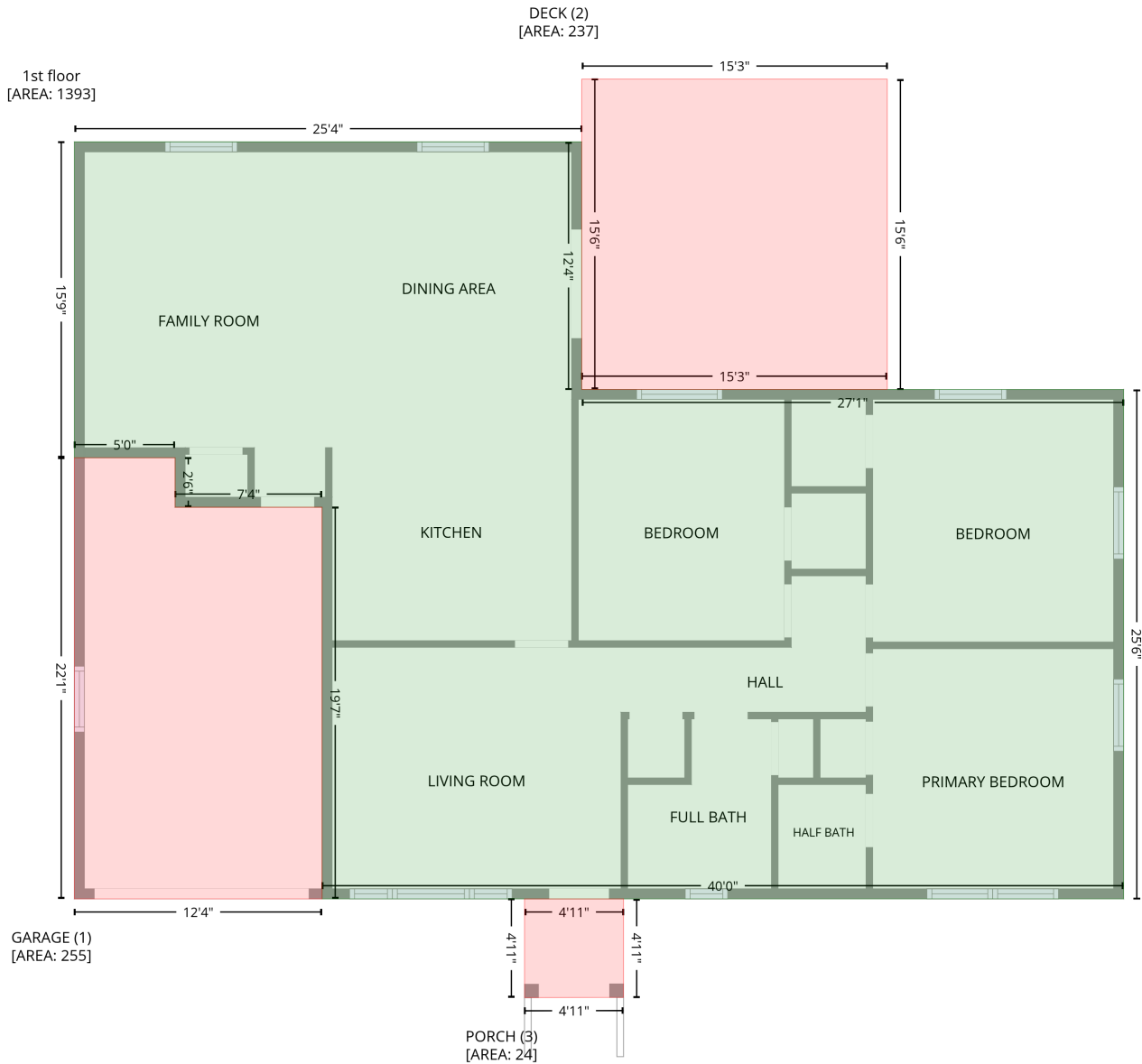

Space	Area (sq. ft)	Calculation
1st floor (Living area)	1393	Coordinate Polygon Area Algorithm using inches $-((342.9 + 342.9) * (61.7 - 210.2) + (342.9 + 667.7) * (210.2 - 210.2) + (667.7 + 667.7) * (210.2 - 515.8) + (667.7 + 187.4) * (515.8 - 515.8) + (187.4 + 187.4) * (515.8 - 280.9) + (187.4 + 99.3) * (280.9 - 280.9) + (99.3 + 99.3) * (280.9 - 251.2) + (99.3 + 38.9) * (251.2 - 251.2) + (38.9 + 38.9) * (251.2 - 61.7) + (38.9 + 342.9) * (61.7 - 61.7)) * 0.5 * 0.00694$
GARAGE (Non-living area)	255	$-((99.3 + 99.3) * (251.2 - 280.9) + (99.3 + 187.4) * (280.9 - 280.9) + (187.4 + 187.4) * (280.9 - 515.8) + (187.4 + 38.9) * (515.8 - 515.8) + (38.9 + 38.9) * (515.8 - 251.2) + (38.9 + 99.3) * (251.2 - 251.2)) * 0.5 * 0.00694$

# 508 Glosson Rd,Raleigh,NC,US

Gross Living Area: 1393 sq. ft

## Level 1

Space	Area (sq. ft)	Calculation <small>Coordinate Polygon Area Algorithm using inches</small>
DECK (Non-living area)	237	$-\left((526.1 + 526.1) * (24.1 - 210.2) + (526.1 + 342.9) * (210.2 - 210.2) + (342.9 + 342.9) * (210.2 - 24.1) + (342.9 + 526.1) * (24.1 - 24.1)\right) * 0.5 * 0.00694$
PORCH (Non-living area)	24	$-\left((368 + 368) * (515.8 - 574.9) + (368 + 308.7) * (574.9 - 575.1) + (308.7 + 308.7) * (575.1 - 515.8) + (308.7 + 368) * (515.8 - 515.8)\right) * 0.5 * 0.00694$