

Home data report

2151 Tate Ave, Fort Lupton, CO, US

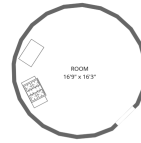

Total Area: 1349 sq. ft

Basement: 0 sq. ft, 1st Floor: 1349 sq. ft

Excluded: Garage 2165 sq. ft, Utility 26 sq. ft, Patio 195 sq. ft, Walls: 213 sq. ft

Property summary



2
Floors

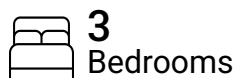

3
Bedrooms



2
Bathrooms



2
Garages

Home data report

2151 Tate Ave, Fort Lupton, CO, US

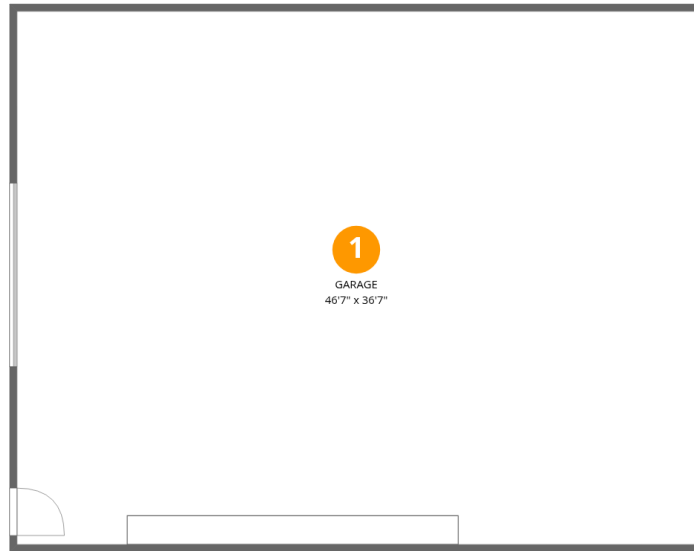

Room dimensions

Floor 1 Below grade

Total: 0sqft

Excluded: 1707sqft

#		Dimensions	sqft	Counted as living area
1	Garage	46'7" x 36'7"	1707 sq. ft	No

Home data report

2151 Tate Ave, Fort Lupton, CO, US

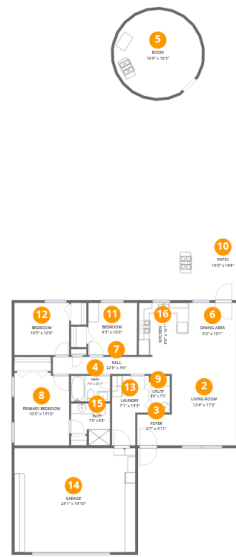

Room dimensions

Floor 2

Total: 1349sqft

Excluded: 679sqft

#		Dimensions	sqft	Counted as living area
2	Living Room	12'4" x 17'2"	212 sq. ft	Yes
3	Foyer	6'7" x 5'11"	39 sq. ft	Yes
4	Bath	7'6" x 4'11"	37 sq. ft	Yes
5	Room	16'9" x 16'3"	221 sq. ft	Yes
6	Dining Area	9'2" x 10'1"	92 sq. ft	Yes
7	Hall	22'8" x 3'6"	75 sq. ft	Yes
8	Primary Bedroom	10'5" x 13'10"	143 sq. ft	Yes
9	Utility	3'8" x 7'0"	26 sq. ft	No
10	Patio	16'0" x 14'8"	195 sq. ft	No
11	Bedroom	9'3" x 10'0"	93 sq. ft	Yes
12	Bedroom	10'5" x 10'0"	104 sq. ft	Yes

Home data report

2151 Tate Ave, Fort Lupton, CO, US

#		Dimensions	sqft	Counted as living area
13	Laundry	7'1" x 13'3"	78 sq. ft	Yes
14	Garage	23'1" x 19'10"	458 sq. ft	No
15	Bath	7'6" x 8'0"	53 sq. ft	Yes
16	Kitchen	9'6" x 10'1"	95 sq. ft	Yes

1 Floor 1 - Garage



Dimensions: 46'7" x 36'7"
Area: 1707 sq. ft
Counted as living area: No

Heated: No
Finished: No
Enclosed: Yes
Contiguous: Yes
Permitted: Yes
Wet space: No
Addition: No
Conversion: No

2 Floor 2 - Living Room



Dimensions: 12'4" x 17'2"
Area: 212 sq. ft
Counted as living area: Yes

Heated: Yes
Finished: Yes
Enclosed: Yes
Contiguous: Yes
Permitted: Yes
Wet space: No
Addition: No
Conversion: No

3 Floor 2 - Foyer



Dimensions: 6'7" x 5'11"
Area: 39 sq. ft
Counted as living area: Yes

Heated: Yes
Finished: Yes
Enclosed: Yes
Contiguous: Yes
Permitted: Yes
Wet space: No
Addition: No
Conversion: No

4 Floor 2 - Bath



Dimensions: 7'6" x 4'11"
Area: 37 sq. ft
Counted as living area: Yes

Heated: Yes
Finished: Yes
Enclosed: Yes
Contiguous: Yes
Permitted: Yes
Wet space: Yes
Addition: No
Conversion: No

5 Floor 2 - Room



Dimensions: 16'9" x 16'3"
Area: 221 sq. ft
Counted as living area: Yes

Heated: Yes
Finished: Yes
Enclosed: Yes
Contiguous: Yes
Permitted: Yes
Wet space: No
Addition: No
Conversion: No

6 Floor 2 - Dining Area



Dimensions: 9'2" x 10'1"
Area: 92 sq. ft
Counted as living area: Yes

Heated: Yes
Finished: Yes
Enclosed: Yes
Contiguous: Yes
Permitted: Yes
Wet space: No
Addition: No
Conversion: No

7 Floor 2 - Hall



Dimensions: 22'8" x 3'6"
Area: 75 sq. ft
Counted as living area: Yes

Heated: Yes
Finished: Yes
Enclosed: Yes
Contiguous: Yes
Permitted: Yes
Wet space: No
Addition: No
Conversion: No

8 Floor 2 - Primary Bedroom



Dimensions: 10'5" x 13'10"
Area: 143 sq. ft
Counted as living area: Yes

Heated: Yes
Finished: Yes
Enclosed: Yes
Contiguous: Yes
Permitted: Yes
Wet space: No
Addition: No
Conversion: No

9 Floor 2 - Utility



Dimensions: 3'8" x 7'0"
Area: 26 sq. ft
Counted as living area: No

Heated: Yes
Finished: No
Enclosed: Yes
Contiguous: Yes
Permitted: Yes
Wet space: No
Addition: No
Conversion: No

10 Floor 2 - Patio



Dimensions: 16'0" x 14'8"
Area: 195 sq. ft
Counted as living area: No

Heated: No
Finished: No
Enclosed: No
Contiguous: Yes
Permitted: Yes
Wet space: No
Addition: No
Conversion: No

11 Floor 2 - Bedroom



Dimensions: 9'3" x 10'0"
Area: 93 sq. ft
Counted as living area: Yes

Heated: Yes
Finished: Yes
Enclosed: Yes
Contiguous: Yes
Permitted: Yes
Wet space: No
Addition: No
Conversion: No

12 Floor 2 - Bedroom



Dimensions: 10'5" x 10'0"
Area: 104 sq. ft
Counted as living area: Yes

Heated: Yes
Finished: Yes
Enclosed: Yes
Contiguous: Yes
Permitted: Yes
Wet space: No
Addition: No
Conversion: No

13 Floor 2 - Laundry



Dimensions: 7'1" x 13'3"
Area: 78 sq. ft
Counted as living area: Yes

Heated: Yes
Finished: Yes
Enclosed: Yes
Contiguous: Yes
Permitted: Yes
Wet space: No
Addition: No
Conversion: No

14 Floor 2 - Garage



Dimensions: 23'1" x 19'10"
Area: 458 sq. ft
Counted as living area: No

Heated: No
Finished: No
Enclosed: Yes
Contiguous: Yes
Permitted: Yes
Wet space: No
Addition: No
Conversion: No

15 Floor 2 - Bath



Dimensions: 7'6" x 8'0"
Area: 53 sq. ft
Counted as living area: Yes

Heated: Yes
Finished: Yes
Enclosed: Yes
Contiguous: Yes
Permitted: Yes
Wet space: Yes
Addition: No
Conversion: No

16 Floor 2 - Kitchen



Dimensions: 9'6" x 10'1"
Area: 95 sq. ft
Counted as living area: Yes

Heated: Yes
Finished: Yes
Enclosed: Yes
Contiguous: Yes
Permitted: Yes
Wet space: No
Addition: No
Conversion: No