

PHOTO OF PROPERTY



LOCATED AT
19538 158th PINE
Woodinville, WA 98072

FOR
N/A

OPINION OF VALUE
N/A

AS OF
09/08/2025

BY
Adrian J. Weaver
Northwest Express Appraisal, LLC

206-229-8180
nweappraisal@gmail.com

Subject Photo Page

Borrower	N/A					
Property Address	19538 158th PI NE					
City	Woodinville	County	King	State	WA	Zip Code 98072
Lender/Client	N/A					



Subject Front

19538 158th PI NE
Sales Price
Gross Living Area 2,753



Subject Rear



Subject Street

Subject Photos [6 Digital Photos]

Borrower	N/A					
Property Address	19538 158th PI NE					
City	Woodinville	County	King	State	WA	Zip Code 98072
Lender/Client	N/A					



Subject Alternative View



Subject Alternative View



Uncovered Deck

Building Sketch (Page - 1)

Borrower	N/A				
Property Address	19538 158th PI NE				
City	Woodinville	County	King	State	WA Zip Code 98072
Lender/Client	N/A				

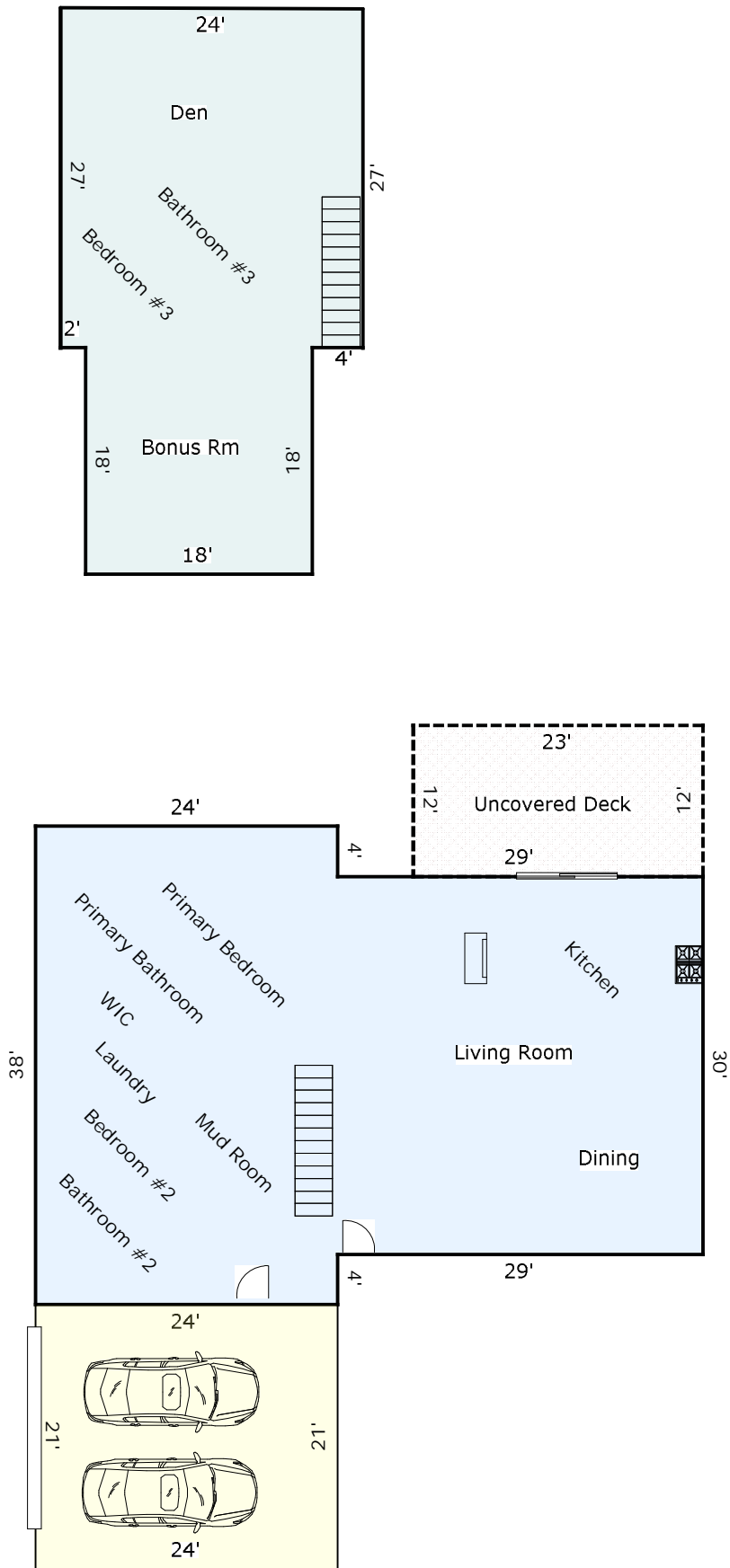

TOTAL Sketch by a la mode

Building Sketch (Page - 2)

Borrower	N/A					
Property Address	19538 158th Pl NE					
City	Woodinville	County	King	State	WA	Zip Code 98072
Lender/Client	N/A					

Living Area		Calculation Details	
First Floor	1782 Sq ft	$30 \times 29 = 870$ $24 \times 38 = 912$	
Second Floor	971 Sq ft	$18 \times 18 = 324$ $24 \times 27 = 647$ $0 \times 24 \times 0 = 1$	
Total Living Area (Rounded):		2753 Sq ft	
Non-living Area			
2 Car Attached	504 Sq ft	$24 \times 21 = 504$	
Uncovered Deck	276 Sq ft	$23 \times 12 = 276$	

License



STATE OF WASHINGTON

DEPARTMENT OF LICENSING - BUSINESS AND PROFESSIONS DIVISION

THIS CERTIFIES THE PERSON OR BUSINESS NAMED BELOW IS AUTHORIZED AS A



WASHINGTON STATE DEPARTMENT OF
LICENSING

CERTIFIED RESIDENTIAL REAL ESTATE APPRAISER

ADRIAN JUWANN WEAVER

1702832

License Number

04/20/2009

Issue Date

04/19/2027

Expiration Date



Marcus J Glasper, Director

(R/4/23)