

1 Main Floor Plan
1/4" = 1'-0"
NORTH

General Notes

- PROVIDE 6" FROM F.O.S. TO DOOR ROUGH OPENING, TYPICAL UNLESS NOTED OTHERWISE (U.N.O.)
- PROVIDE SOLID BLOCKING AT ALL WALL ACCESSORIES, CASEWORK AND SHELVING, SEE BLOCKING SCHEDULE
- SEE BUILDING SECTIONS FOR EXTERIOR WALL ASSEMBLIES.
- ALL DIMENSIONS ARE TO THE FACE OF STUD (F.O.S.)
- ALL HEADERS TO BE (2) 2x10'S WITH SINGLE TOP PLATE OVER AND (2) JACK STUDS U.N.O.
- FIRE BLOCKING AT ALL PLUMBING PENETRATIONS.
- TREATED WALL SHEATHING AT ALL LOCATIONS WHERE SHEATHING CONTACTS CONCRETE FOUNDATION AND/OR WALL. ALSO PROVIDE TREATED SHEATHING AND/OR WALL FRAMING AT ALL LOCATIONS WITHIN 2' OF A HORIZONTAL CONCRETE SURFACE.
- DRYWALL SHALL BE TREATED WITH POLY-VINYL ACETATE (PVA) WITH A PERM RATING OF LESS THAN 1. 6-8 MILS./200 S.F. PER GALLON APPLIED BEFORE & AFTER TEXTURING WALL. 2ND COAT TO BE TINTED PVA PRIMER. PROVIDE 5/8" GMB AT CEILING.
- REFER TO ELECTRICAL PLAN FOR ALL SMOKE DETECTOR, THERMOSTAT AND EXHAUST FAN LOCATIONS. PROVIDE CARBON MONOXIDE DETECTOR OUTSIDE BEDROOMS.
- ALL CONSTRUCTION IS TO BE SHEATHED W/ STRUCTURAL SHEATHING (1/16" OSB) ATTACHED W/ 6d COMMON NAILS (6" NAIL SPACING AT EDGE OF PANEL AND 12" SPACING AT INTERMEDIATE SUPPORTS).
- TOP OF PLATE TO BE 10'-1/8" THROUGHOUT ENTIRE HOME.
- TYPICAL EXTERIOR WALL CONSTRUCTION SHALL BE 2x6 AT 16" O.C. W/ R-21 INSULATION. TYPICAL INTERIOR WALL CONSTRUCTION SHALL BE 2x4 AT 16" O.C. U.N.O.
- PROVIDE FURRED DOWN SOFFITS AND MECHANICAL CHASES AS REQUIRED IN THE FIELD TO ACCOMMODATE SUPPLY & RETURN DUCTWORK AND REGISTERS.
- SEE DETAIL 1/A4.1 FOR TYPICAL INTERIOR WINDOW TRIM DETAIL.

Legend

- NEW WALL CONSTRUCTION.
- ARCHED HEADER / BULKHEAD ABOVE

Keyed Notes:

SEE SHEET A2.2 FOR KEY NOTE LEGEND.

Area Summary:

MAIN FLOOR:	2,658 SQ. FT.
TOTAL FINISHED SQ. FT.	2,658 SQ. FT.
GARAGE:	871 SQ. FT.
FRONT PORCH (CONC.):	53 SQ. FT.
REAR PATIO (CONC.):	246 SQ. FT.

Partition Types

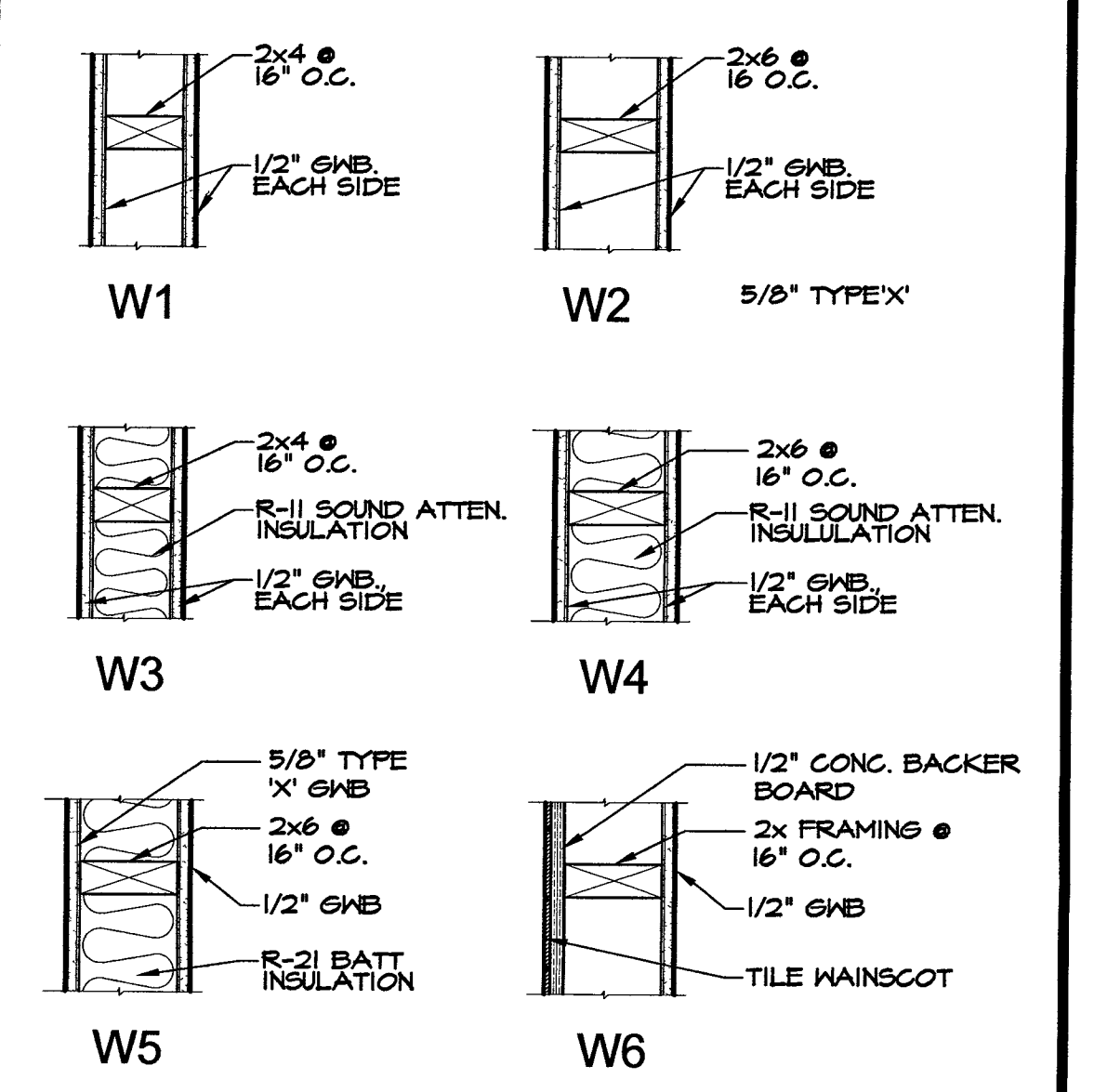

Blocking Schedule:

- KITCHEN CABINETS:
UPPER CABINETS - TOPS OF 2x8 BLOCKING AT 84" A.F.F.
LOWER CABINETS - TOPS OF 2x8 BLOCKING AT 34 1/2" A.F.F.
- VANITY CABINETS:
TOP OF 2x8 BLOCKING AT 35 1/2" A.F.F.
- TOWEL RACKS:
TOP OF 2x8 BLOCKING AT 48" A.F.F.
- STAIR BACKING:
TOP OF 2x8 BLOCKING AT 31 5/8" ABOVE TREAD NOSING
- THERMOSTAT:
CENTER OF 2x8 BLOCKING AT 51" A.F.F.

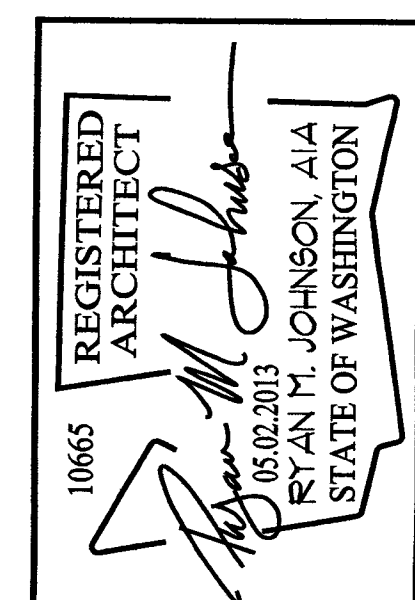

element
architecture
409 Coeur d'Alene Ave.
Suite C
Coeur d'Alene,
Idaho 83814
Phone (208) 651-7731
ryan@elementarchitecture.net
A LIMITED LIABILITY CORPORATION

Person Custom Home
2104 East Cherrytree Lane
Spokane, Washington

REV #	
REV #	
REV #	
REV #	
JOB #	13.02
DATE	05.02.2013

Main Floor Plan

A2.1