

Home data report

29 W Mechanic St, Shelbyville, IN, US



Total Area: 2034 sq. ft

1st Floor: 1377 sq. ft, 2nd Floor: 657 sq. ft

Excluded: Porch 254 sq. ft, Fireplace 16 sq. ft, Walls: 163 sq. ft

Property summary

 **2** Floors

 **2** Bedrooms

 **1** Bathrooms

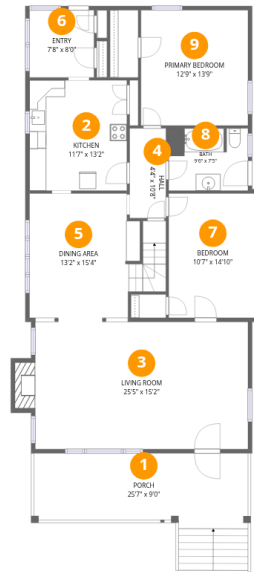

Room dimensions

Floor 1

Total: 1377 sqft

Excluded: 270 sqft

#		Dimensions	sqft	Counted as living area
1	Porch	25'7" x 9'0"	254 sq. ft	No
2	Kitchen	11'7" x 13'2"	152 sq. ft	Yes
3	Living Room	25'5" x 15'2"	399 sq. ft	Yes
4	Hall	4'4" x 10'8"	47 sq. ft	Yes
5	Dining Area	13'2" x 15'4"	216 sq. ft	Yes
6	Entry	7'8" x 8'0"	62 sq. ft	Yes
7	Bedroom	10'7" x 14'10"	157 sq. ft	Yes
8	Bath	9'6" x 7'5"	63 sq. ft	Yes
9	Primary Bedroom	12'9" x 13'9"	176 sq. ft	Yes

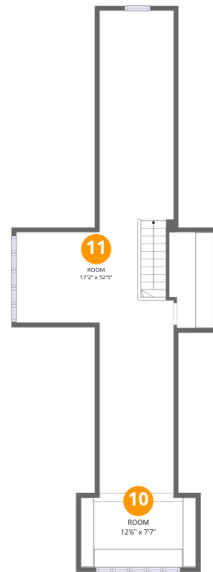

Room dimensions

Floor 2

Total:657sqft Excluded: 0sqft

#		Dimensions	sqft	Counted as living area
10	Room	12'6" x 7'7"	95 sq. ft	Yes
11	Room	17'2" x 52'5"	510 sq. ft	Yes

1 Floor 1 - Porch



Dimensions: 25'7" x 9'0"
Area: 254 sq. ft
Counted as living area: No

Heated: No
Finished: No
Enclosed: No
Contiguous: Yes
Permitted: Yes
Wet space: No
Addition: No
Conversion: No

2 Floor 1 - Kitchen



Dimensions: 11'7" x 13'2"
Area: 152 sq. ft
Counted as living area: Yes

Heated: Yes
Finished: Yes
Enclosed: Yes
Contiguous: Yes
Permitted: Yes
Wet space: No
Addition: No
Conversion: No

3 Floor 1 - Living Room



Dimensions: 25'5" x 15'2"
Area: 399 sq. ft
Counted as living area: Yes

Heated: Yes
Finished: Yes
Enclosed: Yes
Contiguous: Yes
Permitted: Yes
Wet space: No
Addition: No
Conversion: No

4 Floor 1 - Hall



Dimensions: 4'4" x 10'8"
Area: 47 sq. ft
Counted as living area: Yes

Heated: Yes
Finished: Yes
Enclosed: Yes
Contiguous: Yes
Permitted: Yes
Wet space: No
Addition: No
Conversion: No

5 Floor 1 - Dining Area



Dimensions: 13'2" x 15'4"
Area: 216 sq. ft
Counted as living area: Yes

Heated: Yes
Finished: Yes
Enclosed: Yes
Contiguous: Yes
Permitted: Yes
Wet space: No
Addition: No
Conversion: No

6 Floor 1 - Entry



Dimensions: 7'8" x 8'0"
Area: 62 sq. ft
Counted as living area: Yes

Heated: Yes
Finished: Yes
Enclosed: Yes
Contiguous: Yes
Permitted: Yes
Wet space: No
Addition: No
Conversion: No

7 Floor 1 - Bedroom



Dimensions: 10'7" x 14'10"
Area: 157 sq. ft
Counted as living area: Yes

Heated: Yes
Finished: Yes
Enclosed: Yes
Contiguous: Yes
Permitted: Yes
Wet space: No
Addition: No
Conversion: No

8 Floor 1 - Bath



Dimensions: 9'6" x 7'5"
Area: 63 sq. ft
Counted as living area: Yes

Heated: Yes
Finished: Yes
Enclosed: Yes
Contiguous: Yes
Permitted: Yes
Wet space: Yes
Addition: No
Conversion: No

9 Floor 1 - Primary Bedroom



Dimensions: 12'9" x 13'9"
Area: 176 sq. ft
Counted as living area: Yes

Heated: Yes
Finished: Yes
Enclosed: Yes
Contiguous: Yes
Permitted: Yes
Wet space: No
Addition: No
Conversion: No

10 Floor 2 - Room



Dimensions: 12'6" x 7'7"
Area: 95 sq. ft
Counted as living area: Yes

Heated: Yes
Finished: Yes
Enclosed: Yes
Contiguous: Yes
Permitted: Yes
Wet space: No
Addition: No
Conversion: No

11 Floor 2 - Room



Dimensions: 17'2" x 52'5"
Area: 510 sq. ft
Counted as living area: Yes

Heated: Yes
Finished: Yes
Enclosed: Yes
Contiguous: Yes
Permitted: Yes
Wet space: No
Addition: No
Conversion: No