

Home data report

16375 Sunfish Ln NW, Harvest, Limestone County, Alabama, United States, 35749



Total Area: 2357 sq. ft

1st Floor: 2357 sq. ft

Excluded: Garage 661 sq. ft, Screened porch 180 sq. ft, Porch 113 sq. ft, Patio 48 sq. ft

Property summary

 **1** Floors

 **4** Bedrooms

 **2** Bathrooms

Home data report

**16375 Sunfish Ln NW, Harvest, Limestone County, Alabama,
United States, 35749**



1
Half baths



2
Garages

Home data report

16375 Sunfish Ln NW, Harvest, Limestone County, Alabama, United States, 35749

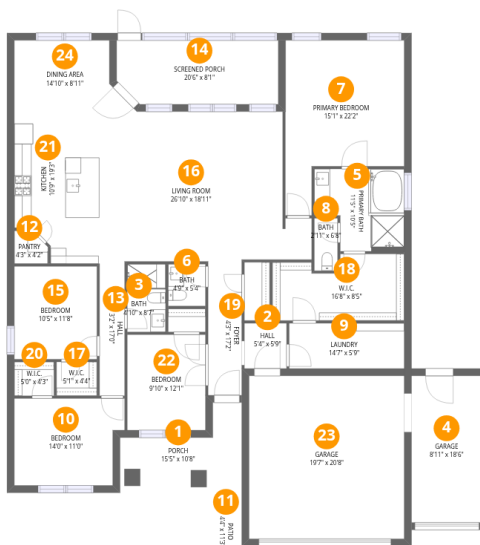

Room dimensions

Floor 1

Total:2357sqft

Excluded: 1002sqft

#		Dimensions	sqft	Counted as living area
1	Porch	15'5" x 10'8"	113 sq. ft	No
2	Hall	5'4" x 5'9"	31 sq. ft	Yes
3	Bath	4'10" x 8'7"	42 sq. ft	Yes
4	Garage	8'11" x 18'6"	165 sq. ft	No
5	Primary Bath	11'5" x 10'5"	104 sq. ft	Yes
6	Bath	4'9" x 5'4"	25 sq. ft	Yes
7	Primary Bedroom	15'1" x 22'2"	260 sq. ft	Yes
8	Bath	2'11" x 6'8"	20 sq. ft	Yes
9	Laundry	14'7" x 5'9"	84 sq. ft	Yes
10	Bedroom	14'0" x 11'0"	143 sq. ft	Yes
11	Patio	4'4" x 11'3"	48 sq. ft	No

Home data report

**16375 Sunfish Ln NW, Harvest, Limestone County, Alabama,
United States, 35749**

#		Dimensions	sqft	Counted as living area
12	Pantry	4'3" x 4'2"	16 sq. ft	Yes
13	Hall	3'2" x 17'0"	54 sq. ft	Yes
14	Screened Porch	20'6" x 8'1"	161 sq. ft	No
15	Bedroom	10'5" x 11'8"	123 sq. ft	Yes
16	Living Room	26'10" x 18'11"	456 sq. ft	Yes
17	W.I.C.	5'1" x 4'4"	22 sq. ft	Yes
18	W.I.C.	16'8" x 8'5"	127 sq. ft	Yes
19	Foyer	4'3" x 17'2"	73 sq. ft	Yes
20	W.I.C.	5'0" x 4'3"	22 sq. ft	Yes
21	Kitchen	10'9" x 19'3"	189 sq. ft	Yes
22	Bedroom	9'10" x 12'1"	120 sq. ft	Yes
23	Garage	19'7" x 20'8"	405 sq. ft	No
24	Dining Area	14'10" x 8'11"	115 sq. ft	Yes

16375 Sunfish Ln NW, Harvest, Limestone County, Alabama,
United States, 35749

1 Floor 1 - Porch



Dimensions: 15'5" x 10'8"
Area: 113 sq. ft
Counted as living area: No

Heated: No
Finished: No
Enclosed: No
Contiguous: Yes
Permitted: Yes
Wet space: No
Addition: No
Conversion: No

2 Floor 1 - Hall



Dimensions: 5'4" x 5'9"
Area: 31 sq. ft
Counted as living area: Yes

Heated: Yes
Finished: Yes
Enclosed: Yes
Contiguous: Yes
Permitted: Yes
Wet space: No
Addition: No
Conversion: No

3 Floor 1 - Bath



Dimensions: 4'10" x 8'7"
Area: 42 sq. ft
Counted as living area: Yes

Heated: Yes
Finished: Yes
Enclosed: Yes
Contiguous: Yes
Permitted: Yes
Wet space: Yes
Addition: No
Conversion: No

4 Floor 1 - Garage



Dimensions: 8'11" x 18'6"
Area: 165 sq. ft
Counted as living area: No

Heated: No
Finished: No
Enclosed: Yes
Contiguous: Yes
Permitted: Yes
Wet space: No
Addition: No
Conversion: No

5 Floor 1 - Primary Bath



Dimensions: 11'5" x 10'5"
Area: 104 sq. ft
Counted as living area: Yes

Heated: Yes
Finished: Yes
Enclosed: Yes
Contiguous: Yes
Permitted: Yes
Wet space: Yes
Addition: No
Conversion: No

6 Floor 1 - Bath



Dimensions: 4'9" x 5'4"
Area: 25 sq. ft
Counted as living area: Yes

Heated: Yes
Finished: Yes
Enclosed: Yes
Contiguous: Yes
Permitted: Yes
Wet space: Yes
Addition: No
Conversion: No

7 Floor 1 - Primary Bedroom



Dimensions: 15'1" x 22'2"
Area: 260 sq. ft
Counted as living area: Yes

Heated: Yes
Finished: Yes
Enclosed: Yes
Contiguous: Yes
Permitted: Yes
Wet space: No
Addition: No
Conversion: No

8 Floor 1 - Bath



Dimensions: 2'11" x 6'8"
Area: 20 sq. ft
Counted as living area: Yes

Heated: Yes
Finished: Yes
Enclosed: Yes
Contiguous: Yes
Permitted: Yes
Wet space: Yes
Addition: No
Conversion: No

9 Floor 1 - Laundry



Dimensions: 14'7" x 5'9"
Area: 84 sq. ft
Counted as living area: Yes

Heated: Yes
Finished: Yes
Enclosed: Yes
Contiguous: Yes
Permitted: Yes
Wet space: No
Addition: No
Conversion: No

10 Floor 1 - Bedroom



Dimensions: 14'0" x 11'0"
Area: 143 sq. ft
Counted as living area: Yes

Heated: Yes
Finished: Yes
Enclosed: Yes
Contiguous: Yes
Permitted: Yes
Wet space: No
Addition: No
Conversion: No

11 Floor 1 - Patio



Dimensions: 4'4" x 11'3"
Area: 48 sq. ft
Counted as living area: No

Heated: No
Finished: No
Enclosed: No
Contiguous: Yes
Permitted: Yes
Wet space: No
Addition: No
Conversion: No

16375 Sunfish Ln NW, Harvest, Limestone County, Alabama,
United States, 35749

12 Floor 1 - Pantry



Dimensions: 4'3" x 4'2"
Area: 16 sq. ft
Counted as living area: Yes

Heated: Yes
Finished: Yes
Enclosed: Yes
Contiguous: Yes
Permitted: Yes
Wet space: No
Addition: No
Conversion: No

13 Floor 1 - Hall



Dimensions: 3'2" x 17'0"
Area: 54 sq. ft
Counted as living area: Yes

Heated: Yes
Finished: Yes
Enclosed: Yes
Contiguous: Yes
Permitted: Yes
Wet space: No
Addition: No
Conversion: No

14 Floor 1 - Screened Porch



Dimensions: 20'6" x 8'1"
Area: 161 sq. ft
Counted as living area: No

Heated: No
Finished: No
Enclosed: No
Contiguous: Yes
Permitted: Yes
Wet space: No
Addition: No
Conversion: No

16375 Sunfish Ln NW, Harvest, Limestone County, Alabama,
United States, 35749

15 Floor 1 - Bedroom



Dimensions: 10'5" x 11'8"
Area: 123 sq. ft
Counted as living area: Yes

Heated: Yes
Finished: Yes
Enclosed: Yes
Contiguous: Yes
Permitted: Yes
Wet space: No
Addition: No
Conversion: No

16 Floor 1 - Living Room



Dimensions: 26'10" x 18'11"
Area: 456 sq. ft
Counted as living area: Yes

Heated: Yes
Finished: Yes
Enclosed: Yes
Contiguous: Yes
Permitted: Yes
Wet space: No
Addition: No
Conversion: No

17 Floor 1 - W.I.C.



Dimensions: 5'1" x 4'4"
Area: 22 sq. ft
Counted as living area: Yes

Heated: Yes
Finished: Yes
Enclosed: Yes
Contiguous: Yes
Permitted: Yes
Wet space: No
Addition: No
Conversion: No

16375 Sunfish Ln NW, Harvest, Limestone County, Alabama,
United States, 35749

18 Floor 1 - W.I.C.



Dimensions: 16'8" x 8'5"
Area: 127 sq. ft
Counted as living area: Yes

Heated: Yes
Finished: Yes
Enclosed: Yes
Contiguous: Yes
Permitted: Yes
Wet space: No
Addition: No
Conversion: No

19 Floor 1 - Foyer



Dimensions: 4'3" x 17'2"
Area: 73 sq. ft
Counted as living area: Yes

Heated: Yes
Finished: Yes
Enclosed: Yes
Contiguous: Yes
Permitted: Yes
Wet space: No
Addition: No
Conversion: No

20 Floor 1 - W.I.C.



Dimensions: 5'0" x 4'3"
Area: 22 sq. ft
Counted as living area: Yes

Heated: Yes
Finished: Yes
Enclosed: Yes
Contiguous: Yes
Permitted: Yes
Wet space: No
Addition: No
Conversion: No

16375 Sunfish Ln NW, Harvest, Limestone County, Alabama,
United States, 35749

21 Floor 1 - Kitchen



Dimensions: 10'9" x 19'3"
Area: 189 sq. ft
Counted as living area: Yes

Heated: Yes
Finished: Yes
Enclosed: Yes
Contiguous: Yes
Permitted: Yes
Wet space: No
Addition: No
Conversion: No

22 Floor 1 - Bedroom



Dimensions: 9'10" x 12'1"
Area: 120 sq. ft
Counted as living area: Yes

Heated: Yes
Finished: Yes
Enclosed: Yes
Contiguous: Yes
Permitted: Yes
Wet space: No
Addition: No
Conversion: No

23 Floor 1 - Garage



Dimensions: 19'7" x 20'8"
Area: 405 sq. ft
Counted as living area: No

Heated: No
Finished: No
Enclosed: Yes
Contiguous: Yes
Permitted: Yes
Wet space: No
Addition: No
Conversion: No

Home data report

16375 Sunfish Ln NW, Harvest, Limestone County, Alabama,
United States, 35749

24 Floor 1 - Dining Area



Dimensions: 14'10" x 8'11"
Area: 115 sq. ft
Counted as living area: Yes

Heated: Yes
Finished: Yes
Enclosed: Yes
Contiguous: Yes
Permitted: Yes
Wet space: No
Addition: No
Conversion: No