

Home data report

**57 Steele Park Private, Cummings, Castle Heights, Gloucester,
Ontario, Canada, K1J 0J2**



Total Area: 1197 sq. ft

Basement: 36 sq. ft, 1st Floor: 589 sq. ft, 2nd Floor: 572 sq. ft

Excluded: Balcony 89 sq. ft, Walls: 101 sq. ft

Property summary

 **3**
Floors

 **2**
Bedrooms

 **1**
Bathrooms

 **1**
Half baths

Home data report

57 Steele Park Private, Cummings, Castle Heights, Gloucester,
Ontario, Canada, K1J 0J2

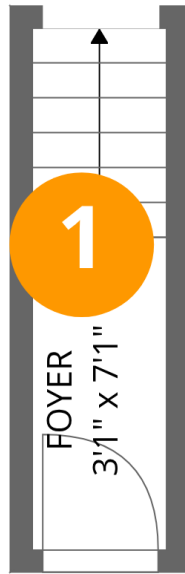

Room dimensions

Floor 1 Below grade

Total:36sqft

Excluded: 0sqft

#		Dimensions	sqft	Counted as living area
1	Foyer	3'1" x 7'1"	22 sq. ft	Yes

Home data report

57 Steele Park Private, Cummings, Castle Heights, Gloucester, Ontario, Canada, K1J 0J2



Room dimensions

Floor 2

Total:589sqft Excluded: 66sqft

#		Dimensions	sqft	Counted as living area
2	Kitchen	10'5" x 9'6"	99 sq. ft	Yes
3	Office	13'11" x 11'10"	165 sq. ft	Yes
4	Bath	3'1" x 6'10"	21 sq. ft	Yes
5	Dining Area	10'7" x 9'6"	100 sq. ft	Yes
6	Living Room	13'10" x 12'3"	169 sq. ft	Yes
7	Balcony	12'10" x 5'1"	65 sq. ft	No

Home data report

57 Steele Park Private, Cummings, Castle Heights, Gloucester, Ontario, Canada, K1J 0J2

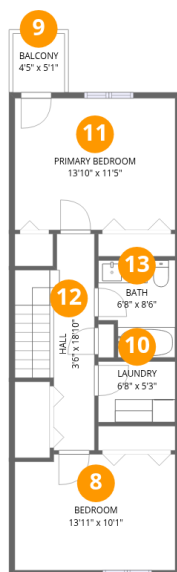

Room dimensions

Floor 3

Total:572sqft Excluded: 23sqft

#		Dimensions	sqft	Counted as living area
8	Bedroom	13'11" x 10'1"	140 sq. ft	Yes
9	Balcony	4'5" x 5'1"	23 sq. ft	No
10	Laundry	6'8" x 5'3"	35 sq. ft	Yes
11	Primary Bedroom	13'10" x 11'5"	158 sq. ft	Yes
12	Hall	3'6" x 18'10"	67 sq. ft	Yes
13	Bath	6'8" x 8'6"	57 sq. ft	Yes

57 Steele Park Private, Cummings, Castle Heights, Gloucester, Ontario, Canada, K1J 0J2

1 Floor 1 - Foyer

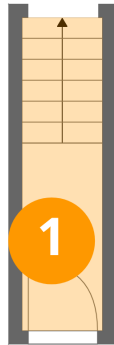

Dimensions: 3'1" x 7'1"
Area: 22 sq. ft
Counted as living area: Yes

Heated: Yes
Finished: Yes
Enclosed: Yes
Contiguous: Yes
Permitted: Yes
Wet space: No
Addition: No
Conversion: No

2 Floor 2 - Kitchen



Dimensions: 10'5" x 9'6"
Area: 99 sq. ft
Counted as living area: Yes

Heated: Yes
Finished: Yes
Enclosed: Yes
Contiguous: Yes
Permitted: Yes
Wet space: No
Addition: No
Conversion: No

57 Steele Park Private, Cummings, Castle Heights, Gloucester, Ontario, Canada, K1J 0J2

3 Floor 2 - Office



Dimensions: 13'11" x 11'10"

Area: 165 sq. ft

Counted as living area: Yes

Heated: Yes

Finished: Yes

Enclosed: Yes

Contiguous: Yes

Permitted: Yes

Wet space: No

Addition: No

Conversion: No

4 Floor 2 - Bath



Dimensions: 3'1" x 6'10"

Area: 21 sq. ft

Counted as living area: Yes

Heated: Yes

Finished: Yes

Enclosed: Yes

Contiguous: Yes

Permitted: Yes

Wet space: Yes

Addition: No

Conversion: No

5 Floor 2 - Dining Area



Dimensions: 10'7" x 9'6"

Area: 100 sq. ft

Counted as living area: Yes

Heated: Yes

Finished: Yes

Enclosed: Yes

Contiguous: Yes

Permitted: Yes

Wet space: No

Addition: No

Conversion: No

57 Steele Park Private, Cummings, Castle Heights, Gloucester, Ontario, Canada, K1J 0J2

6 Floor 2 - Living Room



Dimensions: 13'10" x 12'3"
Area: 169 sq. ft
Counted as living area: Yes

Heated: Yes
Finished: Yes
Enclosed: Yes
Contiguous: Yes
Permitted: Yes
Wet space: No
Addition: No
Conversion: No

7 Floor 2 - Balcony



Dimensions: 12'10" x 5'1"
Area: 65 sq. ft
Counted as living area: No

Heated: No
Finished: No
Enclosed: No
Contiguous: Yes
Permitted: Yes
Wet space: No
Addition: No
Conversion: No

8 Floor 3 - Bedroom



Dimensions: 13'11" x 10'1"
Area: 140 sq. ft
Counted as living area: Yes

Heated: Yes
Finished: Yes
Enclosed: Yes
Contiguous: Yes
Permitted: Yes
Wet space: No
Addition: No
Conversion: No

57 Steele Park Private, Cummings, Castle Heights, Gloucester, Ontario, Canada, K1J 0J2

9 Floor 3 - Balcony



Dimensions: 4'5" x 5'1"
Area: 23 sq. ft
Counted as living area: No

Heated: No
Finished: No
Enclosed: No
Contiguous: Yes
Permitted: Yes
Wet space: No
Addition: No
Conversion: No

10 Floor 3 - Laundry



Dimensions: 6'8" x 5'3"
Area: 35 sq. ft
Counted as living area: Yes

Heated: Yes
Finished: Yes
Enclosed: Yes
Contiguous: Yes
Permitted: Yes
Wet space: No
Addition: No
Conversion: No

11 Floor 3 - Primary Bedroom



Dimensions: 13'10" x 11'5"
Area: 158 sq. ft
Counted as living area: Yes

Heated: Yes
Finished: Yes
Enclosed: Yes
Contiguous: Yes
Permitted: Yes
Wet space: No
Addition: No
Conversion: No

57 Steele Park Private, Cummings, Castle Heights, Gloucester, Ontario, Canada, K1J 0J2

12 Floor 3 - Hall



Dimensions: 3'6" x 18'10"
Area: 67 sq. ft
Counted as living area: Yes

Heated: Yes
Finished: Yes
Enclosed: Yes
Contiguous: Yes
Permitted: Yes
Wet space: No
Addition: No
Conversion: No

13 Floor 3 - Bath



Dimensions: 6'8" x 8'6"
Area: 57 sq. ft
Counted as living area: Yes

Heated: Yes
Finished: Yes
Enclosed: Yes
Contiguous: Yes
Permitted: Yes
Wet space: Yes
Addition: No
Conversion: No