

1070 Cedar Cove Rd, Henderson, NC, US

Gross Living Area: 1639 sq. ft

Level 1

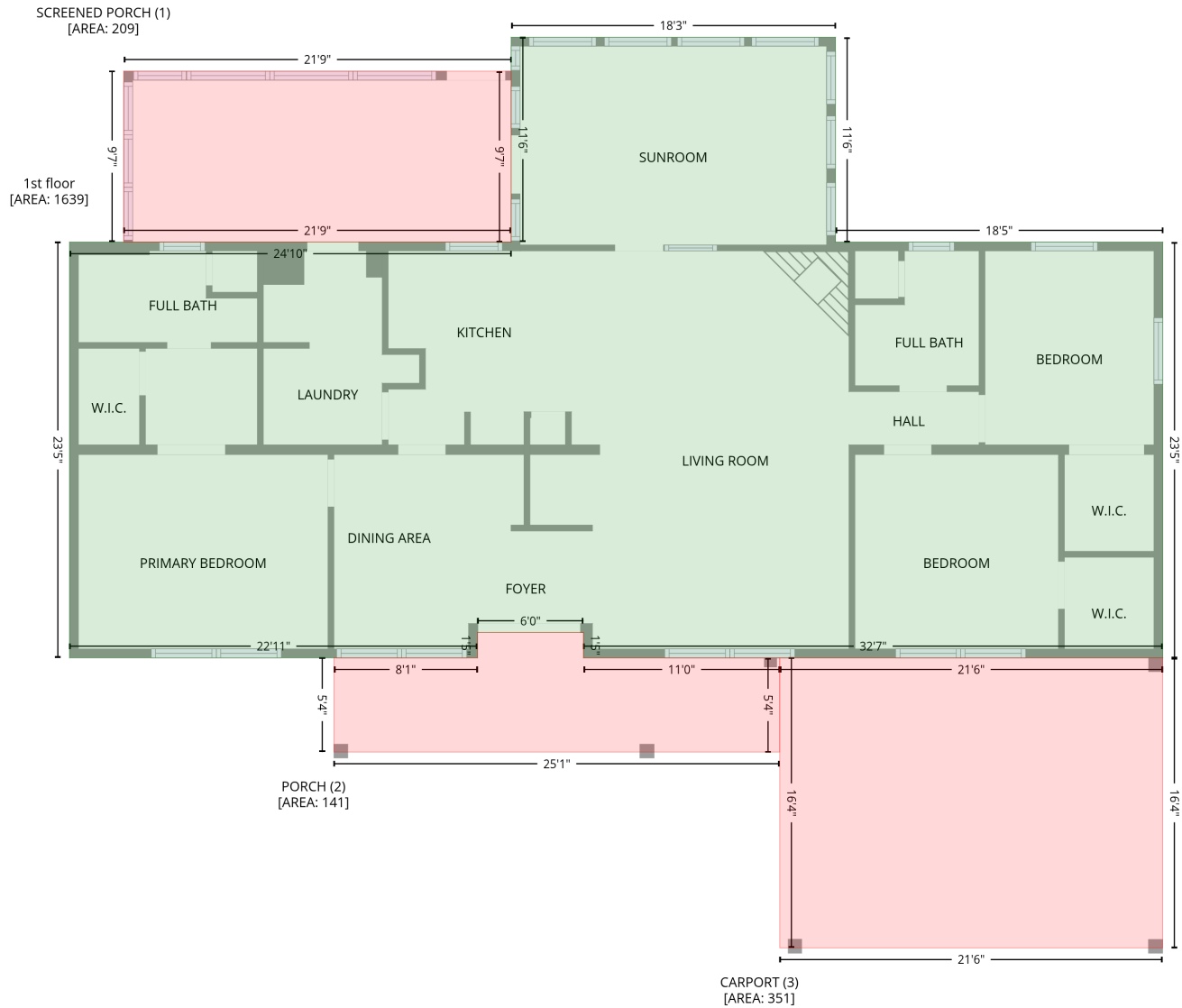

Space	Area (sq. ft)	Calculation
1st floor (Living area)	1639	Coordinate Polygon Area Algorithm using inches $-((478.6 + 478.6) * (52.3 - 190.5) + (478.6 + 699.5) * (190.5 - 190.5) + (699.5 + 699.5) * (190.5 - 471.1) + (699.5 + 308.6) * (471.1 - 471.1) + (308.6 + 308.6) * (471.1 - 453.9) + (308.6 + 237) * (453.9 - 453.9) + (237 + 237) * (453.9 - 471.1) + (237 + -38.3) * (471.1 - 471.1) + (-38.3 + -38.3) * (471.1 - 190.5) + (-38.3 + 259.7) * (190.5 - 190.5) + (259.7 + 259.7) * (190.5 - 52.3) + (259.7 + 478.6) * (52.3 - 52.3)) * 0.5 * 0.00694$
SCREENED PORCH (Non-living area)	209	$-((259.7 + 259.7) * (75.2 - 190.5) + (259.7 + -1.7) * (190.5 - 190.5) + (-1.7 + -1.7) * (190.5 - 75.2) + (-1.7 + 259.7) * (75.2 - 75.2)) * 0.5 * 0.00694$
PORCH (Non-living area)	141	$-((308.6 + 308.6) * (453.9 - 471.1) + (308.6 + 441) * (471.1 - 471.1) + (441 + 441) * (471.1 - 534.6) + (441 + 140.1) * (534.6 - 534.6) + (140.1 + 140.1) * (534.6 - 471.1) + (140.1 + 237) * (471.1 - 471.1) + (237 + 237) * (471.1 - 453.9) + (237 + 308.6) * (453.9 - 453.9)) * 0.5 * 0.00694$

1070 Cedar Cove Rd,Henderson,NC,US

Gross Living Area: 1639 sq. ft

Level 1

Space	Area (sq. ft)	Calculation <small>Coordinate Polygon Area Algorithm using inches</small>
CARPORT (Non-living area)	351	$-\left(\left(699.4 + 699.4\right) * \left(471.1 - 666.8\right) + \left(699.4 + 441\right) * \left(666.8 - 666.8\right) + \left(441 + 441\right) * \left(666.8 - 471.1\right) + \left(441 + 699.4\right) * \left(471.1 - 471.1\right)\right) * 0.5 * 0.00694$