

**9701 Julliard Drive (2844.0 sf HLA)**

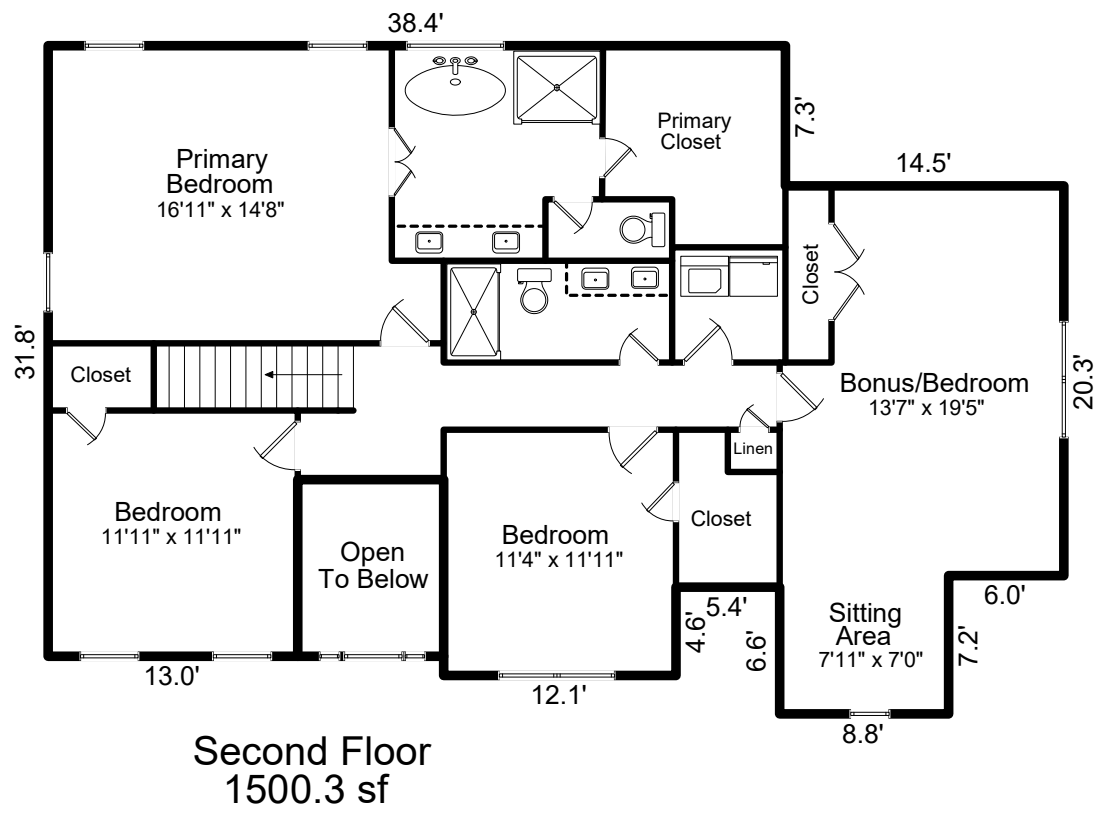
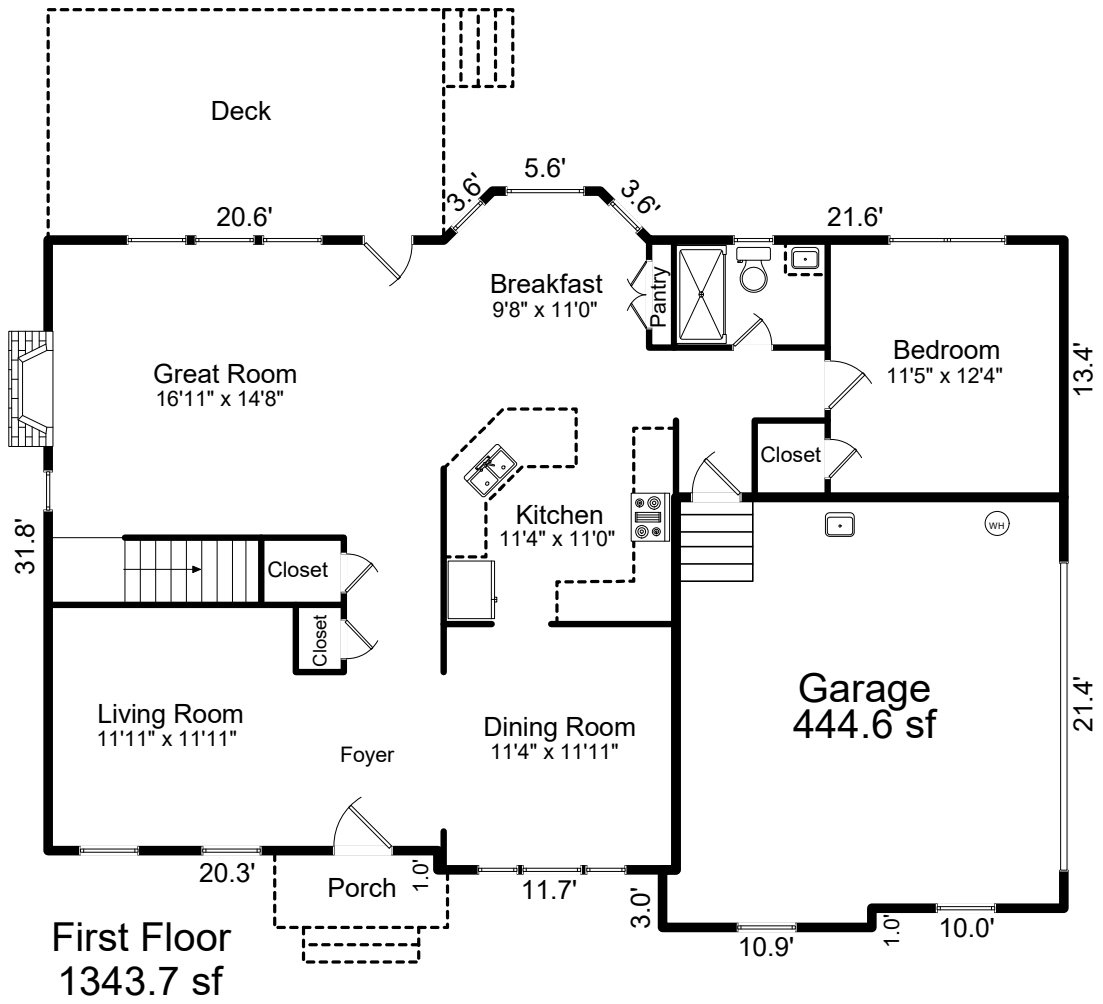

# SKETCH/AREA TABLE ADDENDUM

## SUBJECT INFO

File No.:	Parcel No.:		
Property Address:			
City:	County:	State:	ZipCode:
Owner:			
Client:	Client Address:		
Appraiser Name:	Inspection Date:		

## SKETCH

### Garage (GAR)

10.90 x 3.00 = 32.70  
 10.00 x 2.00 = 20.00  
 20.20 x 19.40 = 391.88

### First Floor (GLA1)

13.40 x 10.70 = 143.38  
 5.60 x 2.55 = 14.28  
 0.5 x 3.61 x 1.80 = 3.25  
 0.5 x 3.61 x 1.80 = 3.25  
 21.60 x 13.40 = 289.44  
 20.60 x 13.40 = 276.04  
 19.40 x 11.70 = 226.98  
 19.40 x 0.70 = 13.58  
 20.30 x 18.40 = 373.52

### Second Floor (GLA2)

32.80 x 12.10 = 396.88  
 22.60 x 20.60 = 465.56  
 28.20 x 5.70 = 160.74  
 13.00 x 9.20 = 119.60  
 6.60 x 0.30 = 1.98  
 20.30 x 14.50 = 294.35  
 8.50 x 7.20 = 61.20

### Porch (P/P)

8.50 x 4.00 = 34.00  
 3.00 x 0.50 = 1.50

### Deck (P/P)

20.60 x 12.00 = 247.20