

Sketch

Case Number: 20251209-1
 Address: 274 Powers Country Lane
 City / State: Bennett / NC
 Borrower:
 Lender or Client: Eric Andrews
 Prepared By: Laura Fuelleman

File Number: 202512
 Zip / County: 27208 /
 Address:
 Prepared By A...

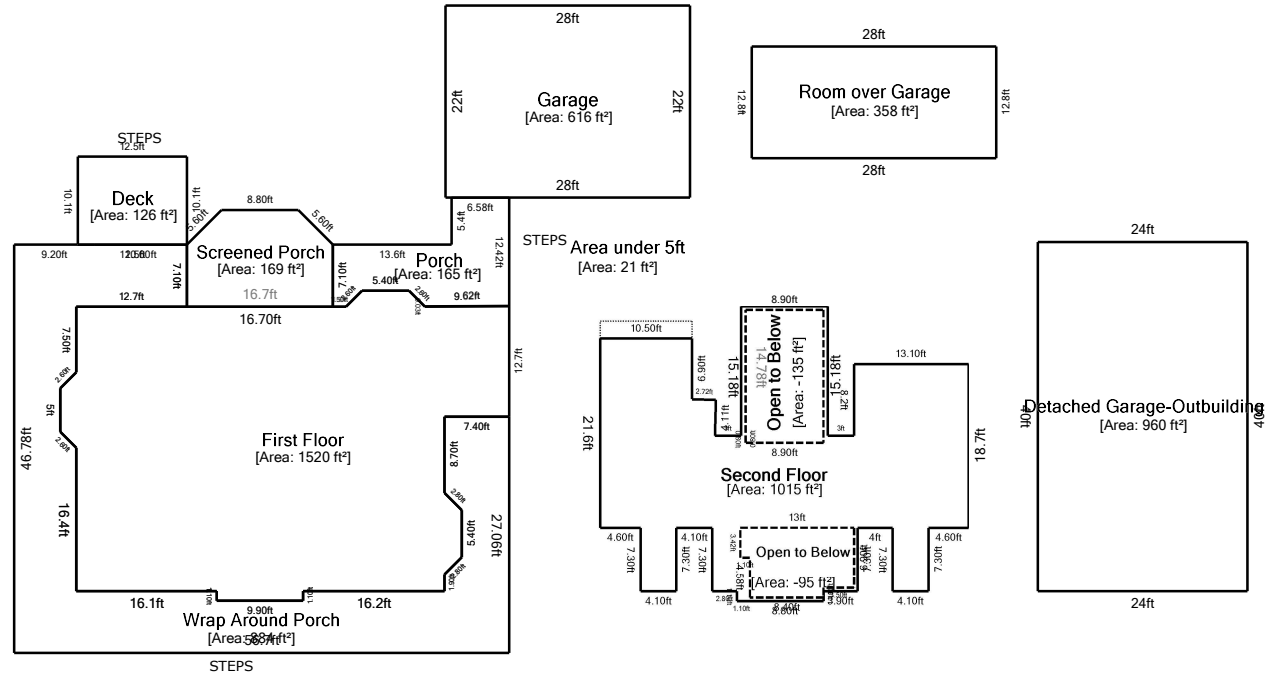

22 ft

Living Area		Nonliving Area	
Second Floor	1015.29 ft²	Wrap Around Porch	884.14 ft²
Open to Below	-135.07 ft²	Deck	126.25 ft²
First Floor	1519.90 ft²	Screened Porch	169.22 ft²
Open to Below	-95.11 ft²	Porch	165.11 ft²
		Garage	616.00 ft²
		Area under 5ft	21 ft²
		Room over Garage	358.4 ft²
		Detached Garage-Outbuilding	960 ft²
Total Living Area (rounded):		2305 ft² Total Non-Living Area (rounded):	3300 ft²

This document is designed to be a record of total finished square feet to aid the listing agent in gathering the square feet facts of the property. Measurements are obtained by physical observation of the property by a certified Home Measurement Specialist. Within every measurement project, some degree of art of opinion may be applied as well as rounding as set forth in the standards. Final finished square footage will be rounded to the nearest whole number with the goal of being within a 5% margin of error. Information deemed reliable, but not guaranteed.