

Home data report

24500 Deertrail Drive, Bear Valley Springs, Tehachapi, Kern County, California, United States, 93561



Total Area: 3510 sq. ft

1st Floor: 1119 sq. ft, 2nd Floor: 2391 sq. ft

Excluded: Garage 587 sq. ft, Balcony 369 sq. ft, Fireplace 13 sq. ft, Walls: 278 sq. ft

Property summary

 **2** Floors

 **4** Bedrooms

 **4** Bathrooms

 **1** Garages

Home data report

24500 Deertrail Drive, Bear Valley Springs, Tehachapi, Kern
County, California, United States, 93561

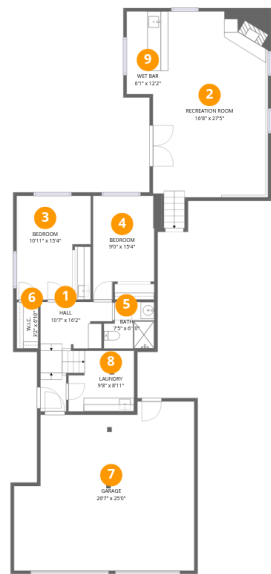

Room dimensions

Floor 1 Total:1119sqft Excluded: 587sqft

#		Dimensions	sqft	Counted as living area
1	Hall	10'7" x 16'2"	110 sq. ft	Yes
2	Recreation Room	16'8" x 27'5"	452 sq. ft	Yes
3	Bedroom	10'11" x 15'4"	146 sq. ft	Yes
4	Bedroom	9'0" x 15'4"	127 sq. ft	Yes
5	Bath	7'5" x 6'10"	46 sq. ft	Yes
6	W.I.C.	3'2" x 6'10"	22 sq. ft	Yes
7	Garage	26'7" x 25'0"	587 sq. ft	No
8	Laundry	9'8" x 8'11"	78 sq. ft	Yes
9	Wet Bar	6'1" x 12'2"	74 sq. ft	Yes

Home data report

24500 Deertrail Drive, Bear Valley Springs, Tehachapi, Kern
County, California, United States, 93561

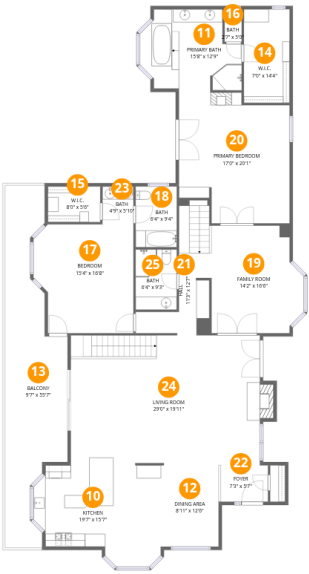

Room dimensions

Floor 2

Total:2391sqft Excluded: 382sqft

#		Dimensions	sqft	Counted as living area
10	Kitchen	19'7" x 15'7"	257 sq. ft	Yes
11	Primary Bath	15'8" x 12'9"	167 sq. ft	Yes
12	Dining Area	8'11" x 12'6"	113 sq. ft	Yes
13	Balcony	9'7" x 55'7"	369 sq. ft	No
14	W.I.C.	7'0" x 14'4"	101 sq. ft	Yes
15	W.I.C.	8'0" x 5'6"	44 sq. ft	Yes
16	Bath	2'7" x 5'0"	13 sq. ft	Yes
17	Bedroom	15'4" x 16'8"	237 sq. ft	Yes
18	Bath	6'4" x 9'4"	59 sq. ft	Yes
19	Family Room	14'2" x 16'6"	215 sq. ft	Yes
20	Primary Bedroom	17'0" x 20'1"	307 sq. ft	Yes

Home data report

24500 Deertrail Drive, Bear Valley Springs, Tehachapi, Kern
County, California, United States, 93561

#		Dimensions	sqft	Counted as living area
21	Hall	11'3" x 12'7"	114 sq. ft	Yes
22	Foyer	7'3" x 5'7"	41 sq. ft	Yes
23	Bath	4'9" x 5'10"	28 sq. ft	Yes
24	Living Room	29'0" x 19'11"	590 sq. ft	Yes
25	Bath	6'4" x 9'3"	58 sq. ft	Yes

24500 Deertrail Drive, Bear Valley Springs, Tehachapi, Kern
County, California, United States, 93561

1 Floor 1 - Hall



Dimensions: 10'7" x 16'2"
Area: 110 sq. ft
Counted as living area: Yes

Heated: Yes
Finished: Yes
Enclosed: Yes
Contiguous: Yes
Permitted: Yes
Wet space: No
Addition: No
Conversion: No

2 Floor 1 - Recreation Room



Dimensions: 16'8" x 27'5"
Area: 452 sq. ft
Counted as living area: Yes

Heated: Yes
Finished: Yes
Enclosed: Yes
Contiguous: Yes
Permitted: Yes
Wet space: No
Addition: No
Conversion: No

24500 Deertrail Drive, Bear Valley Springs, Tehachapi, Kern
County, California, United States, 93561

3 Floor 1 - Bedroom



Dimensions: 10'11" x 15'4"
Area: 146 sq. ft
Counted as living area: Yes

Heated: Yes
Finished: Yes
Enclosed: Yes
Contiguous: Yes
Permitted: Yes
Wet space: No
Addition: No
Conversion: No

4 Floor 1 - Bedroom



Dimensions: 9'0" x 15'4"
Area: 127 sq. ft
Counted as living area: Yes

Heated: Yes
Finished: Yes
Enclosed: Yes
Contiguous: Yes
Permitted: Yes
Wet space: No
Addition: No
Conversion: No

5 Floor 1 - Bath



Dimensions: 7'5" x 6'10"
Area: 46 sq. ft
Counted as living area: Yes

Heated: Yes
Finished: Yes
Enclosed: Yes
Contiguous: Yes
Permitted: Yes
Wet space: Yes
Addition: No
Conversion: No

24500 Deertrail Drive, Bear Valley Springs, Tehachapi, Kern
County, California, United States, 93561

6 Floor 1 - W.I.C.



Dimensions: 3'2" x 6'10"
Area: 22 sq. ft
Counted as living area: Yes

Heated: Yes
Finished: Yes
Enclosed: Yes
Contiguous: Yes
Permitted: Yes
Wet space: No
Addition: No
Conversion: No

7 Floor 1 - Garage



Dimensions: 26'7" x 25'0"
Area: 587 sq. ft
Counted as living area: No

Heated: No
Finished: No
Enclosed: Yes
Contiguous: Yes
Permitted: Yes
Wet space: No
Addition: No
Conversion: No

8 Floor 1 - Laundry



Dimensions: 9'8" x 8'11"
Area: 78 sq. ft
Counted as living area: Yes

Heated: Yes
Finished: Yes
Enclosed: Yes
Contiguous: Yes
Permitted: Yes
Wet space: No
Addition: No
Conversion: No

24500 Deertrail Drive, Bear Valley Springs, Tehachapi, Kern
County, California, United States, 93561

9 Floor 1 - Wet Bar



Dimensions: 6'1" x 12'2"
Area: 74 sq. ft
Counted as living area: Yes

Heated: Yes
Finished: Yes
Enclosed: Yes
Contiguous: Yes
Permitted: Yes
Wet space: No
Addition: No
Conversion: No

10 Floor 2 - Kitchen



Dimensions: 19'7" x 15'7"
Area: 257 sq. ft
Counted as living area: Yes

Heated: Yes
Finished: Yes
Enclosed: Yes
Contiguous: Yes
Permitted: Yes
Wet space: No
Addition: No
Conversion: No

11 Floor 2 - Primary Bath



Dimensions: 15'8" x 12'9"
Area: 167 sq. ft
Counted as living area: Yes

Heated: Yes
Finished: Yes
Enclosed: Yes
Contiguous: Yes
Permitted: Yes
Wet space: Yes
Addition: No
Conversion: No

24500 Deertrail Drive, Bear Valley Springs, Tehachapi, Kern
County, California, United States, 93561

12 Floor 2 - Dining Area



Dimensions: 8'11" x 12'6"
Area: 113 sq. ft
Counted as living area: Yes

Heated: Yes
Finished: Yes
Enclosed: Yes
Contiguous: Yes
Permitted: Yes
Wet space: No
Addition: No
Conversion: No

13 Floor 2 - Balcony



Dimensions: 9'7" x 55'7"
Area: 369 sq. ft
Counted as living area: No

Heated: No
Finished: No
Enclosed: No
Contiguous: Yes
Permitted: Yes
Wet space: No
Addition: No
Conversion: No

14 Floor 2 - W.I.C.



Dimensions: 7'0" x 14'4"
Area: 101 sq. ft
Counted as living area: Yes

Heated: Yes
Finished: Yes
Enclosed: Yes
Contiguous: Yes
Permitted: Yes
Wet space: No
Addition: No
Conversion: No

24500 Deertrail Drive, Bear Valley Springs, Tehachapi, Kern
County, California, United States, 93561

15 Floor 2 - W.I.C.



Dimensions: 8'0" x 5'6"
Area: 44 sq. ft
Counted as living area: Yes

Heated: Yes
Finished: Yes
Enclosed: Yes
Contiguous: Yes
Permitted: Yes
Wet space: No
Addition: No
Conversion: No

16 Floor 2 - Bath



Dimensions: 2'7" x 5'0"
Area: 13 sq. ft
Counted as living area: Yes

Heated: Yes
Finished: Yes
Enclosed: Yes
Contiguous: Yes
Permitted: Yes
Wet space: Yes
Addition: No
Conversion: No

17 Floor 2 - Bedroom



Dimensions: 15'4" x 16'8"
Area: 237 sq. ft
Counted as living area: Yes

Heated: Yes
Finished: Yes
Enclosed: Yes
Contiguous: Yes
Permitted: Yes
Wet space: No
Addition: No
Conversion: No

24500 Deertrail Drive, Bear Valley Springs, Tehachapi, Kern
County, California, United States, 93561

18 Floor 2 - Bath



Dimensions: 6'4" x 9'4"
Area: 59 sq. ft
Counted as living area: Yes

Heated: Yes
Finished: Yes
Enclosed: Yes
Contiguous: Yes
Permitted: Yes
Wet space: Yes
Addition: No
Conversion: No

19 Floor 2 - Family Room



Dimensions: 14'2" x 16'6"
Area: 215 sq. ft
Counted as living area: Yes

Heated: Yes
Finished: Yes
Enclosed: Yes
Contiguous: Yes
Permitted: Yes
Wet space: No
Addition: No
Conversion: No

20 Floor 2 - Primary Bedroom



Dimensions: 17'0" x 20'1"
Area: 307 sq. ft
Counted as living area: Yes

Heated: Yes
Finished: Yes
Enclosed: Yes
Contiguous: Yes
Permitted: Yes
Wet space: No
Addition: No
Conversion: No

24500 Deertrail Drive, Bear Valley Springs, Tehachapi, Kern
County, California, United States, 93561

21 Floor 2 - Hall



Dimensions: 11'3" x 12'7"
Area: 114 sq. ft
Counted as living area: Yes

Heated: Yes
Finished: Yes
Enclosed: Yes
Contiguous: Yes
Permitted: Yes
Wet space: No
Addition: No
Conversion: No

22 Floor 2 - Foyer



Dimensions: 7'3" x 5'7"
Area: 41 sq. ft
Counted as living area: Yes

Heated: Yes
Finished: Yes
Enclosed: Yes
Contiguous: Yes
Permitted: Yes
Wet space: No
Addition: No
Conversion: No

23 Floor 2 - Bath



Dimensions: 4'9" x 5'10"
Area: 28 sq. ft
Counted as living area: Yes

Heated: Yes
Finished: Yes
Enclosed: Yes
Contiguous: Yes
Permitted: Yes
Wet space: Yes
Addition: No
Conversion: No

24500 Deertrail Drive, Bear Valley Springs, Tehachapi, Kern
County, California, United States, 93561

24 Floor 2 - Living Room



Dimensions: 29'0" x 19'11"
Area: 590 sq. ft
Counted as living area: Yes

Heated: Yes
Finished: Yes
Enclosed: Yes
Contiguous: Yes
Permitted: Yes
Wet space: No
Addition: No
Conversion: No

25 Floor 2 - Bath



Dimensions: 6'4" x 9'3"
Area: 58 sq. ft
Counted as living area: Yes

Heated: Yes
Finished: Yes
Enclosed: Yes
Contiguous: Yes
Permitted: Yes
Wet space: Yes
Addition: No
Conversion: No