

**TOTAL: 3060 sq. ft**

Basement: 966 sq. ft, 1st floor: 1791 sq. ft, 2nd floor: 303 sq. ft  
 EXCLUDED AREAS: STORAGE: 222 sq. ft, PATIO: 273 sq. ft, GARAGE: 584 sq. ft,  
 PORCH: 364 sq. ft, DECK: 703 sq. ft, FIREPLACE: 10 sq. ft,  
 OPEN TO BELOW: 536 sq. ft, WALLS: 261 sq. ft





**TOTAL: 3060 sq. ft**

Basement: 966 sq. ft, 1st floor: 1791 sq. ft, 2nd floor: 303 sq. ft  
 EXCLUDED AREAS: STORAGE: 222 sq. ft, PATIO: 273 sq. ft, GARAGE: 584 sq. ft,  
 PORCH: 364 sq. ft, DECK: 703 sq. ft, FIREPLACE: 10 sq. ft,  
 OPEN TO BELOW: 536 sq. ft, WALLS: 261 sq. ft



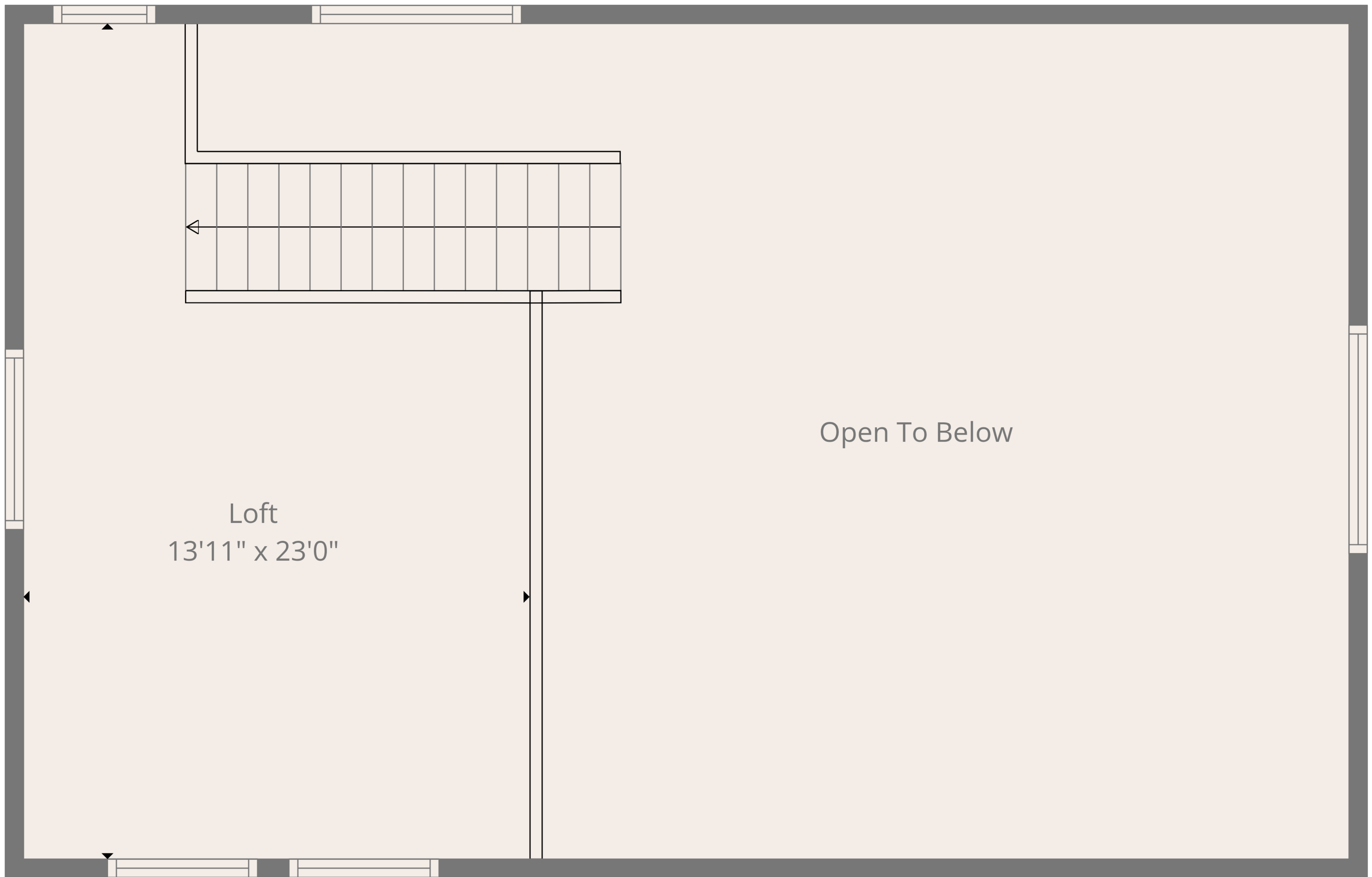

Loft  
13'11" x 23'0"

Open To Below

**TOTAL: 3060 sq. ft**

Basement: 966 sq. ft, 1st floor: 1791 sq. ft, 2nd floor: 303 sq. ft

EXCLUDED AREAS: STORAGE: 222 sq. ft, PATIO: 273 sq. ft, GARAGE: 584 sq. ft,

PORCH: 364 sq. ft, DECK: 703 sq. ft, FIREPLACE: 10 sq. ft,

OPEN TO BELOW: 536 sq. ft, WALLS: 261 sq. ft





**TOTAL: 3060 sq. ft**

Basement: 966 sq. ft, 1st floor: 1791 sq. ft, 2nd floor: 303 sq. ft  
 EXCLUDED AREAS: STORAGE: 222 sq. ft, PATIO: 273 sq. ft, GARAGE: 584 sq. ft,  
 PORCH: 364 sq. ft, DECK: 703 sq. ft, FIREPLACE: 10 sq. ft,  
 OPEN TO BELOW: 536 sq. ft, WALLS: 261 sq. ft

