

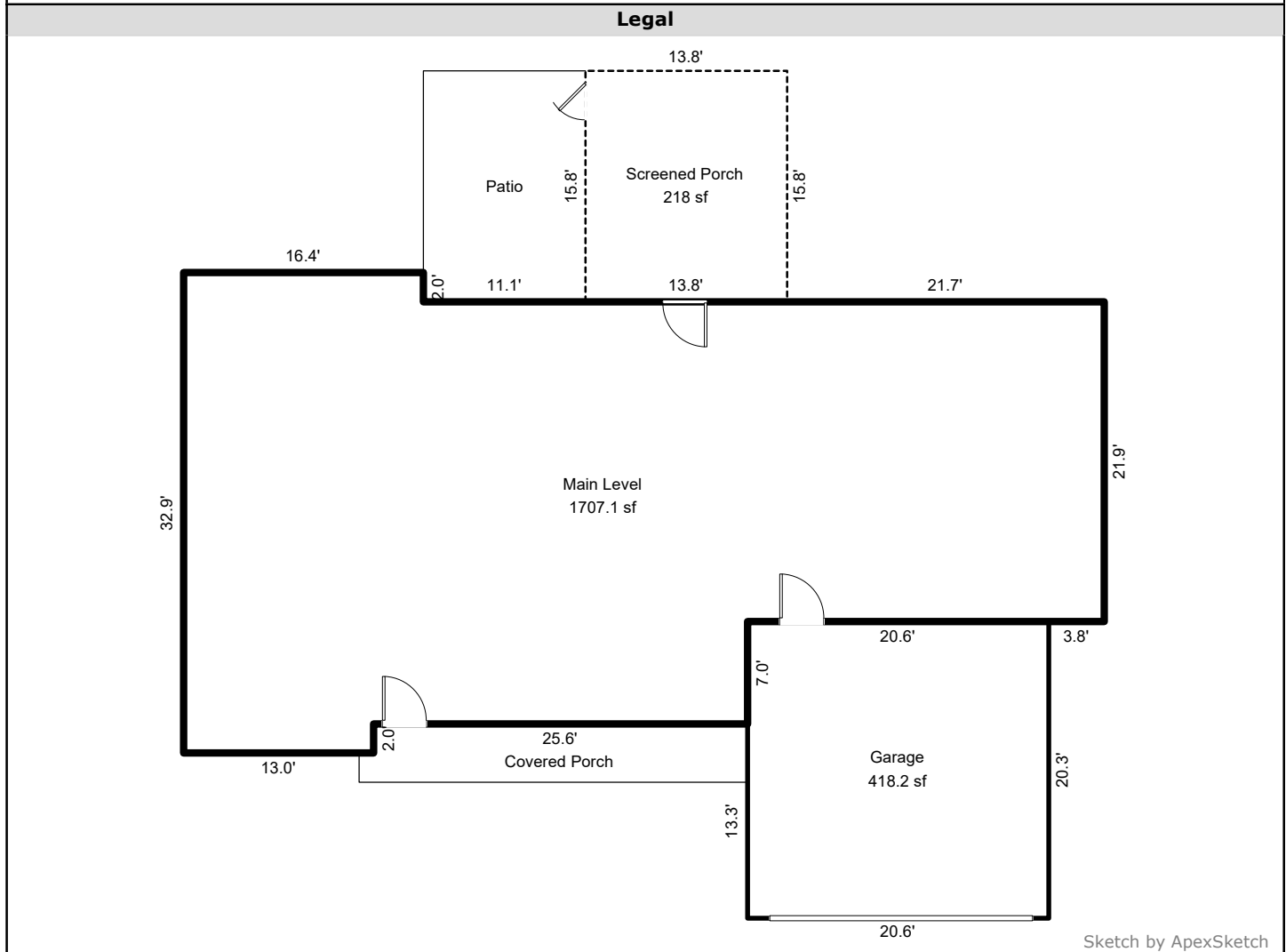

Property Measurements

Parcel				
Legal:	Parcel No.:			
Property Address: 520 Shoal Rd				
City: Lincolton	County: Lincoln	State: NC	ZipCode: 28092	
Owner:				
:				
Measurer: square Up Measuring		Inspection Date: 12/16/2025		



AREA CALCULATIONS SUMMARY						COMMENT TABLE 1	
Code	Description	Factor	Net Size	Perimeter	Net Totals	<p>For a more accurate measurement, measurements are based on the Official ANSI Z765-2021 Handbook and the current North Carolina Residential Square Footage Guideline approved by the American National Standards Institute (ANSI) and recognized by the North Carolina Real Estate Commission for single-family dwellings, townhouses and condos for both North and South Carolina. Measurements for marketing and informational purposes.</p> <ul style="list-style-type: none"> Doors, stairs and fireplace locations are approximate. Room locations are approximate. All measurements are rounded to the nearest tenth of an inch. 	
GLA1	Main Level	1.0	1707.1	191.8	1707.1		
GAR	Garage	1.0	418.2	81.8	418.2		
P/P	Screened Porch	1.0	218.0	59.2	218.0		
Net LIVABLE						cnt	1 (rounded)
							1,707
						COMMENT TABLE 2	COMMENT TABLE 3

Property Measurements

Parcel			
Legal:	Parcel No.:		
Property Address: 520 Shoal Rd			
City: Lincolton	County: Lincoln	State: NC	ZipCode: 28092
Owner:			
:			
Measurer: square Up Measuring		Inspection Date: 12/16/2025	
Legal			
Main Level (GLA1)			
32.88 x	13.00 =	427.38	
30.88 x	3.40 =	104.98	
46.60 x	21.88 =	1019.38	
22.20 x	7.00 =	155.40	
Total area:		1707.13	
Garage (GAR)			
20.60 x	13.30 =	273.98	
20.60 x	7.00 =	144.20	
Total area:		418.18	
Screened Porch (P/P)			
15.80 x	13.80 =	218.04	
Total area:		218.04	