

139 Queen St S
Hamilton, ON

Total Above Grade Exterior ft²
Approx Above Grade Exterior Area = 1015

Total Exterior ft²
Approx Exterior Area (basement included) = 1852



Ground Floor

(above grade)

Approx Interior Area = 900 ft²

Approx Exterior Area = 1015 ft²

Ceiling Height - 10' 3"
Kitchen Ceiling Height - 9' 5"

All room dimensions and floor areas must be considered approximate and are subject to independent verification.



139 Queen St S
Hamilton, ON

Total Above Grade Exterior ft²
Approx Above Grade Exterior Area = 1015

Total Exterior ft²
Approx Exterior Area (basement included) = 1852

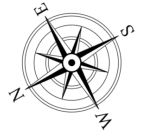
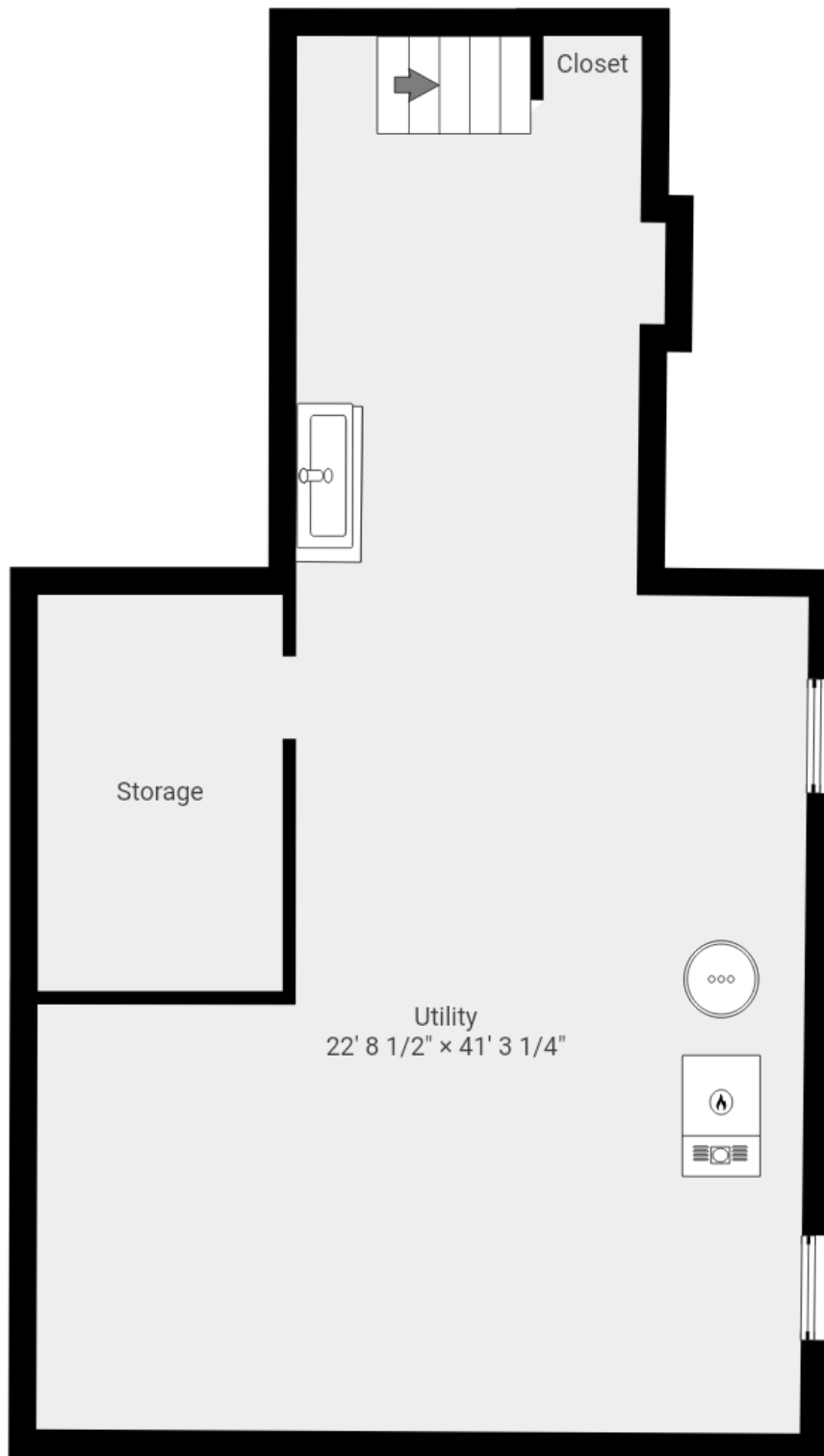

Basement

(below grade)

Approx Interior Area = 729 ft²

Approx Exterior Area = 837 ft²

Ceiling Height - 6' 9"

All room dimensions and floor areas must be considered approximate and are subject to independent verification.



Summary

Main Room Interior Measurements

Room Name	Imperial	Metric	Area
Ground Floor (above grade) - Approx Exterior ft² = 1015			
Living Room	15' 3" x 13' 5"	4.66m x 4.08m	190.91 ft ² / 17.74 m ²
Dining Room	15' 3" x 13' 3"	4.66m x 4.04m	202.65 ft ² / 18.83 m ²
Kitchen	10' 8" x 12' 6"	3.25m x 3.81m	133.20 ft ² / 12.37 m ²
Primary Bedroom	8' 11" x 9' 6"	2.72m x 2.91m	85.20 ft ² / 7.92 m ²
Bedroom 2	9' 1" x 8' 8"	2.76m x 2.65m	78.69 ft ² / 7.31 m ²
3pc bath	9' 0" x 8' 0"	2.74m x 2.45m	45.59 ft ² / 4.24 m ²
Entry	4' 5" x 2' 6"	1.35m x 0.77m	11.17 ft ² / 1.04 m ²
Pantry	4' 4" x 3' 4"	1.33m x 1.01m	14.49 ft ² / 1.35 m ²
Mudroom	4' 2" x 11' 9"	1.28m x 3.58m	49.34 ft ² / 4.58 m ²
Basement (below grade) - Approx Exterior ft² = 837			
Utility	22' 8" x 41' 3"	6.92m x 12.58m	628.83 ft ² / 58.42 m ²
Storage	7' 3" x 11' 9"	2.20m x 3.58m	84.72 ft ² / 7.87 m ²

Ceiling Heights

Main Floor (except Kitchen) - 10' 3"
Kitchen Ceiling Height - 9' 5"
Basement Ceiling Height - 6' 9"

