

Sketch

Case Number: 20260526-1 File Number: 202605
 Address: 737 Epps Clark Road
 City / State: Siler City / NC Zip / County: 27344 /
 Borrower:
 Lender or Client: Eric Andrews Address:
 Prepared By: Laura Fuelleman Prepared By A...

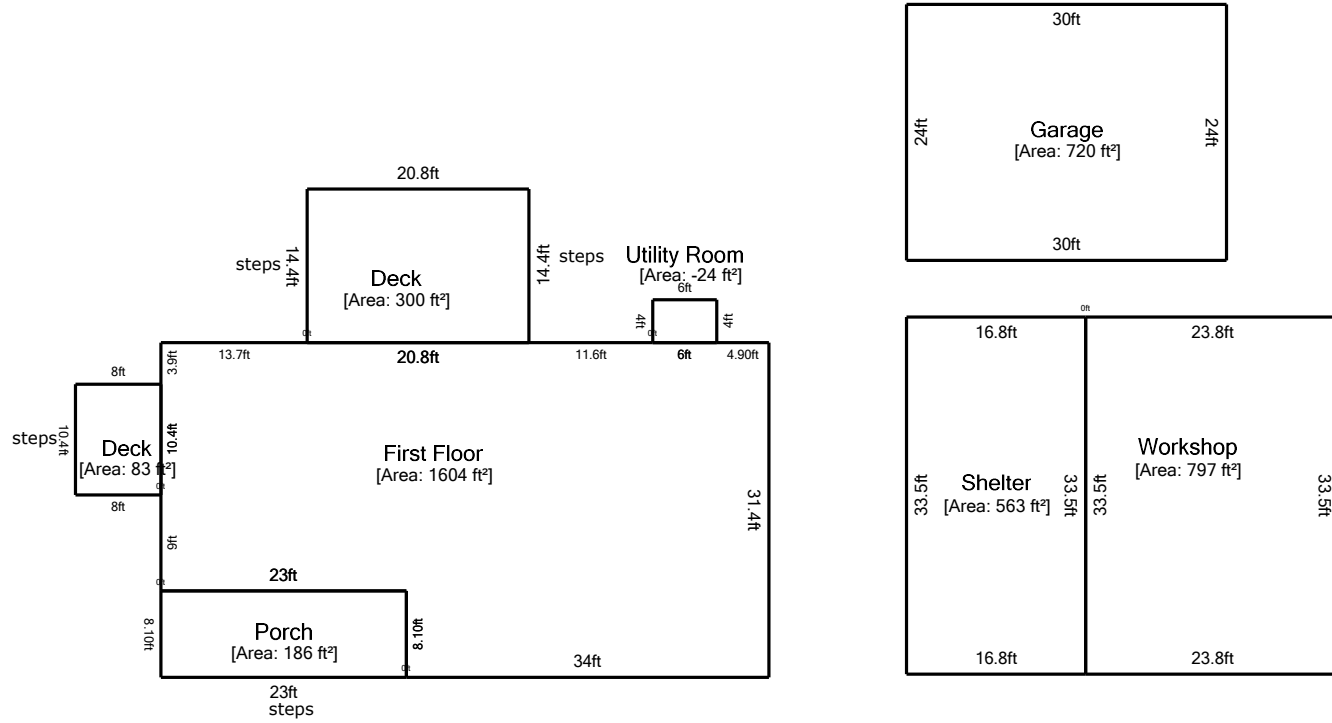

Living Area		Nonliving Area	
First Floor	1603.5 ft²	Deck	83.20 ft²
Utility Room	-24.00 ft²	Porch	186.30 ft²
		Deck	299.52 ft²
		Shelter	562.8 ft²
		Workshop	797.30 ft²
		Garage	720.00 ft²
Total Living Area (rounded):	1580 ft²	Total Non-Living Area (rounded):	2649 ft²

This document is designed to be a record of total finished square feet to aid the listing agent in gathering the square feet facts of the property. Measurements are obtained by physical observation of the property by a certified Home Measurement Specialist. Within every measurement project, some degree of art of opinion may be applied as well as rounding as set forth in the standards. Final finished square footage will be rounded to the nearest whole number with the goal of being within a 5% margin of error. Information deemed reliable, but not guaranteed.