

405 Ray Byrd Road, Lillington, Harnett County, North Carolina, United States, 27546

Gross Living Area: 1228 sq. ft

Level 1

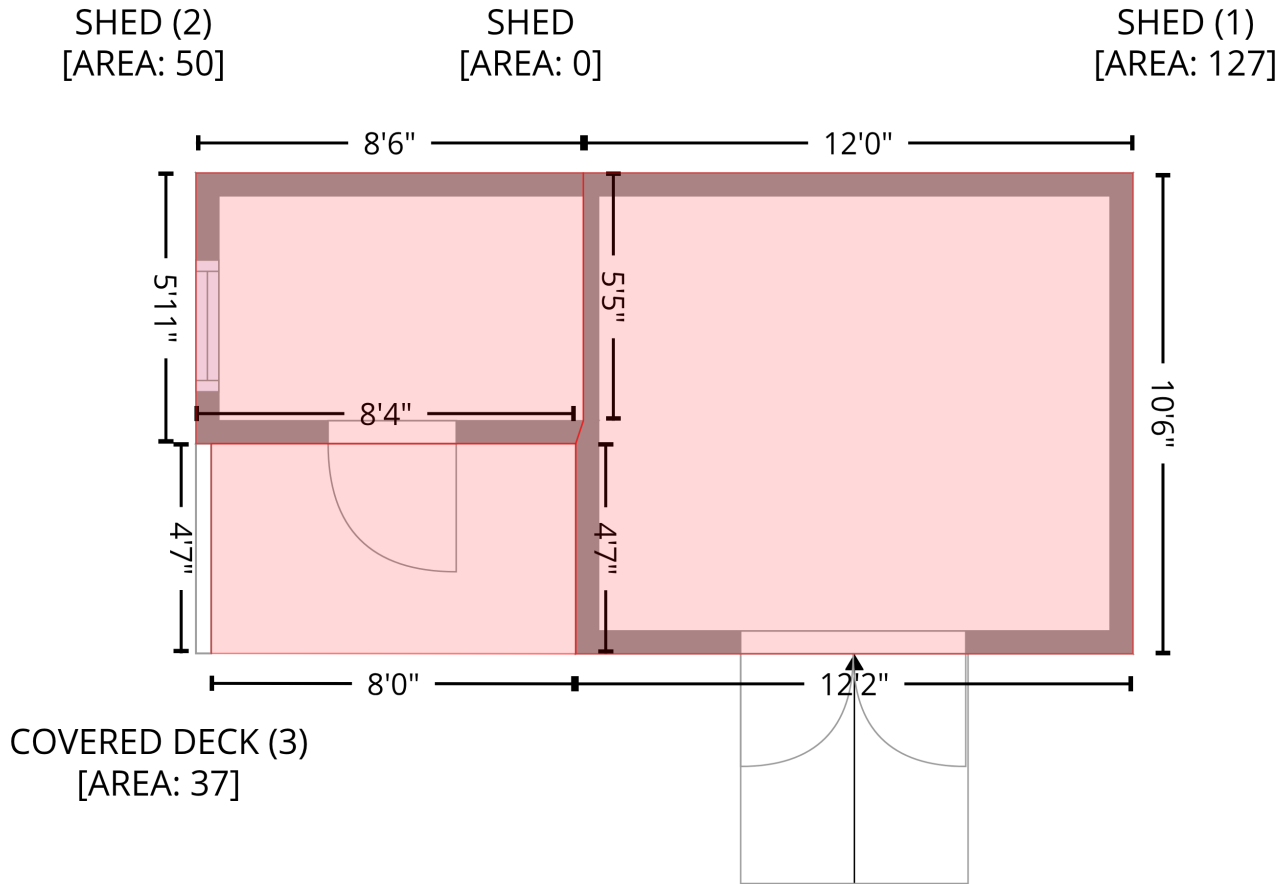

Space	Area (sq. ft)	Calculation <small>Coordinate Polygon Area Algorithm using inches</small>
SHED (Non-living area)	127	$-((443.7 + 443.7) * (-2.1 - 124) + (443.7 + 297.5) * (124 - 124) + (297.5 + 297.5) * (124 - 68.9) + (297.5 + 299.5) * (68.9 - 62.9) + (299.5 + 299.5) * (62.9 - -2.1) + (299.5 + 443.7) * (-2.1 - -2.1)) * 0.5 * 0.00694$
SHED (Non-living area)	50	$-((299.5 + 299.5) * (-2.1 - 62.9) + (299.5 + 297.5) * (62.9 - 68.9) + (297.5 + 197.9) * (68.9 - 68.9) + (197.9 + 197.9) * (68.9 - -2.1) + (197.9 + 299.5) * (-2.1 - -2.1)) * 0.5 * 0.00694$
COVERED DECK (Non-living area)	37	$-((297.5 + 297.5) * (68.9 - 124) + (297.5 + 201.9) * (124 - 123.9) + (201.9 + 201.9) * (123.9 - 68.9) + (201.9 + 297.5) * (68.9 - 68.9)) * 0.5 * 0.00694$

405 Ray Byrd Road, Lillington, Harnett County, North Carolina, United States, 27546

Gross Living Area: 1228 sq. ft

Level 2

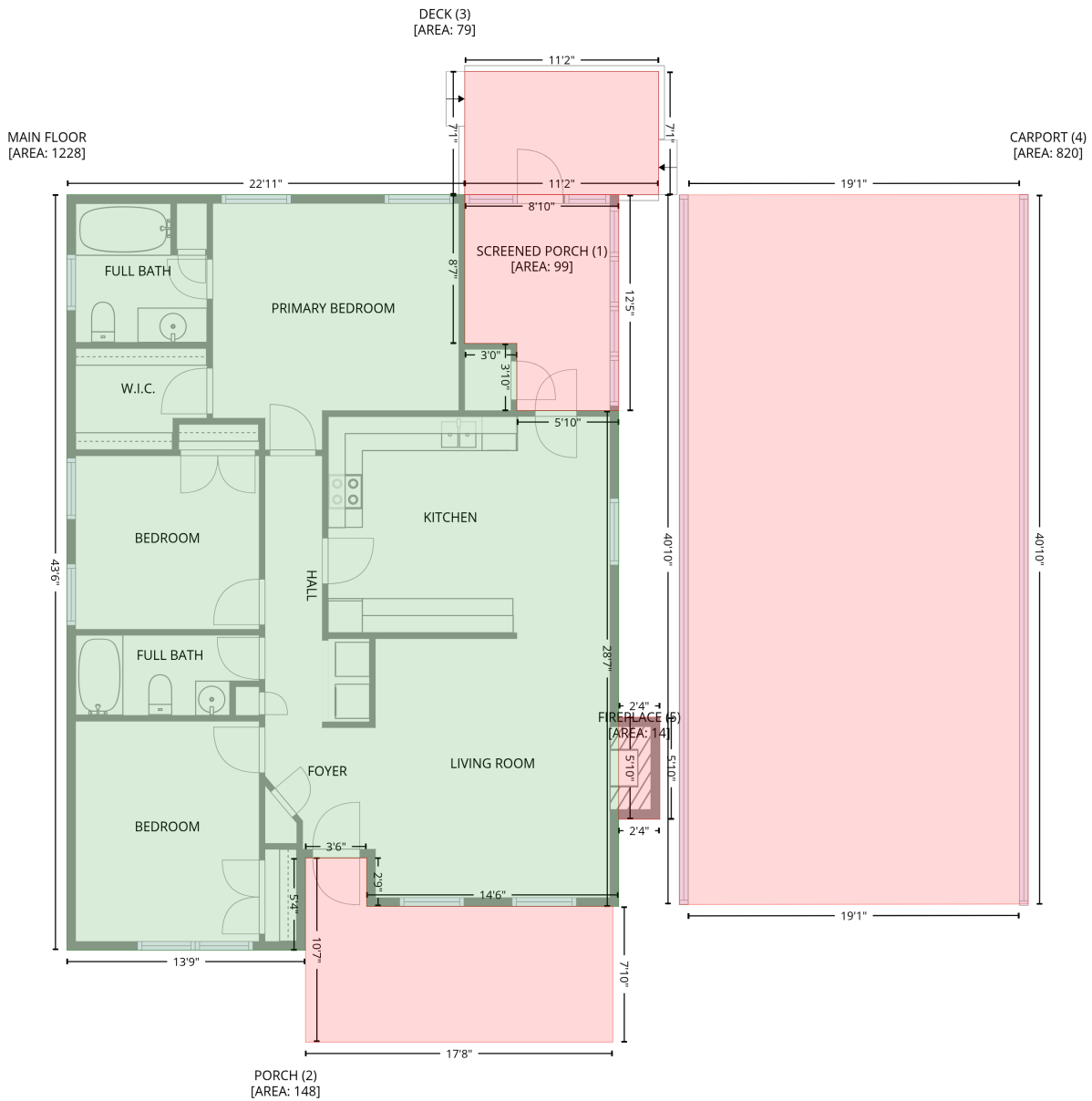

Space	Area (sq. ft)	Calculation
MAIN FLOOR (Living area)	1228	Coordinate Polygon Area Algorithm using inches $-((316.3 + 316.3) * (1090.5 - 1193.3) + (316.3 + 352.4) * (1193.3 - 1193.3) + (352.4 + 352.4) * (1193.3 - 1239.7) + (352.4 + 422.7) * (1239.7 - 1239.7) + (422.7 + 422.7) * (1239.7 - 1582.3) + (422.7 + 248.7) * (1582.3 - 1582.3) + (248.7 + 248.7) * (1582.3 - 1548.8) + (248.7 + 206.4) * (1548.8 - 1548.8) + (206.4 + 206.4) * (1548.8 - 1612.6) + (206.4 + 41.6) * (1612.6 - 1612.6) + (41.6 + 41.6) * (1612.6 - 1090.5) + (41.6 + 316.3) * (1090.5 - 1090.5)) * 0.5 * 0.00694$

405 Ray Byrd Road, Lillington, Harnett County, North Carolina, United States, 27546

Gross Living Area: 1228 sq. ft

Level 2

Space	Area (sq. ft)	Calculation <small>Coordinate Polygon Area Algorithm using inches</small>
SCREENED PORCH (Non-living area)	99	$-\left((422.7 + 422.7) * (1090.5 - 1239.7) + (422.7 + 352.4) * (1239.7 - 1239.7) + (352.4 + 352.4) * (1239.7 - 1193.3) + (352.4 + 316.3) * (1193.3 - 1193.3) + (316.3 + 316.3) * (1193.3 - 1090.5) + (316.3 + 422.7) * (1090.5 - 1090.5)\right) * 0.5 * 0.00694$
PORCH (Non-living area)	148	$-\left((248.7 + 248.7) * (1548.8 - 1582.3) + (248.7 + 418.7) * (1582.3 - 1582.3) + (418.7 + 418.7) * (1582.3 - 1676.1) + (418.7 + 206.4) * (1676.1 - 1676.1) + (206.4 + 206.4) * (1676.1 - 1548.8) + (206.4 + 248.7) * (1548.8 - 1548.8)\right) * 0.5 * 0.00694$
DECK (Non-living area)	79	$-\left((450.3 + 450.3) * (1005.3 - 1090.5) + (450.3 + 316.3) * (1090.5 - 1090.5) + (316.3 + 316.3) * (1090.5 - 1005.3) + (316.3 + 450.3) * (1005.3 - 1005.3)\right) * 0.5 * 0.00694$
CARPORT (Non-living area)	820	$-\left((705.5 + 705.5) * (1090.5 - 1580.7) + (705.5 + 699.5) * (1580.7 - 1580.7) + (699.5 + 470.7) * (1580.7 - 1581) + (470.7 + 464.7) * (1581 - 1581) + (464.7 + 464.7) * (1581 - 1090.6) + (464.7 + 470.7) * (1090.6 - 1090.6) + (470.7 + 699.5) * (1090.6 - 1090.5) + (699.5 + 705.5) * (1090.5 - 1090.5)\right) * 0.5 * 0.00694$
FIREPLACE (Non-living area)	14	$-\left((451.1 + 451.1) * (1451.6 - 1522.1) + (451.1 + 422.7) * (1522.1 - 1522.1) + (422.7 + 422.7) * (1522.1 - 1451.6) + (422.7 + 451.1) * (1451.6 - 1451.6)\right) * 0.5 * 0.00694$