

Home report

19065 Southwest Gassner Road, Cooper Mountain - Aloha
South, Beaverton, Washington County, Oregon, United States,



Total Area: 2941 sq. ft

Below Ground: 1358 sq. ft, Floor 2: 1583 sq. ft

Excluded: Utility 66 sq. ft, Fireplace 28 sq. ft, Garage 853 sq. ft, Deck 176 sq. ft, Walls: 247 sq. ft

Property summary

 2 Floors

 3 Bedrooms

 2 Bathrooms

Home report

**19065 Southwest Gassner Road, Cooper Mountain - Aloha
South, Beaverton, Washington County, Oregon, United States,**

 **1**
Half baths

 **2**
Garages

19065 Southwest Gassner Road, Cooper Mountain - Aloha
South, Beaverton, Washington County, Oregon, United States,

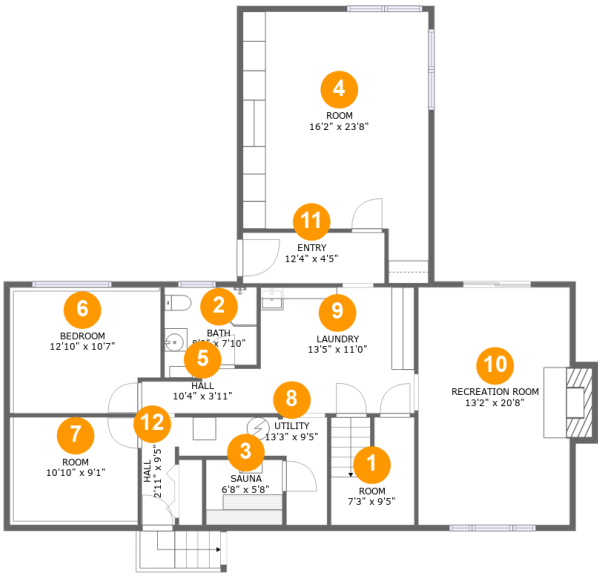

Room dimensions

Floor 1 Below ground Total:1358sqft Excluded: 80sqft

#		Max Dimensions	sqft	Included
1	Room	7'3" x 9'5"	66 sq. ft	Yes
2	Bath	8'0" x 7'10"	58 sq. ft	Yes
3	Sauna	6'8" x 5'8"	38 sq. ft	Yes
4	Room	16'2" x 23'8"	322 sq. ft	Yes
5	Hall	10'4" x 3'11"	34 sq. ft	Yes
6	Bedroom	12'10" x 10'7"	138 sq. ft	Yes
7	Room	10'10" x 9'1"	105 sq. ft	Yes
8	Utility	13'3" x 9'5"	66 sq. ft	No
9	Laundry	13'5" x 11'0"	147 sq. ft	Yes
10	Recreation Room	13'2" x 20'8"	285 sq. ft	Yes
11	Entry	12'4" x 4'5"	55 sq. ft	Yes

Home report

19065 Southwest Gassner Road, Cooper Mountain - Aloha
South, Beaverton, Washington County, Oregon, United States,

#		Max Dimensions	sqft	Included
12	Hall	2'11" x 9'5"	27 sq. ft	Yes

Home report

19065 Southwest Gassner Road, Cooper Mountain - Aloha
South, Beaverton, Washington County, Oregon, United States,

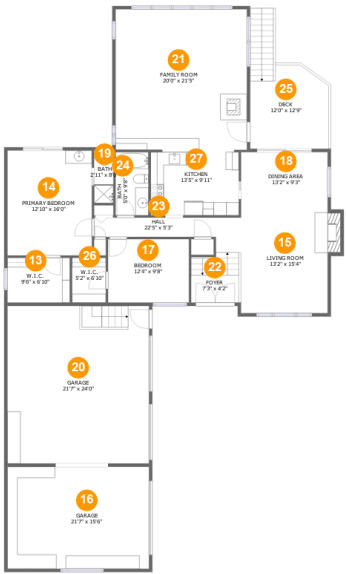

Room dimensions

Floor 2 Total:1583sqft Excluded: 1043sqft

#		Max Dimensions	sqft	Included
13	W.I.C.	9'6" x 6'10"	65 sq. ft	Yes
14	Primary Bedroom	12'10" x 16'0"	206 sq. ft	Yes
15	Living Room	13'2" x 15'4"	214 sq. ft	Yes
16	Garage	21'7" x 15'6"	335 sq. ft	No
17	Bedroom	12'4" x 9'8"	119 sq. ft	Yes
18	Dining Area	13'2" x 9'3"	122 sq. ft	Yes
19	Bath	2'11" x 8'0"	24 sq. ft	Yes
20	Garage	21'7" x 24'0"	518 sq. ft	No
21	Family Room	20'0" x 21'5"	429 sq. ft	Yes
22	Foyer	7'3" x 4'2"	56 sq. ft	Yes
23	Hall	22'5" x 5'3"	75 sq. ft	Yes

Home report

**19065 Southwest Gassner Road, Cooper Mountain - Aloha
South, Beaverton, Washington County, Oregon, United States,**

#		Max Dimensions	sqft	Included
24	Bath	5'0" x 9'8"	48 sq. ft	Yes
25	Deck	12'0" x 12'9"	176 sq. ft	No
26	W.I.C.	5'2" x 6'10"	35 sq. ft	Yes
27	Kitchen	13'5" x 9'11"	133 sq. ft	Yes

19065 Southwest Gassner Road, Cooper Mountain - Aloha
South, Beaverton, Washington County, Oregon, United States,

1 Floor 1 - Room



Max Dimensions: 7'3" x 9'5"
Calculated Area: 66 sq. ft
Included: Yes

Heated: Yes
Finished: Yes
Enclosed: Yes
Contiguous: Yes
Permitted: Yes
Wet space: No
Addition: No
Conversion: No

2 Floor 1 - Bath



Max Dimensions: 8'0" x 7'10"
Calculated Area: 58 sq. ft
Included: Yes

Heated: Yes
Finished: Yes
Enclosed: Yes
Contiguous: Yes
Permitted: Yes
Wet space: Yes
Addition: No
Conversion: No

19065 Southwest Gassner Road, Cooper Mountain - Aloha
South, Beaverton, Washington County, Oregon, United States,

3 Floor 1 - Sauna



Max Dimensions: 6'8" x 5'8"
Calculated Area: 38 sq. ft
Included: No

Heated: Yes
Finished: Yes
Enclosed: Yes
Contiguous: No
Permitted: Yes
Wet space: No
Addition: No
Conversion: No

4 Floor 1 - Room



Max Dimensions: 16'2" x 23'8"
Calculated Area: 322 sq. ft
Included: Yes

Heated: Yes
Finished: Yes
Enclosed: Yes
Contiguous: Yes
Permitted: Yes
Wet space: No
Addition: No
Conversion: No

5 Floor 1 - Hall



Max Dimensions: 10'4" x 3'11"
Calculated Area: 34 sq. ft
Included: Yes

Heated: Yes
Finished: Yes
Enclosed: Yes
Contiguous: Yes
Permitted: Yes
Wet space: No
Addition: No
Conversion: No

19065 Southwest Gassner Road, Cooper Mountain - Aloha
South, Beaverton, Washington County, Oregon, United States,

6 Floor 1 - Bedroom



Max Dimensions: 12'10" x 10'7"
Calculated Area: 138 sq. ft
Included: Yes

Heated: Yes
Finished: Yes
Enclosed: Yes
Contiguous: Yes
Permitted: Yes
Wet space: No
Addition: No
Conversion: No

7 Floor 1 - Room



Max Dimensions: 10'10" x 9'1"
Calculated Area: 105 sq. ft
Included: Yes

Heated: Yes
Finished: Yes
Enclosed: Yes
Contiguous: Yes
Permitted: Yes
Wet space: No
Addition: No
Conversion: No

8 Floor 1 - Utility



Max Dimensions: 13'3" x 9'5"
Calculated Area: 66 sq. ft
Included: No

Heated: Yes
Finished: No
Enclosed: Yes
Contiguous: Yes
Permitted: Yes
Wet space: No
Addition: No
Conversion: No

19065 Southwest Gassner Road, Cooper Mountain - Aloha
South, Beaverton, Washington County, Oregon, United States,

9 Floor 1 - Laundry



Max Dimensions: 13'5" x 11'0"
Calculated Area: 147 sq. ft
Included: Yes

Heated: Yes
Finished: Yes
Enclosed: Yes
Contiguous: Yes
Permitted: Yes
Wet space: No
Addition: No
Conversion: No

10 Floor 1 - Recreation Room



Max Dimensions: 13'2" x 20'8"
Calculated Area: 285 sq. ft
Included: Yes

Heated: Yes
Finished: Yes
Enclosed: Yes
Contiguous: Yes
Permitted: Yes
Wet space: No
Addition: No
Conversion: No

11 Floor 1 - Entry



Max Dimensions: 12'4" x 4'5"
Calculated Area: 55 sq. ft
Included: Yes

Heated: Yes
Finished: Yes
Enclosed: Yes
Contiguous: Yes
Permitted: Yes
Wet space: No
Addition: No
Conversion: No

19065 Southwest Gassner Road, Cooper Mountain - Aloha
South, Beaverton, Washington County, Oregon, United States,

12 Floor 1 - Hall



Max Dimensions: 2'11" x 9'5"
Calculated Area: 27 sq. ft
Included: Yes

Heated: Yes
Finished: Yes
Enclosed: Yes
Contiguous: Yes
Permitted: Yes
Wet space: No
Addition: No
Conversion: No

13 Floor 2 - W.I.C.



Max Dimensions: 9'6" x 6'10"
Calculated Area: 65 sq. ft
Included: Yes

Heated: Yes
Finished: Yes
Enclosed: Yes
Contiguous: Yes
Permitted: Yes
Wet space: No
Addition: No
Conversion: No

14 Floor 2 - Primary Bedroom



Max Dimensions: 12'10" x 16'0"
Calculated Area: 206 sq. ft
Included: Yes

Heated: Yes
Finished: Yes
Enclosed: Yes
Contiguous: Yes
Permitted: Yes
Wet space: No
Addition: No
Conversion: No

19065 Southwest Gassner Road, Cooper Mountain - Aloha
South, Beaverton, Washington County, Oregon, United States,

15 Floor 2 - Living Room



Max Dimensions: 13'2" x 15'4"
Calculated Area: 214 sq. ft
Included: Yes

Heated: Yes
Finished: Yes
Enclosed: Yes
Contiguous: Yes
Permitted: Yes
Wet space: No
Addition: No
Conversion: No

16 Floor 2 - Garage



Max Dimensions: 21'7" x 15'6"
Calculated Area: 335 sq. ft
Included: No

Heated: No
Finished: No
Enclosed: Yes
Contiguous: Yes
Permitted: Yes
Wet space: No
Addition: No
Conversion: No

17 Floor 2 - Bedroom



Max Dimensions: 12'4" x 9'8"
Calculated Area: 119 sq. ft
Included: Yes

Heated: Yes
Finished: Yes
Enclosed: Yes
Contiguous: Yes
Permitted: Yes
Wet space: No
Addition: No
Conversion: No

19065 Southwest Gassner Road, Cooper Mountain - Aloha
South, Beaverton, Washington County, Oregon, United States,

18 Floor 2 - Dining Area



Max Dimensions: 13'2" x 9'3"
Calculated Area: 122 sq. ft
Included: Yes

Heated: Yes
Finished: Yes
Enclosed: Yes
Contiguous: Yes
Permitted: Yes
Wet space: No
Addition: No
Conversion: No

19 Floor 2 - Bath



Max Dimensions: 2'11" x 8'0"
Calculated Area: 24 sq. ft
Included: Yes

Heated: Yes
Finished: Yes
Enclosed: Yes
Contiguous: Yes
Permitted: Yes
Wet space: Yes
Addition: No
Conversion: No

20 Floor 2 - Garage



Max Dimensions: 21'7" x 24'0"
Calculated Area: 518 sq. ft
Included: No

Heated: No
Finished: No
Enclosed: Yes
Contiguous: Yes
Permitted: Yes
Wet space: No
Addition: No
Conversion: No

19065 Southwest Gassner Road, Cooper Mountain - Aloha
South, Beaverton, Washington County, Oregon, United States,

21 Floor 2 - Family Room



Max Dimensions: 20'0" x 21'5"
Calculated Area: 429 sq. ft
Included: Yes

Heated: Yes
Finished: Yes
Enclosed: Yes
Contiguous: Yes
Permitted: Yes
Wet space: No
Addition: No
Conversion: No

22 Floor 2 - Foyer



Max Dimensions: 7'3" x 4'2"
Calculated Area: 56 sq. ft
Included: Yes

Heated: Yes
Finished: Yes
Enclosed: Yes
Contiguous: Yes
Permitted: Yes
Wet space: No
Addition: No
Conversion: No

23 Floor 2 - Hall



Max Dimensions: 22'5" x 5'3"
Calculated Area: 75 sq. ft
Included: Yes

Heated: Yes
Finished: Yes
Enclosed: Yes
Contiguous: Yes
Permitted: Yes
Wet space: No
Addition: No
Conversion: No

19065 Southwest Gassner Road, Cooper Mountain - Aloha
South, Beaverton, Washington County, Oregon, United States,

24 Floor 2 - Bath



Max Dimensions: 5'0" x 9'8"
Calculated Area: 48 sq. ft
Included: Yes

Heated: Yes
Finished: Yes
Enclosed: Yes
Contiguous: Yes
Permitted: Yes
Wet space: Yes
Addition: No
Conversion: No

25 Floor 2 - Deck



Max Dimensions: 12'0" x 12'9"
Calculated Area: 176 sq. ft
Included: No

Heated: No
Finished: Yes
Enclosed: No
Contiguous: Yes
Permitted: Yes
Wet space: No
Addition: No
Conversion: No

26 Floor 2 - W.I.C.



Max Dimensions: 5'2" x 6'10"
Calculated Area: 35 sq. ft
Included: Yes

Heated: Yes
Finished: Yes
Enclosed: Yes
Contiguous: Yes
Permitted: Yes
Wet space: No
Addition: No
Conversion: No

19065 Southwest Gassner Road, Cooper Mountain - Aloha
South, Beaverton, Washington County, Oregon, United States,

27 Floor 2 - Kitchen



Max Dimensions: 13'5" x 9'11"
Calculated Area: 133 sq. ft
Included: Yes

Heated: Yes
Finished: Yes
Enclosed: Yes
Contiguous: Yes
Permitted: Yes
Wet space: No
Addition: No
Conversion: No