

Sketch			
Case Number:	20250912-1	File Number:	202509
Address:	1210 Manco Dairy Road		
City / State:	Pittsboro / NC	Zip / County:	27312 /
Borrower:			
Lender or Client:	Sandra Savage	Address:	
Prepared By:	Laura Fuelleman	Prepared By A...	

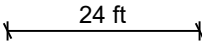

Living Area		Nonliving Area	
Main Floor	3271.77 ft²	4+ Car Garage	1306.94 ft²
		Porch	121.50 ft²
		Patio	1442.74 ft²
		Attic	785.73 ft²
Total Living Area (rounded):	3272 ft²	Total Non-Living Area (rounded):	3657 ft²

This document is designed to be a record of total finished square feet to aid the listing agent in gathering the square feet facts of the property. Measurements are obtained by physical observation of the property by a certified Home Measurement Specialist. Within every measurement project, some degree of art of opinion may be applied as well as rounding as set forth in the standards. Final finished square footage will be rounded to the nearest whole number with the goal of being within a 5% margin of error. Information deemed reliable, but not guaranteed.

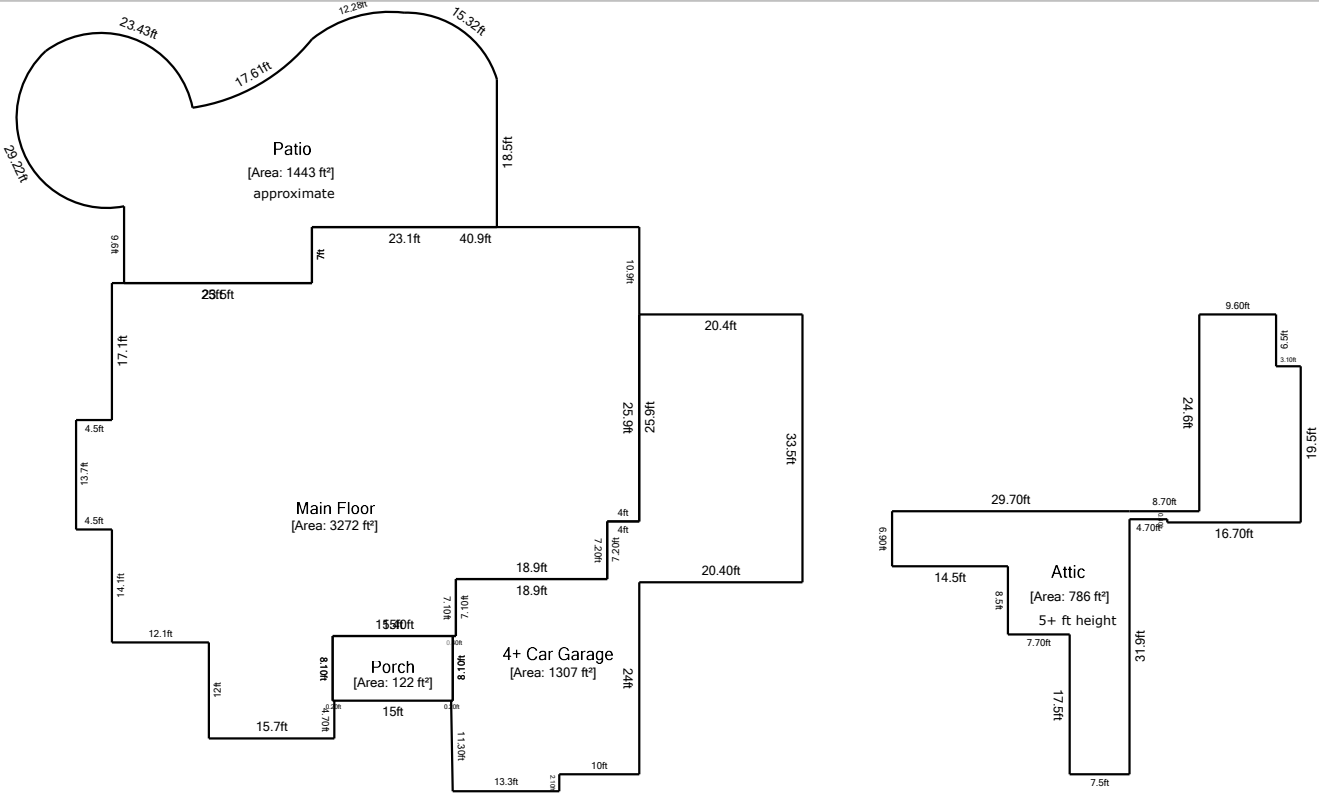