

Sketch

| | |
|-----------------------------------|-----------------------|
| Case Number: 20220524-3 | File Number: 202205 |
| Address: 401 Brandywine Circle | |
| City / State: Raleigh / NC | Zip / County: 27614 / |
| Borrower: | |
| Lender or Client: Justin Burleson | Address: |
| Prepared By: Laura Fuelleman | Prepared By A... |

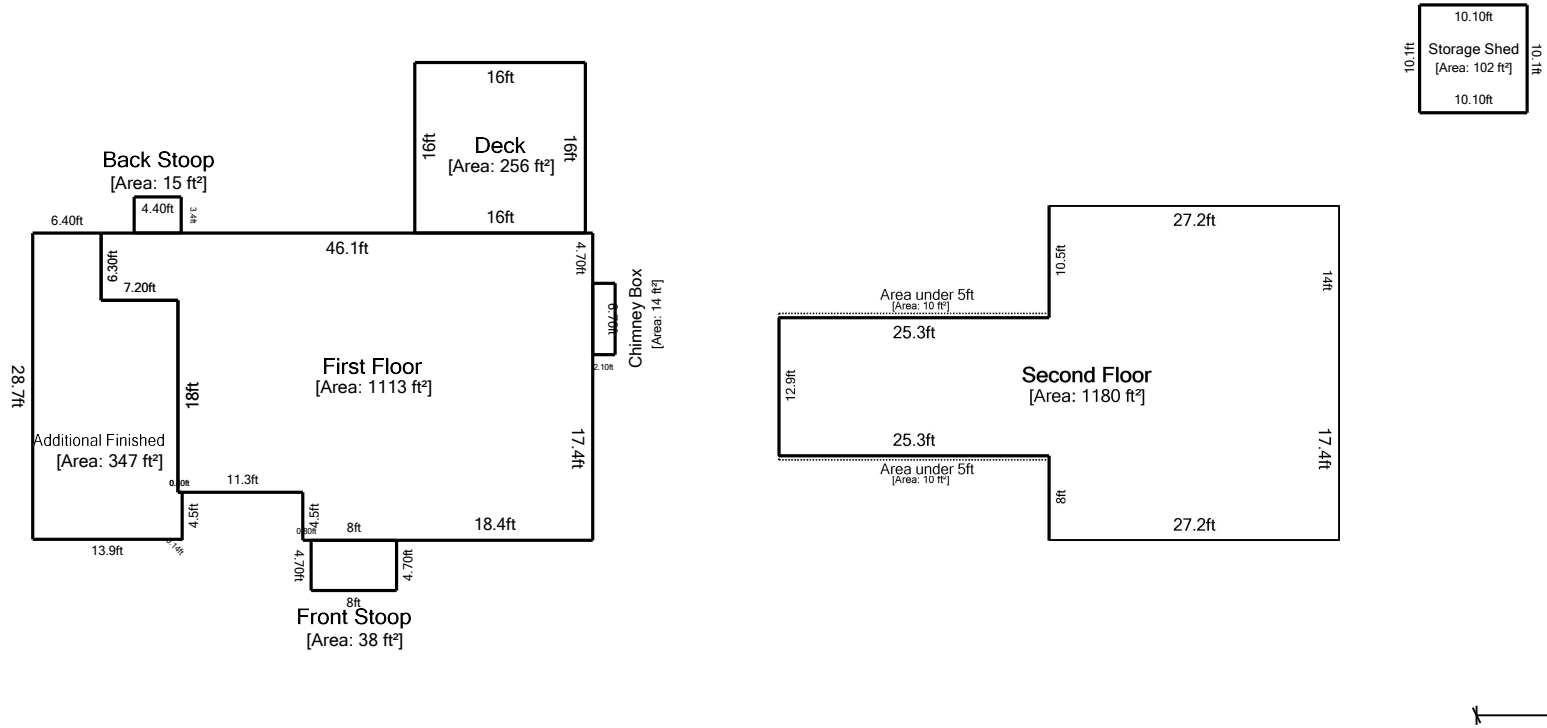

| Living Area | | Nonliving Area | |
|-------------------------------------|-----------------|---|----------------|
| Second Floor | 1180.45 ft² | Front Stoop | 37.60 ft² |
| Additional Finished | 346.72 ft² | Back Stoop | 14.96 ft² |
| First Floor | 1113.03 ft² | Chimney Box | 14.07 ft² |
| | | Deck | 256 ft² |
| | | Area under 5ft | 10.12 ft² |
| | | Area under 5ft | 10.12 ft² |
| | | Storage Shed | 102.01 ft² |
| Total Living Area (rounded): | 2640 ft² | Total Non-Living Area (rounded): | 445 ft² |

This document is designed to be a record of total finished square feet to aid the listing agent in gathering the square feet facts of the property. Measurements are obtained by physical observation of the property by a certified Home Measurement Specialist. The method of measuring the subject home is in accordance with the NC Residential Square Footage Guidelines and those approved by the American National Standards Institute, Inc (ANSI), which are recognized by the North Carolina Real Estate Commission as comparable standards. Within every measurement project, some degree of art of opinion may be applied as well as rounding as set forth in the standards. Final finished square footage will be rounded to the nearest whole number with the goal of being within a 5% margin of error.